

//
of

35°04'S

150°44'E

16

20₉

Previous Notice 1021/2016

NTM 195/2017

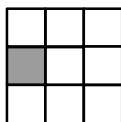

Australian Government
Department of Defence

AUS 193

© Commonwealth of Australia 2017

33°40'S

151°20'E

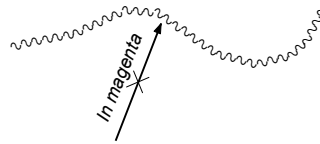

8₄

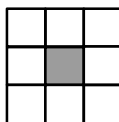
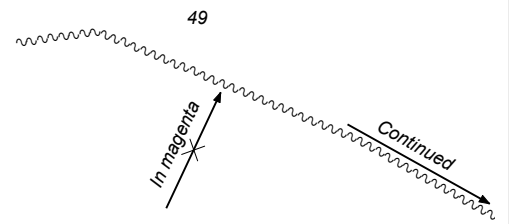

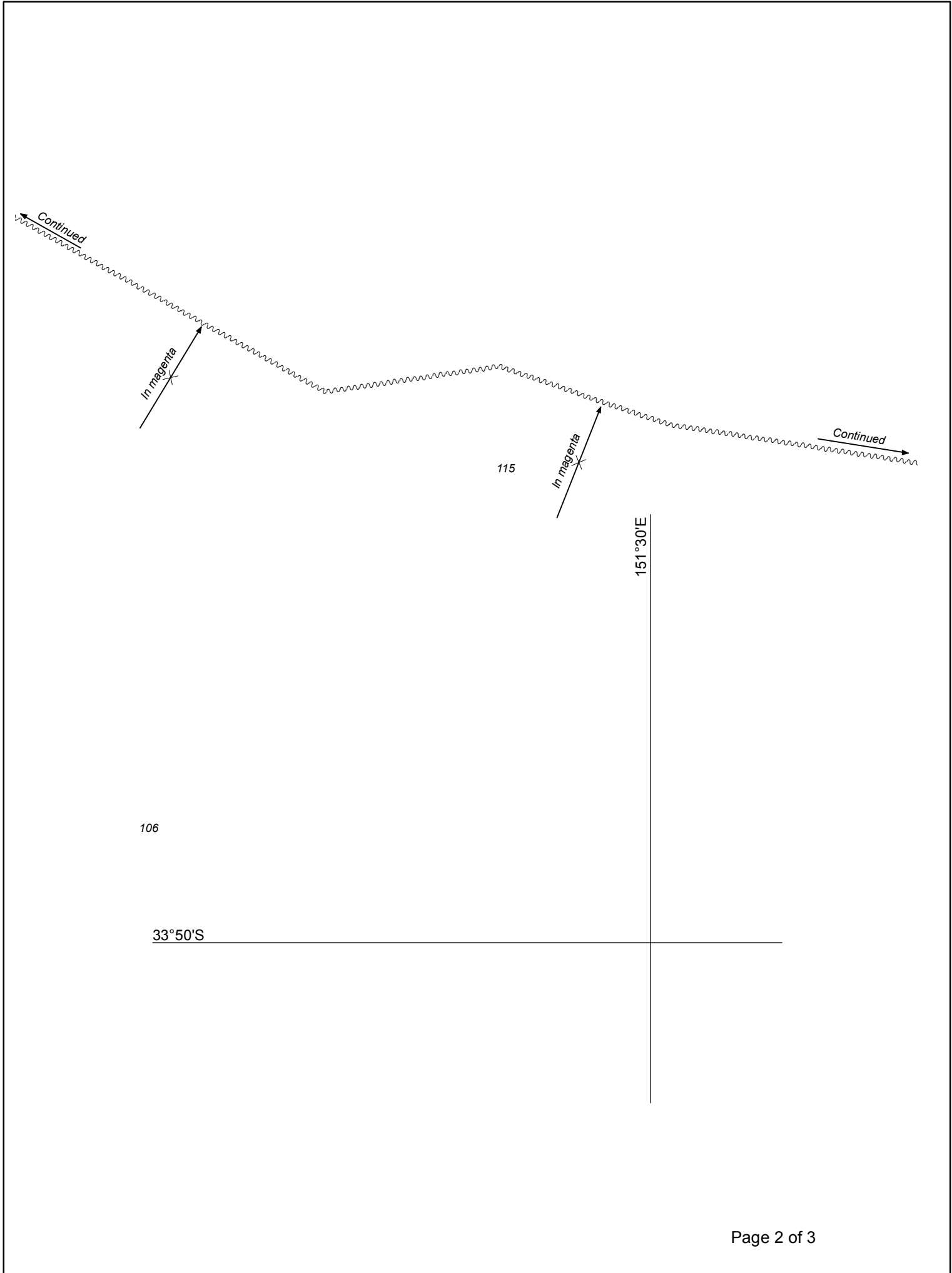

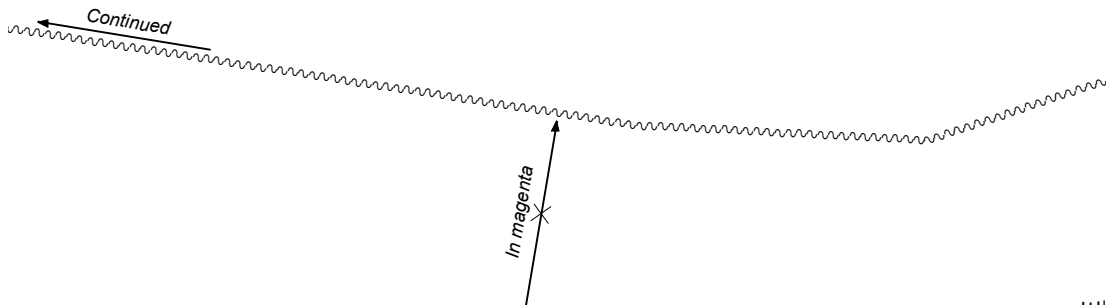

151°39.7'E

147

33°50'S

159

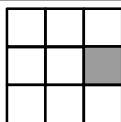

34°00'S

153°00'E

4818

4856

In magenta

In magenta

Continued

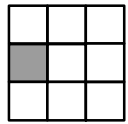

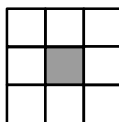
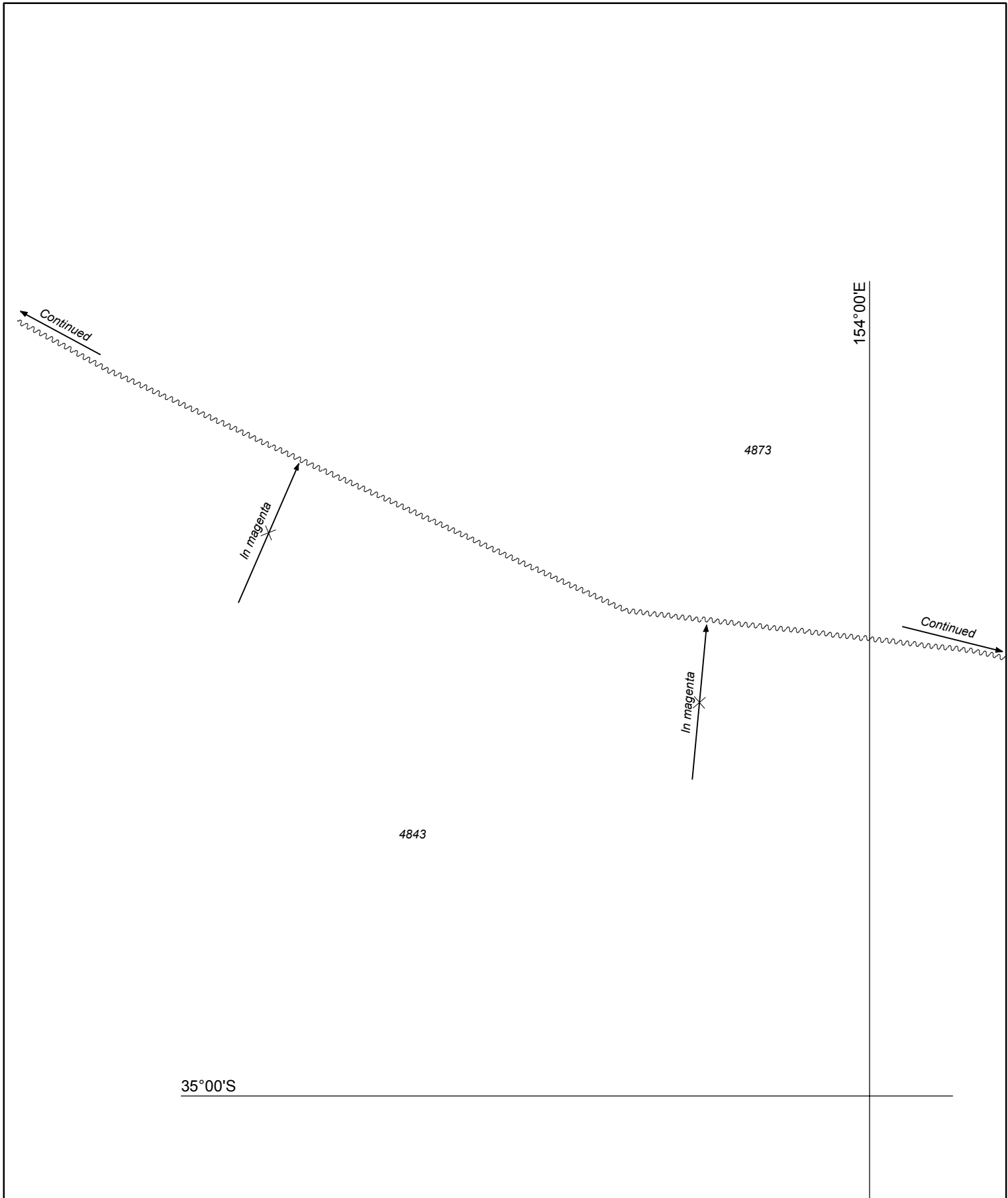

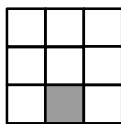
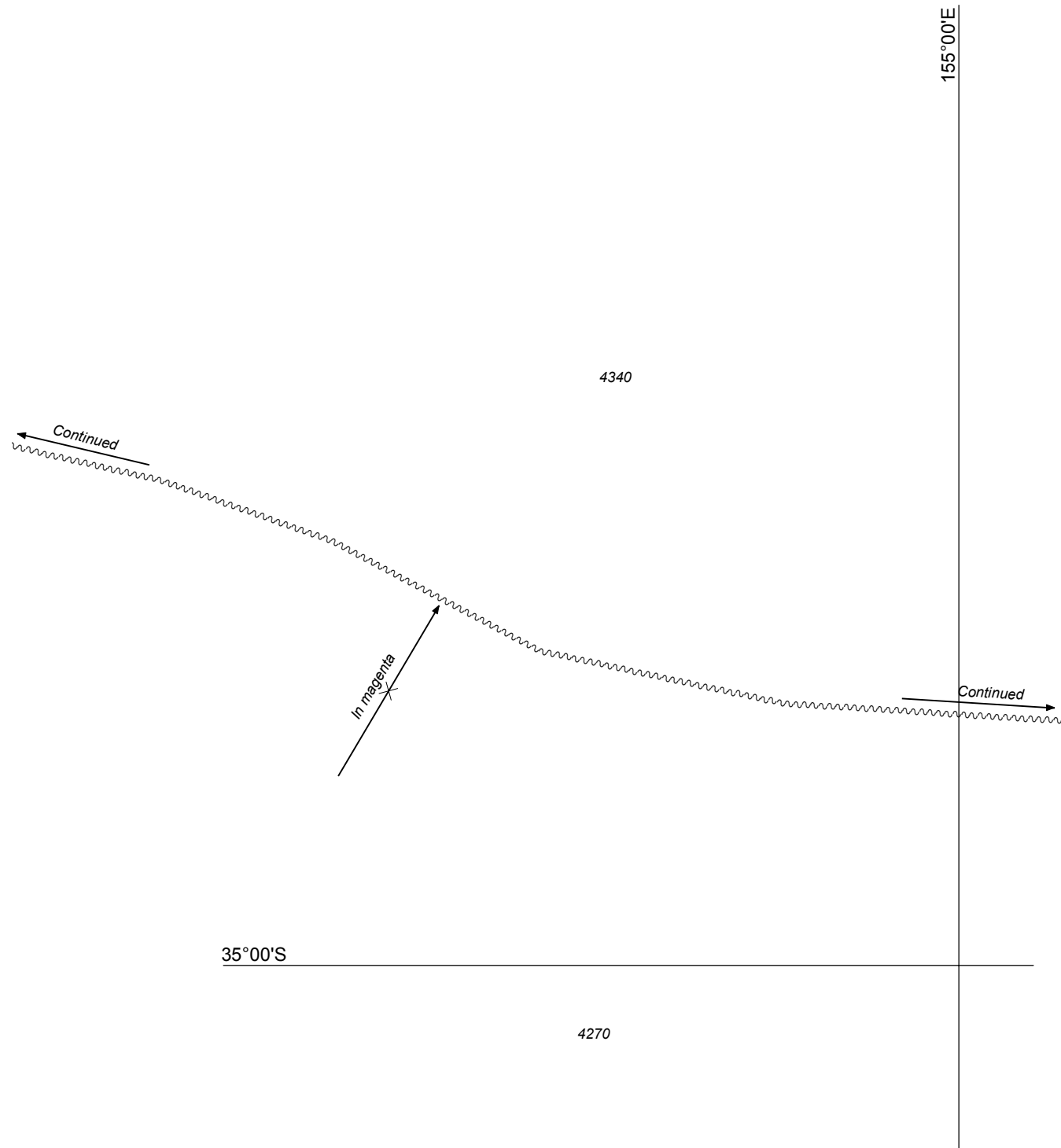

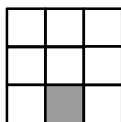
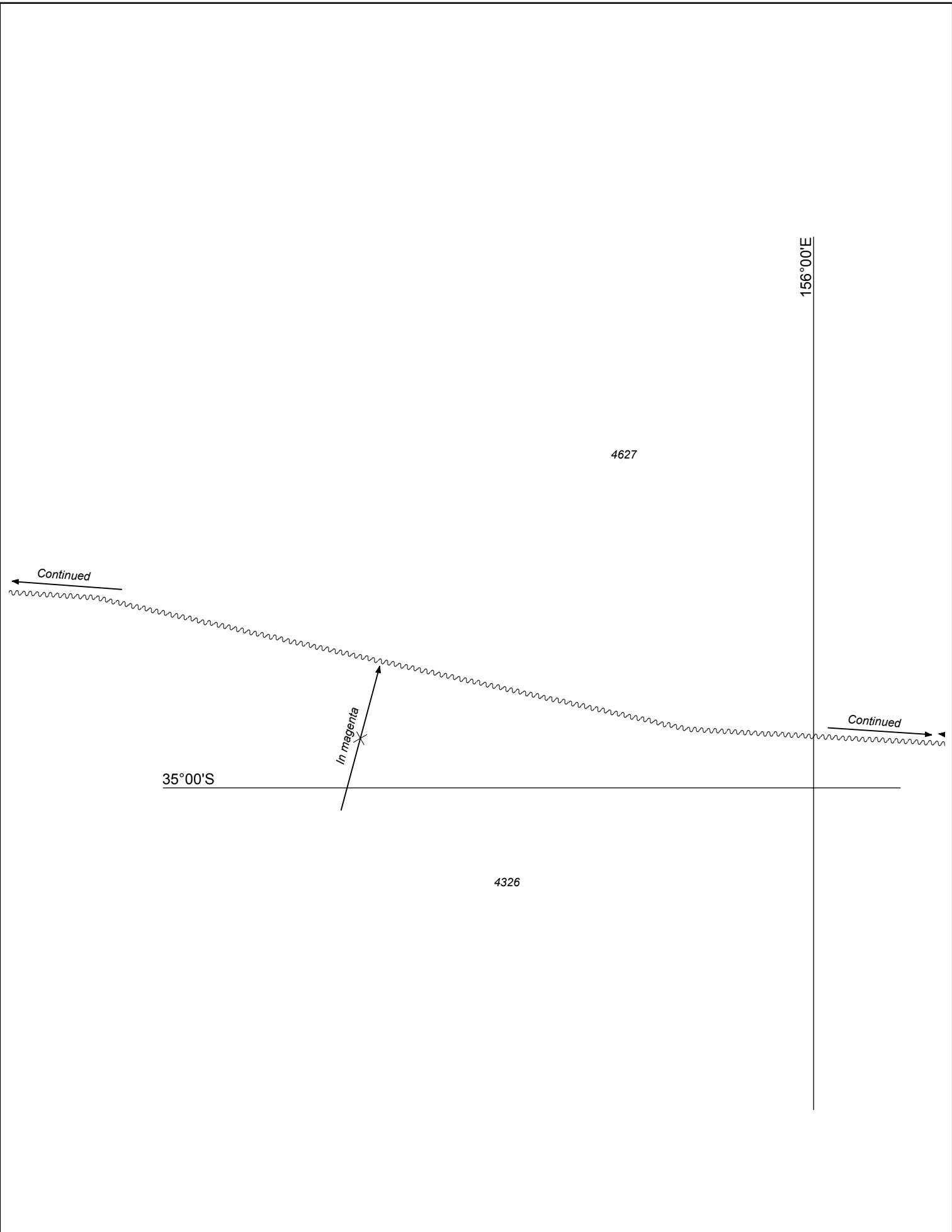

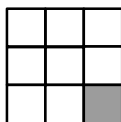
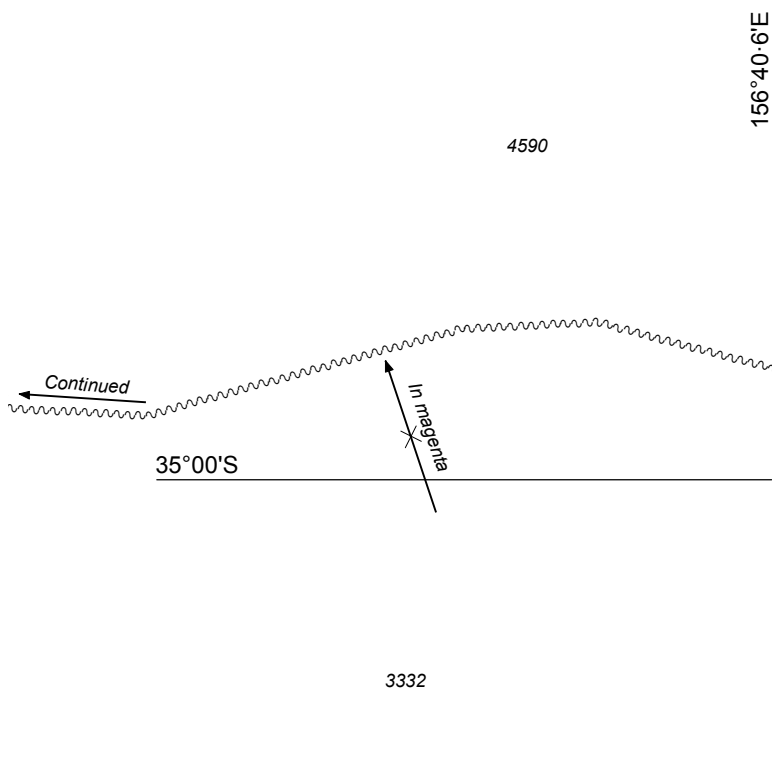

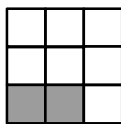
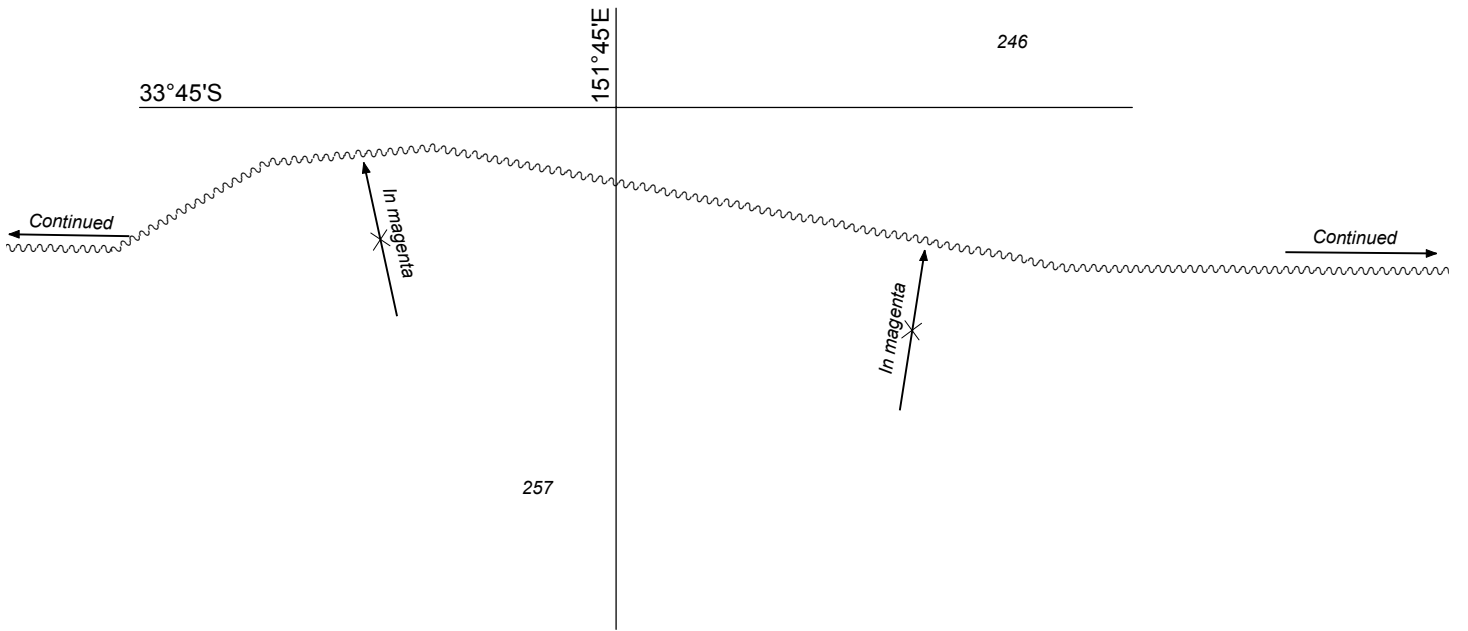
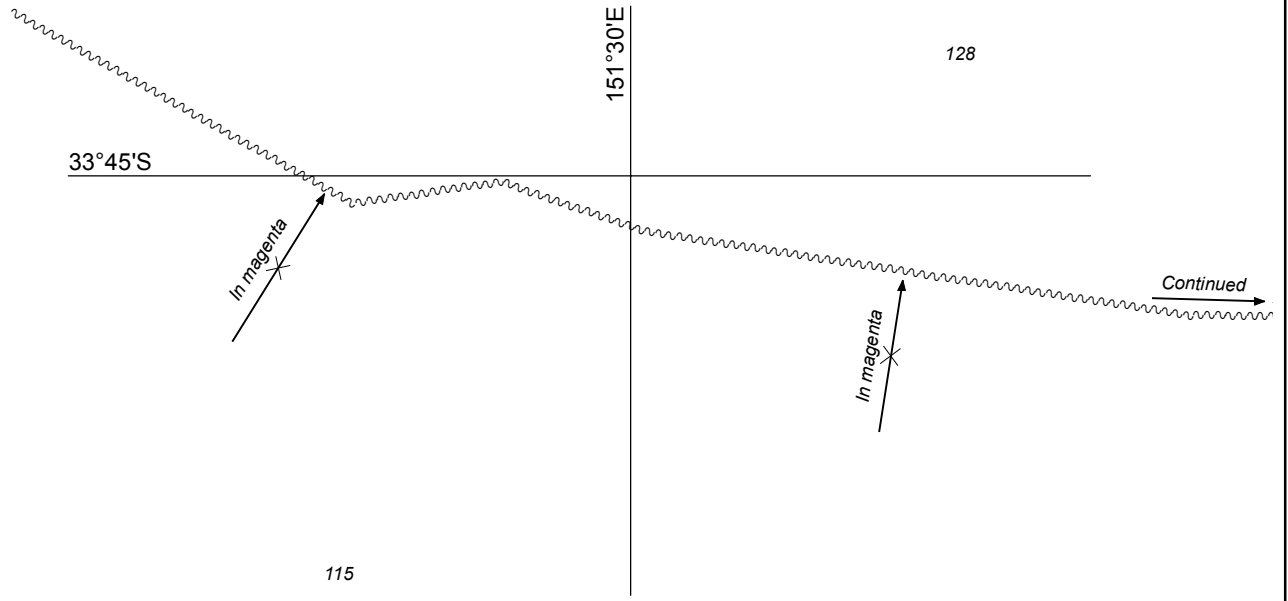

152°00'E

1257

33°45'S

1279

Continued

In magenta

In magenta

Page 2 of 2

Previous Notice 125/2017

NTM 196/2017

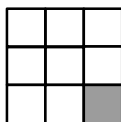

Australian Government
Department of Defence

AUS 809

© Commonwealth of Australia 2017

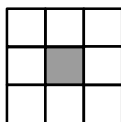
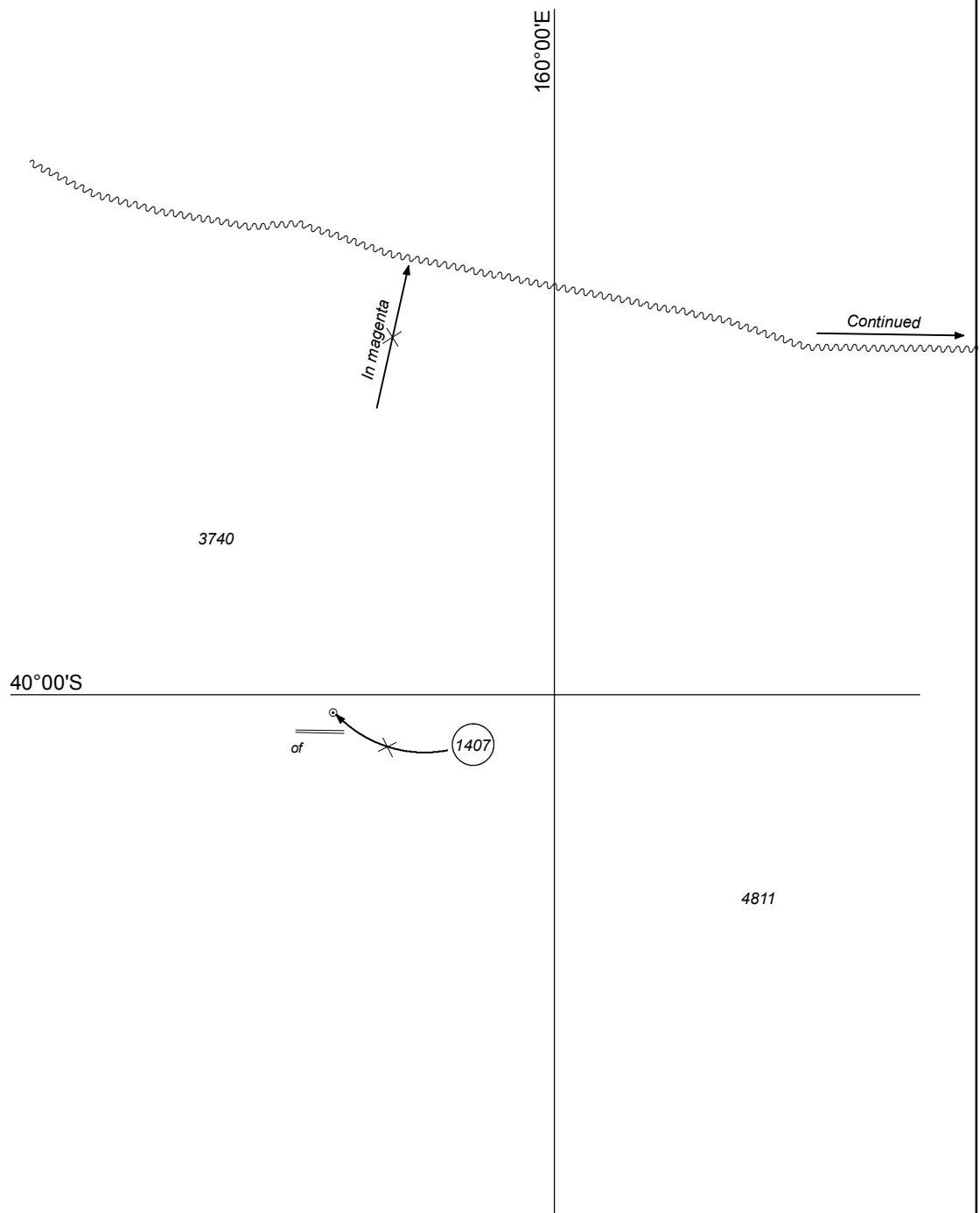

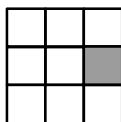
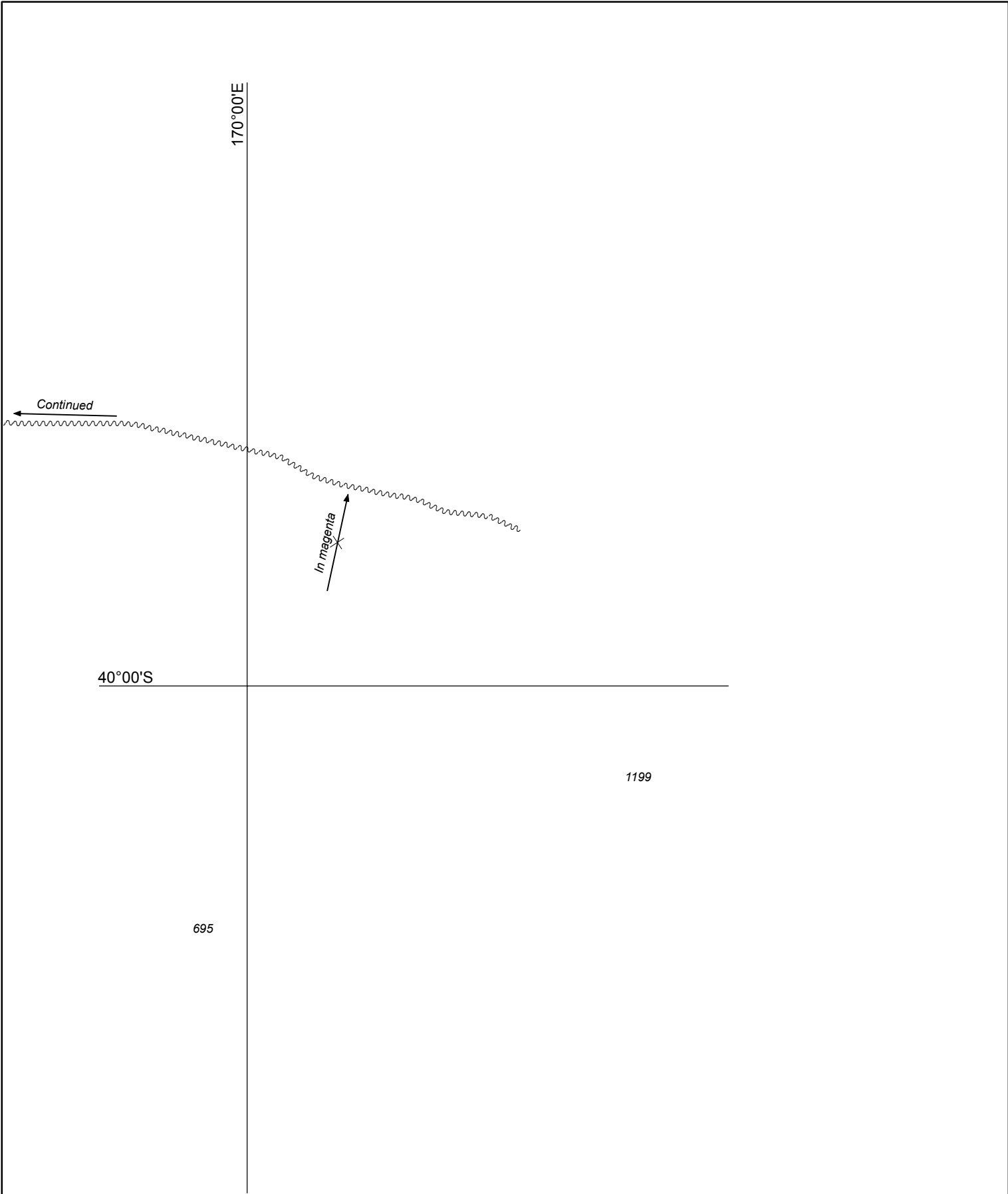

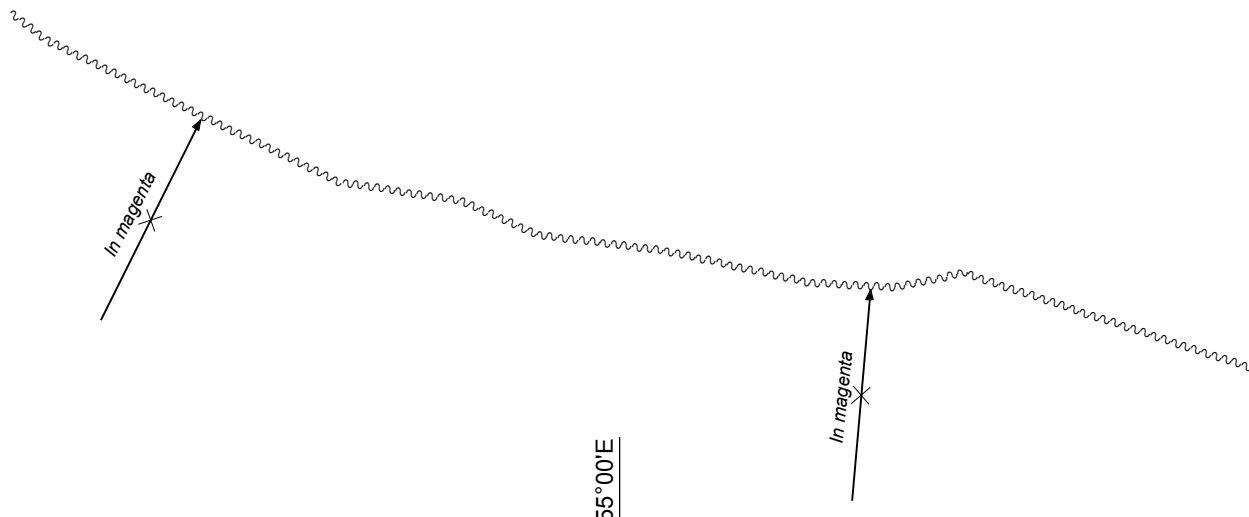

155°00'E

3681

1868

40°00'S

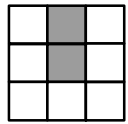
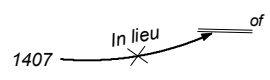

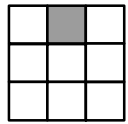
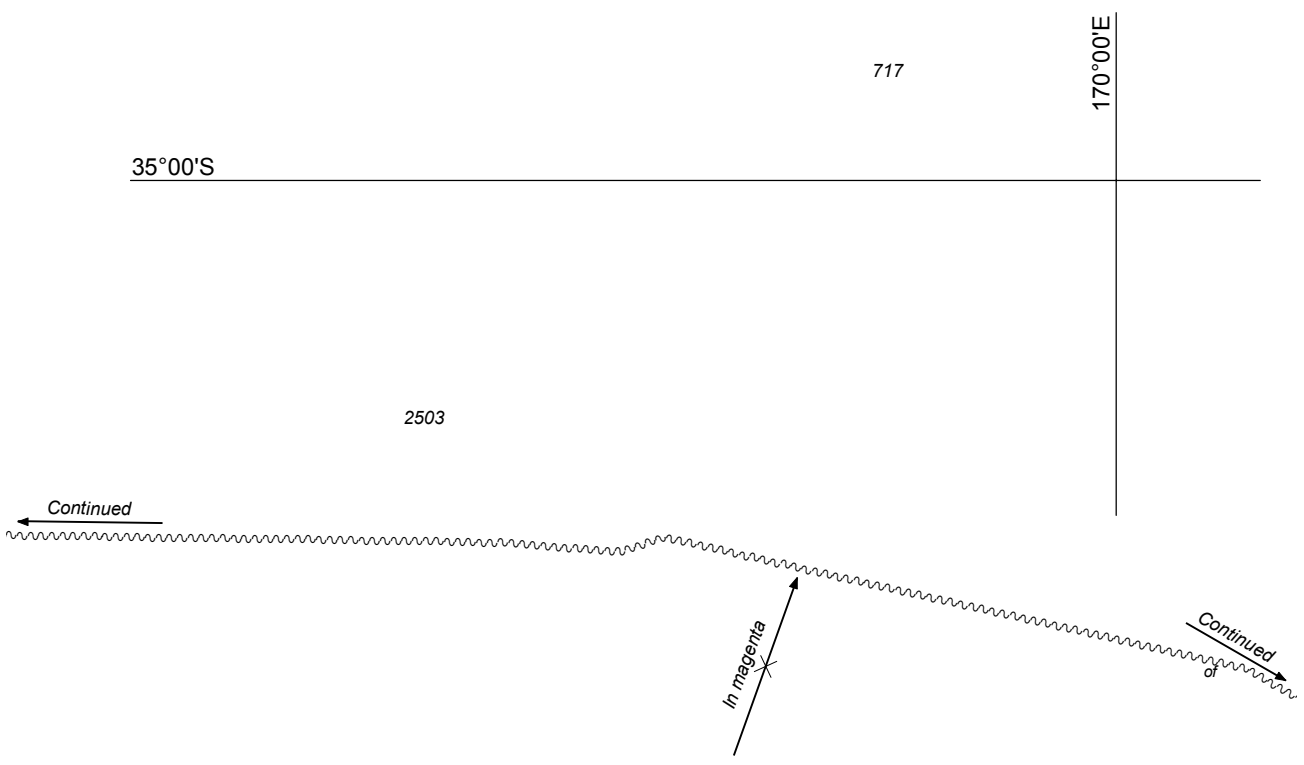
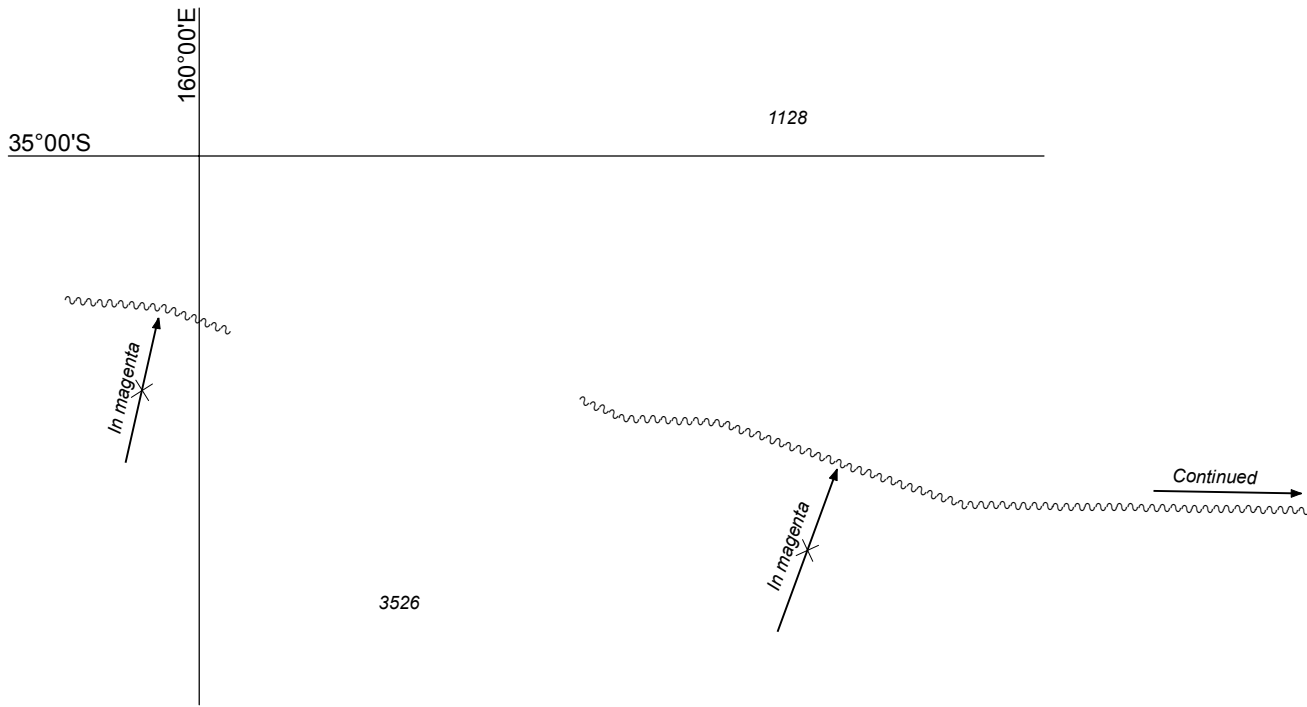

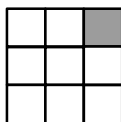
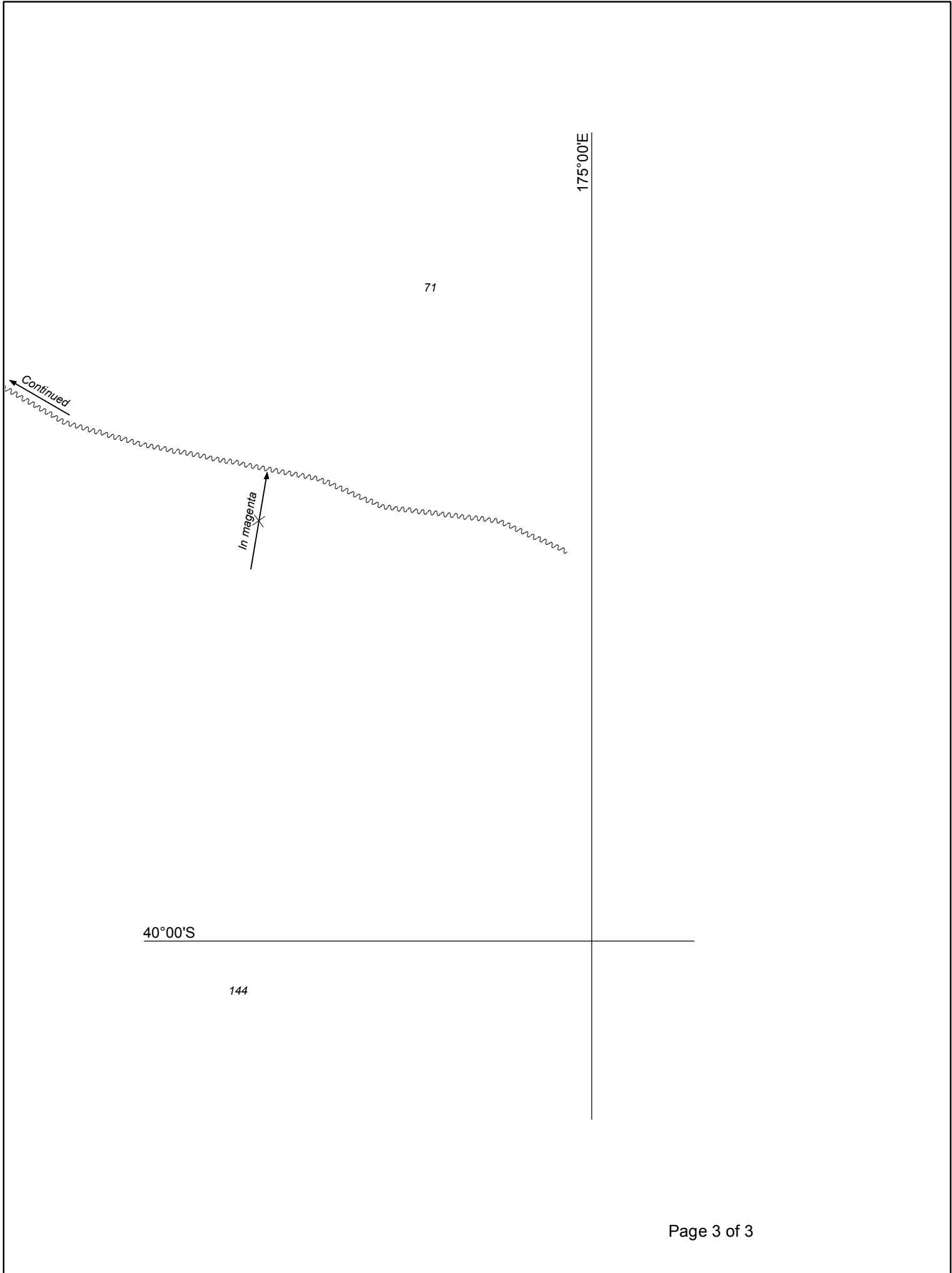

30°00'S

155°00'E

4782

3870

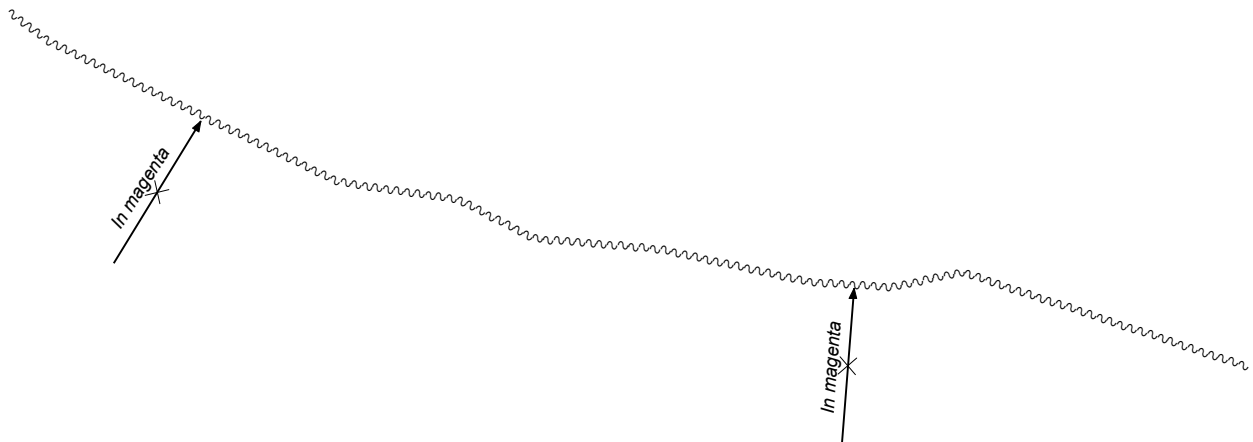

Previous Notice 44/2017

NTM 196/2017

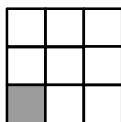

Australian Government
Department of Defence

AUS 4602 (INT 602)

© Commonwealth of Australia 2017

154°00'E

4680

34°00'S

4854

In magenta

In magenta

Continued



Continued

In magenta

Continued

156°00'E

4367

4524

36°00'S

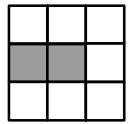

158°00'E

4026

Continued

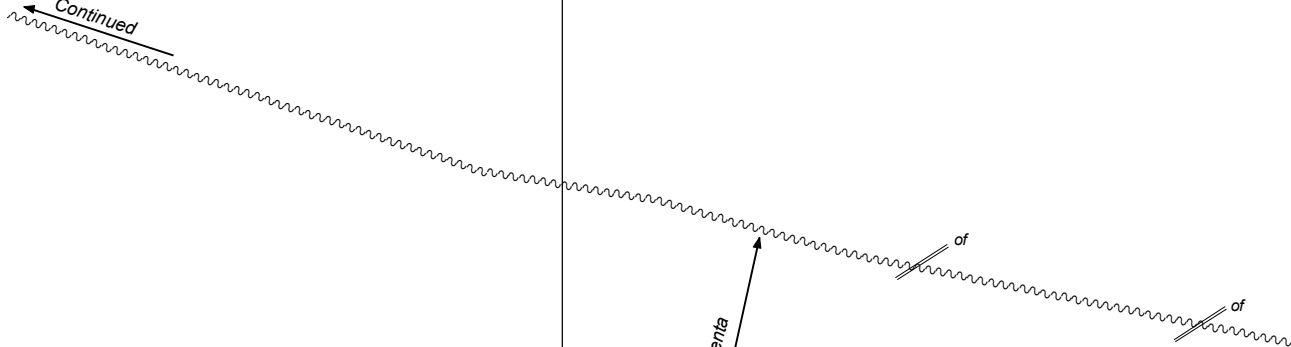

In magenta

36°00'S

4572

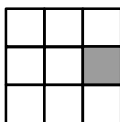

— × —→ INSERT BLOCK A ← × —

151°12'00"E

33°57'30"S

1₁

8₆



151°12'00"E

15₉

of // of
of

33°58'30"S

16₇

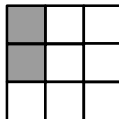

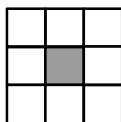
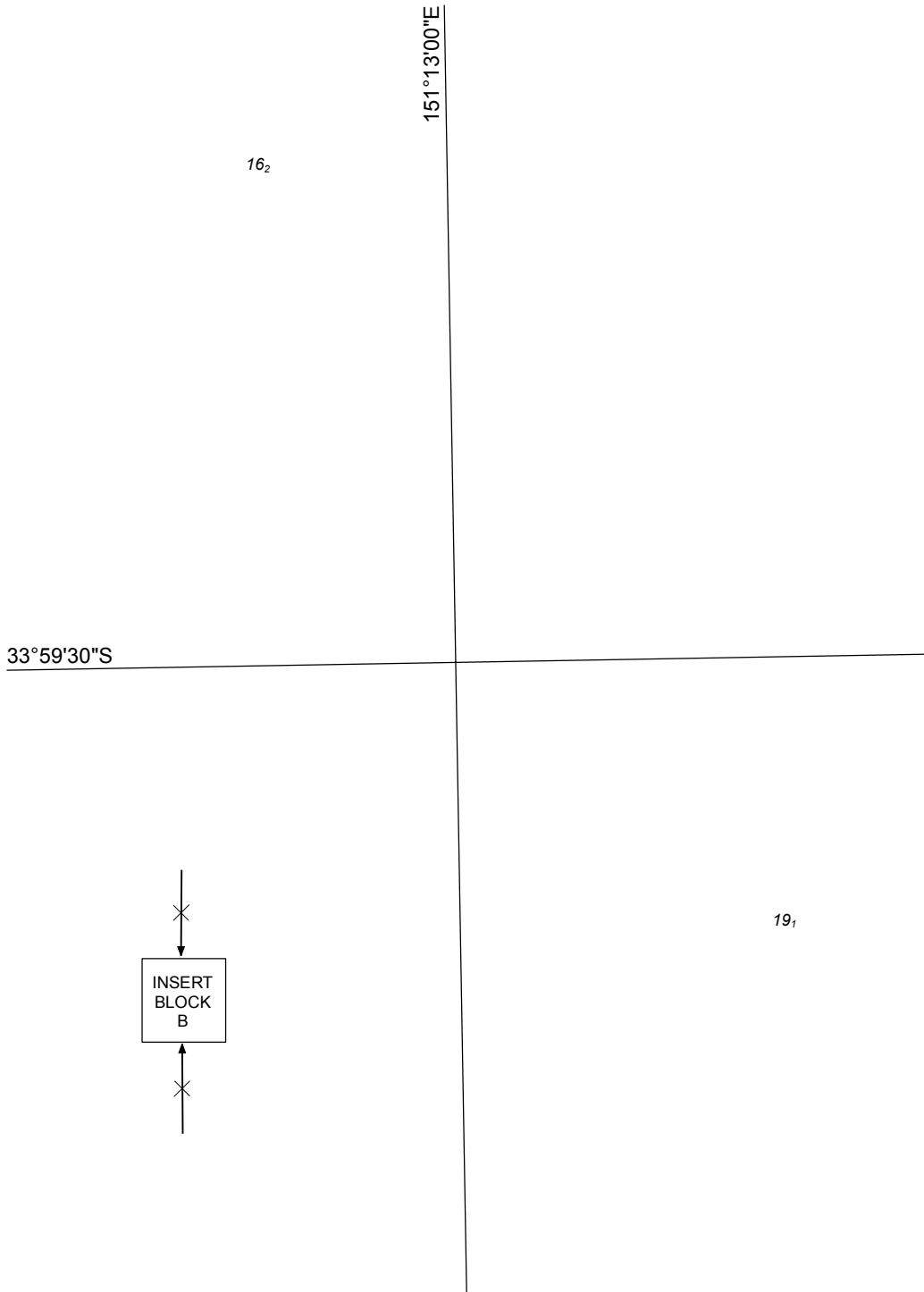

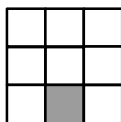
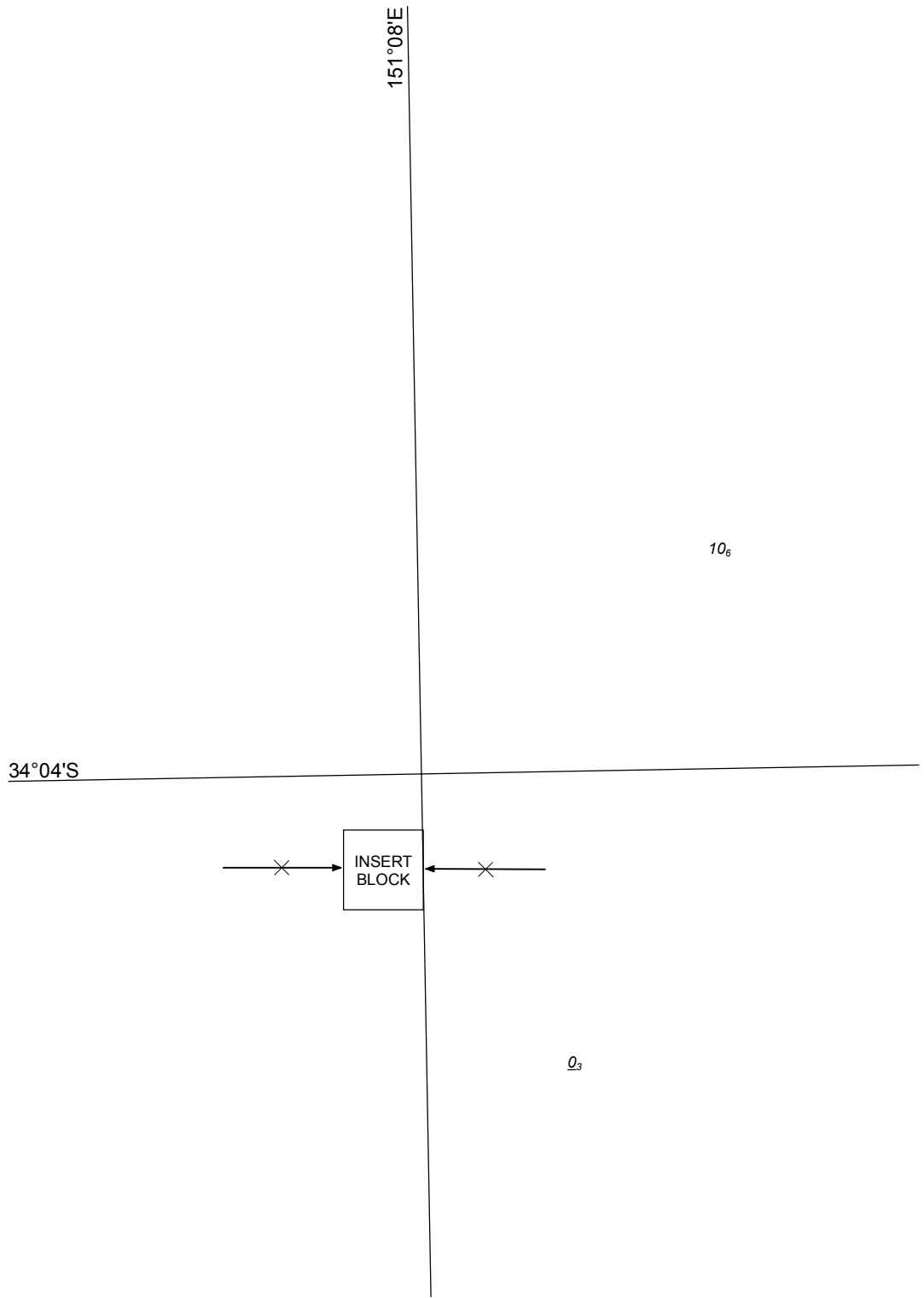

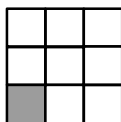
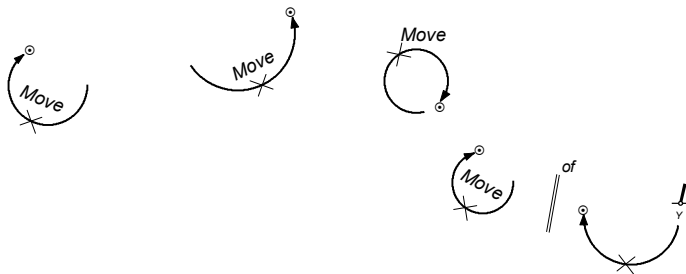
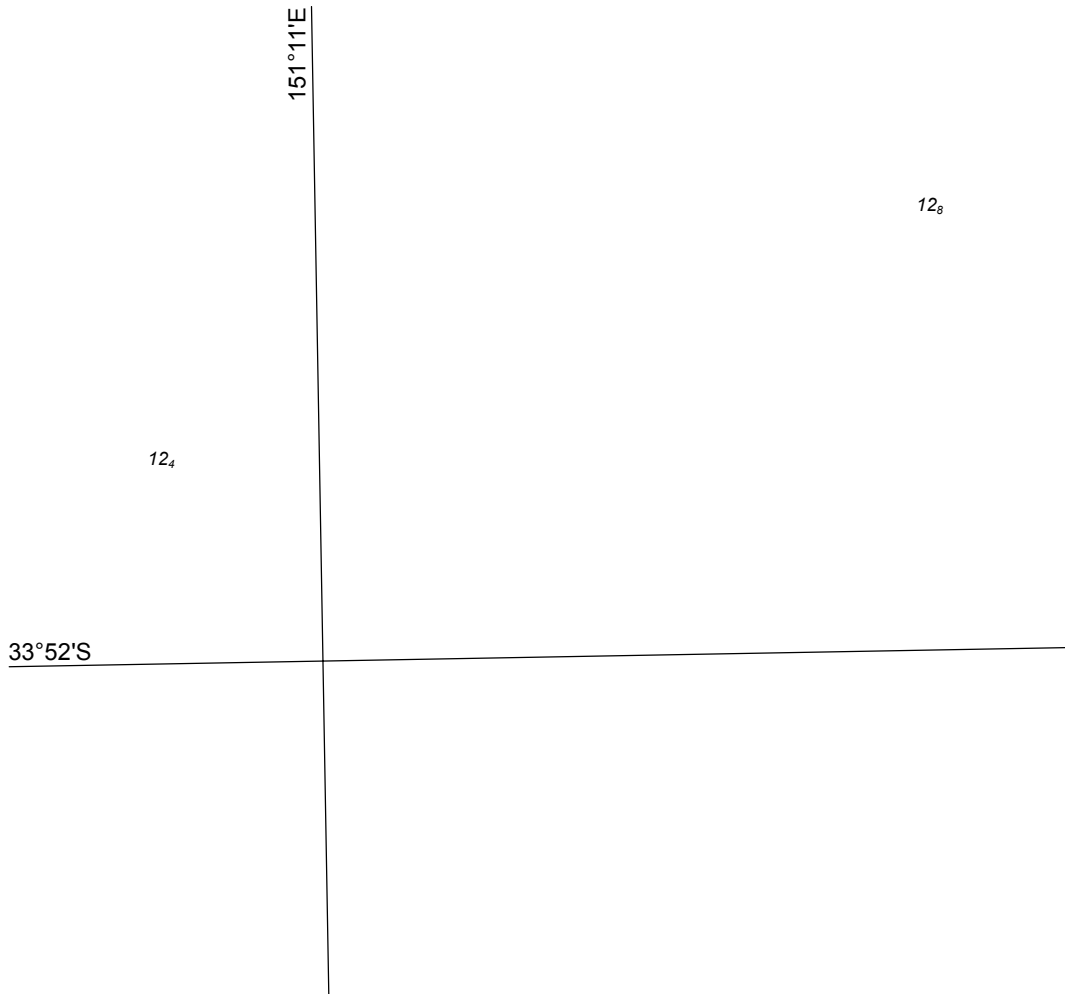

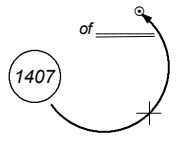

160°00'E

4506

50°00'S

4206

Previous Notice 294/2013

NTM 200/2017

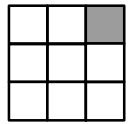

Australian Government
Department of Defence

AUS 4074 (INT 74)

© Commonwealth of Australia 2017

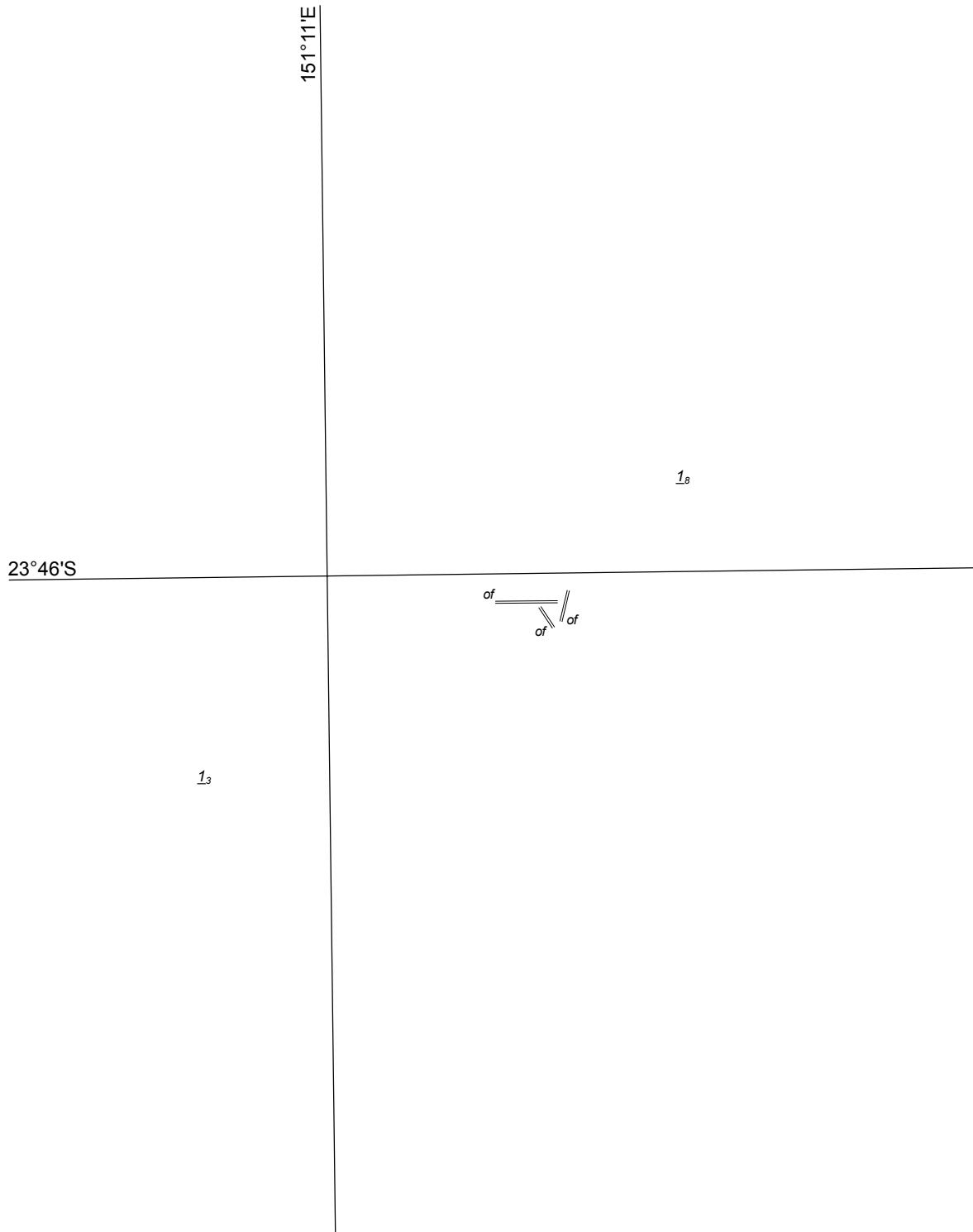

Previous Notice 634/2016

NTM 201/2017

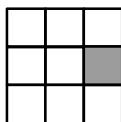

Australian Government
Department of Defence

AUS 272

© Commonwealth of Australia 2017

27°35'S

153°20'E

1₂

2₆

of=
=of
of=

Previous Notice 129/2017

NTM 202/2017

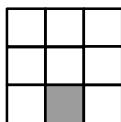

Australian Government
Department of Defence

AUS 236

© Commonwealth of Australia 2017

Q₉

146° 19' E

18° 32' S

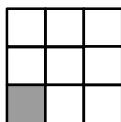
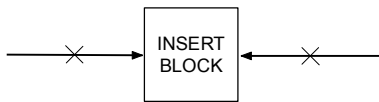

17°53'4"S

147°32'6"E

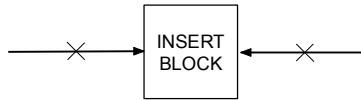

880

948

Previous Notice 48/2017

NTM 203/2017

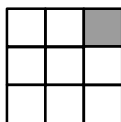

Australian Government
Department of Defence

AUS 828

© Commonwealth of Australia 2017

of

10°00'S

120°00'E

4680

5395

Previous Notice 1241/2016

NTM 204/2017

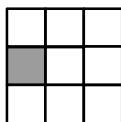

Australian Government
Department of Defence

AUS 4603 (INT603)

© Commonwealth of Australia 2017

10°00'S

115°00'E

99

of

6877

Previous Notice 349/2016

NTM 204/2017

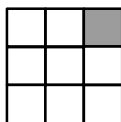

Australian Government
Department of Defence

AUS 4708 (INT 708)

© Commonwealth of Australia 2017

10°00'S

116°00'E

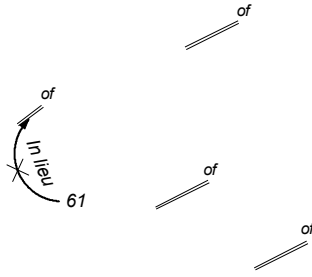

3451

2694

Previous Notice 95/2017

NTM 204/2017

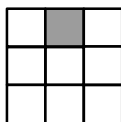

Australian Government
Department of Defence

AUS 4723 (INT 723)

© Commonwealth of Australia 2017

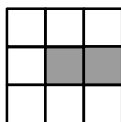
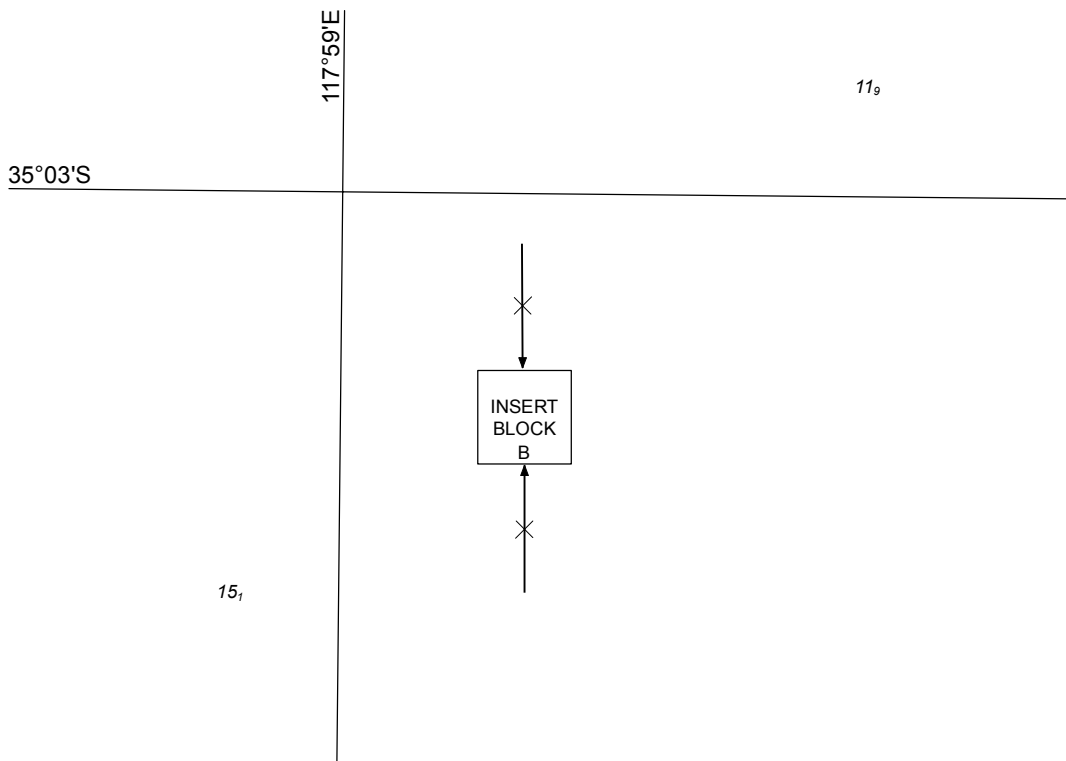
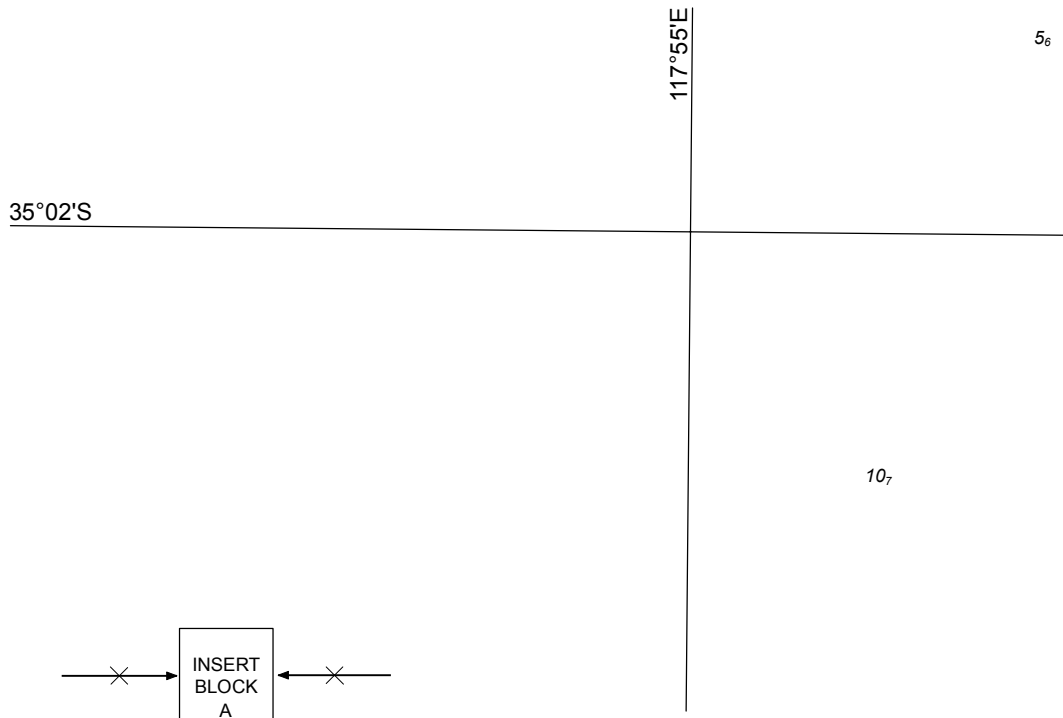

117°57'E

15,

35°03'S

12

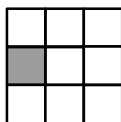
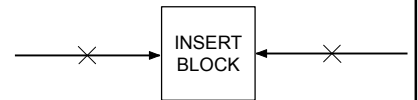

115°30'E

3₂

of of of of

20°45'S

6₅

Previous Notice 1203/2016

NTM 206/2017

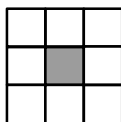

Australian Government
Department of Defence

AUS 65

© Commonwealth of Australia 2017

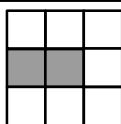
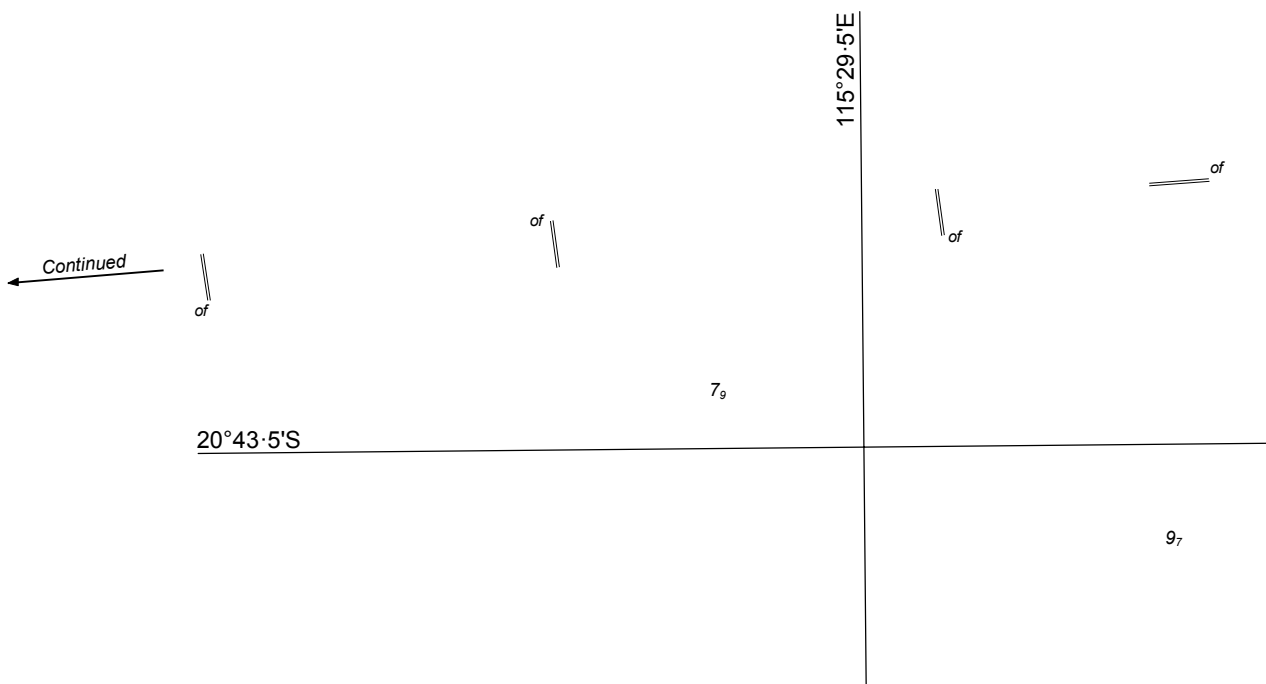
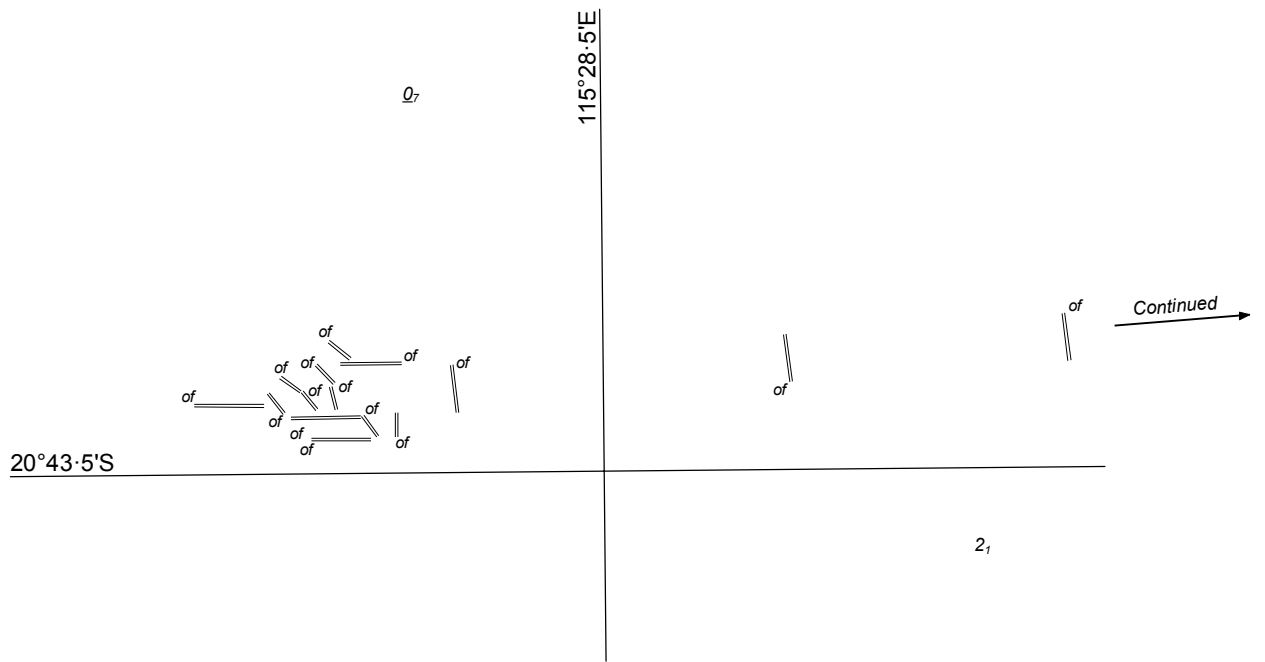

20°35'S

116°45'E

2₅

of
In lieu
2₃

7₂

Previous Notice 163/2017

NTM 207/2017

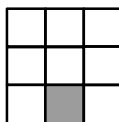

Australian Government
Department of Defence

AUS 57

© Commonwealth of Australia 2017

5₁

116°48'E

3₃

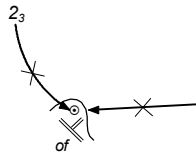

20°36'S

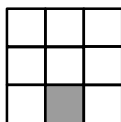

2₃

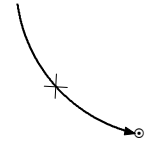

116°46'E

7₈

3₅

20°36'S

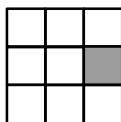

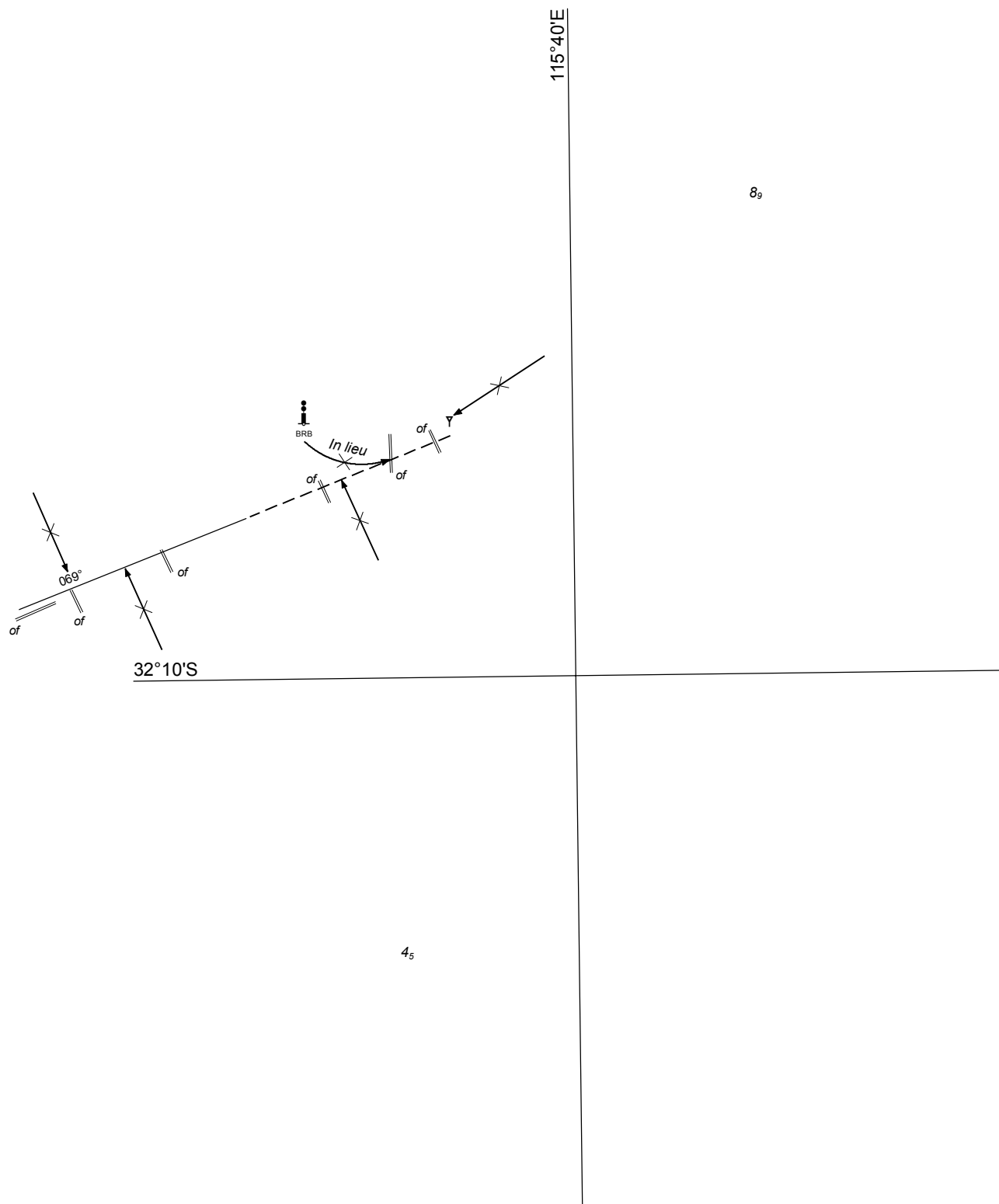

Previous Notice 139/2017

NTM 208/2017

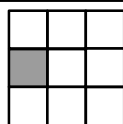

Australian Government
Department of Defence

AUS 117

© Commonwealth of Australia 2017

11₂

9₈

117°32'2"E

20°39'7"S

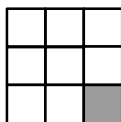
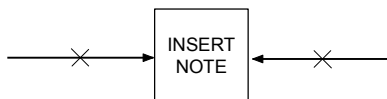

1₉

117°11'E

2₅

20°37'S

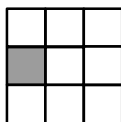
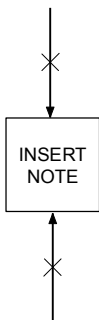

118°00'E

3₂

20°30'S

—X→ [INSERT NOTE] ←X—

Previous Notice 164/2017

NTM 209/2017

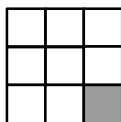

Australian Government
Department of Defence

AUS 740

© Commonwealth of Australia 2017

20°30'S

117°15'E

15₄

8₉

— × —→ INSERT NOTE ←— × —

Previous Notice 164/2017

NTM 209/2017

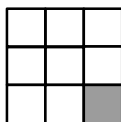

Australian Government
Department of Defence

AUS 741

© Commonwealth of Australia 2017

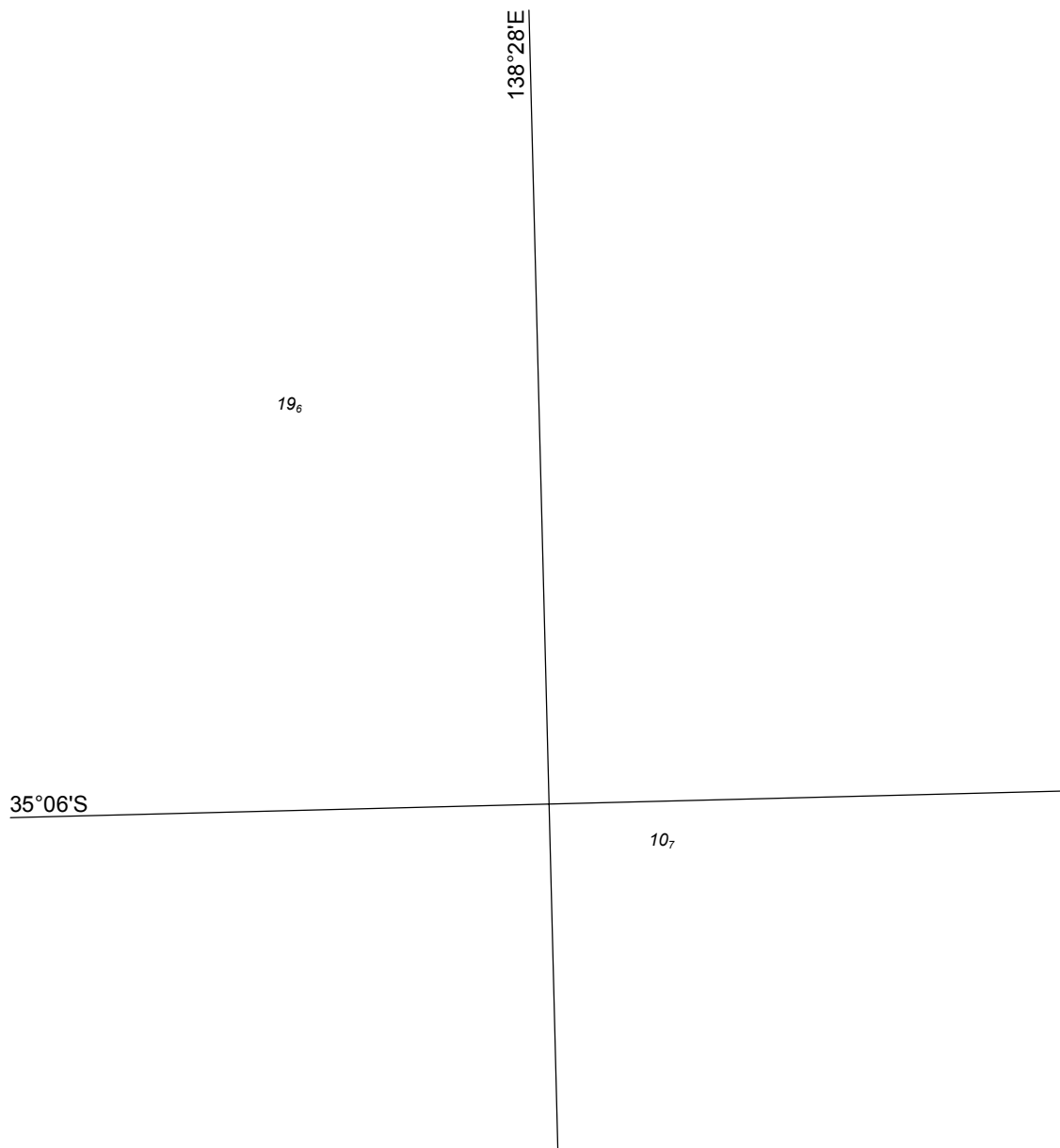

PLAN: PORT STANVAC

Previous Notice 1243/2015

NTM 210/2017

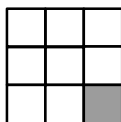

Australian Government
Department of Defence

AUS 125

© Commonwealth of Australia 2017

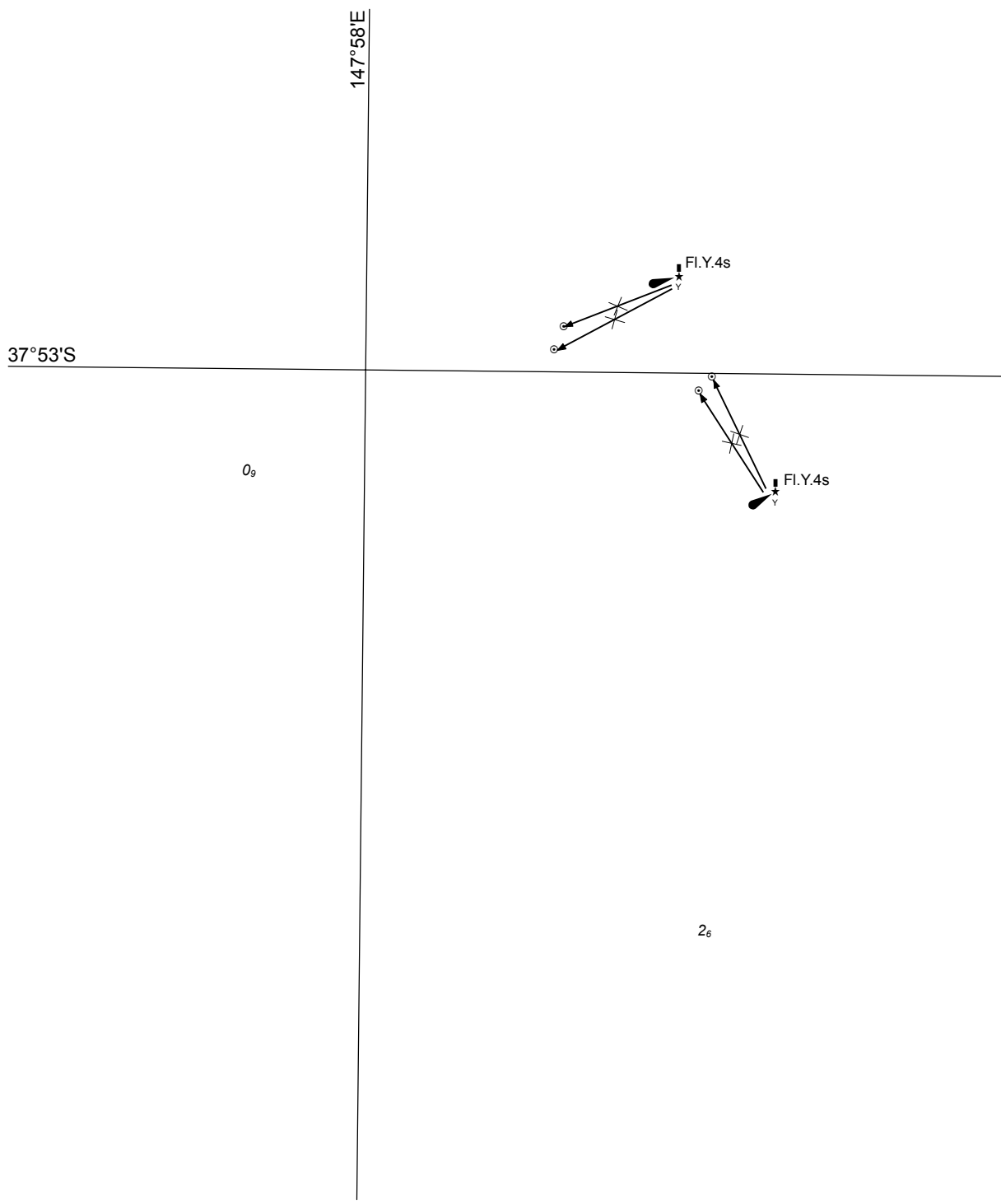

2₆

PLAN: LAKES ENTRANCE

Previous Notice 1250/2016

NTM 211/2017

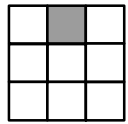

Australian Government
Department of Defence

AUS 182

© Commonwealth of Australia 2017

— × —→ INSERT NOTE ←— × —

144°44'E

37°56'S

4₂

4₅

Estuary and River Entrances
(see Note)



Previous Notice 171/2017

NTM 212/2017

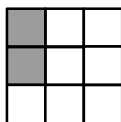

Australian Government
Department of Defence

AUS 155

© Commonwealth of Australia 2017