

PLAN:
MORUYA RIVER ENTRANCE

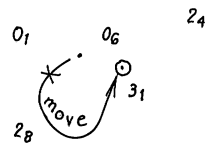

586/2009

642/2010

© commonwealth of Australia 2010

AUS 191

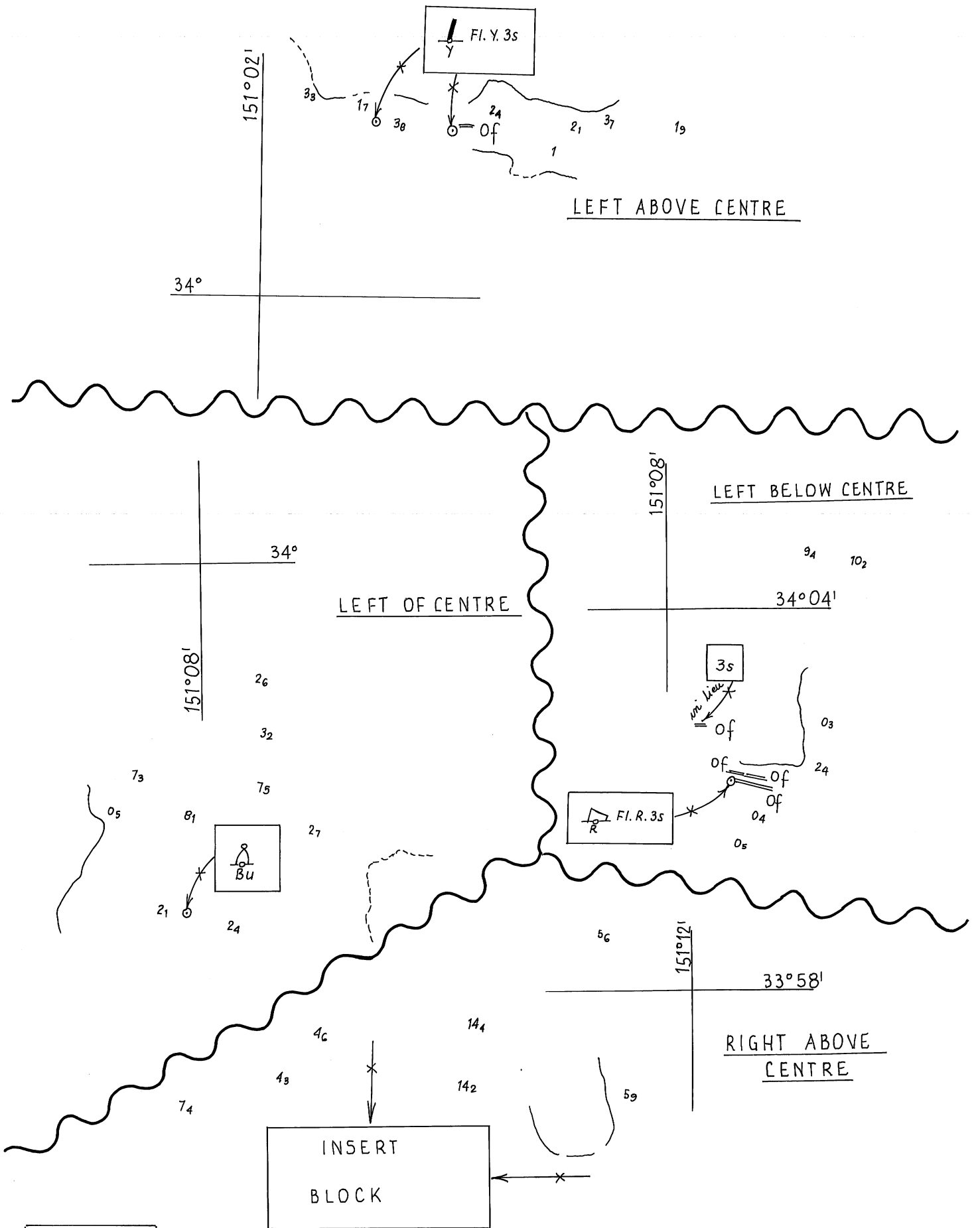

582/2010

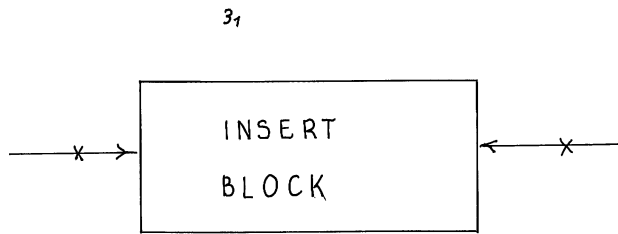

29

39

81

LEFT ABOVE
CENTRE

151°10'

36

89

52

34

33°58'

32

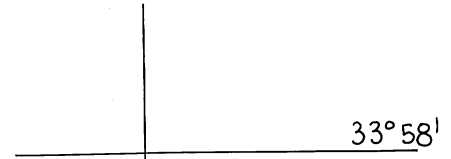

LEFT ABOVE
CENTRE

151°12'

144

59

115

move



15c

241/2010

PAGE 1 OF 2

644/2010

© Commonwealth of Australia 2010

172

AUS 199

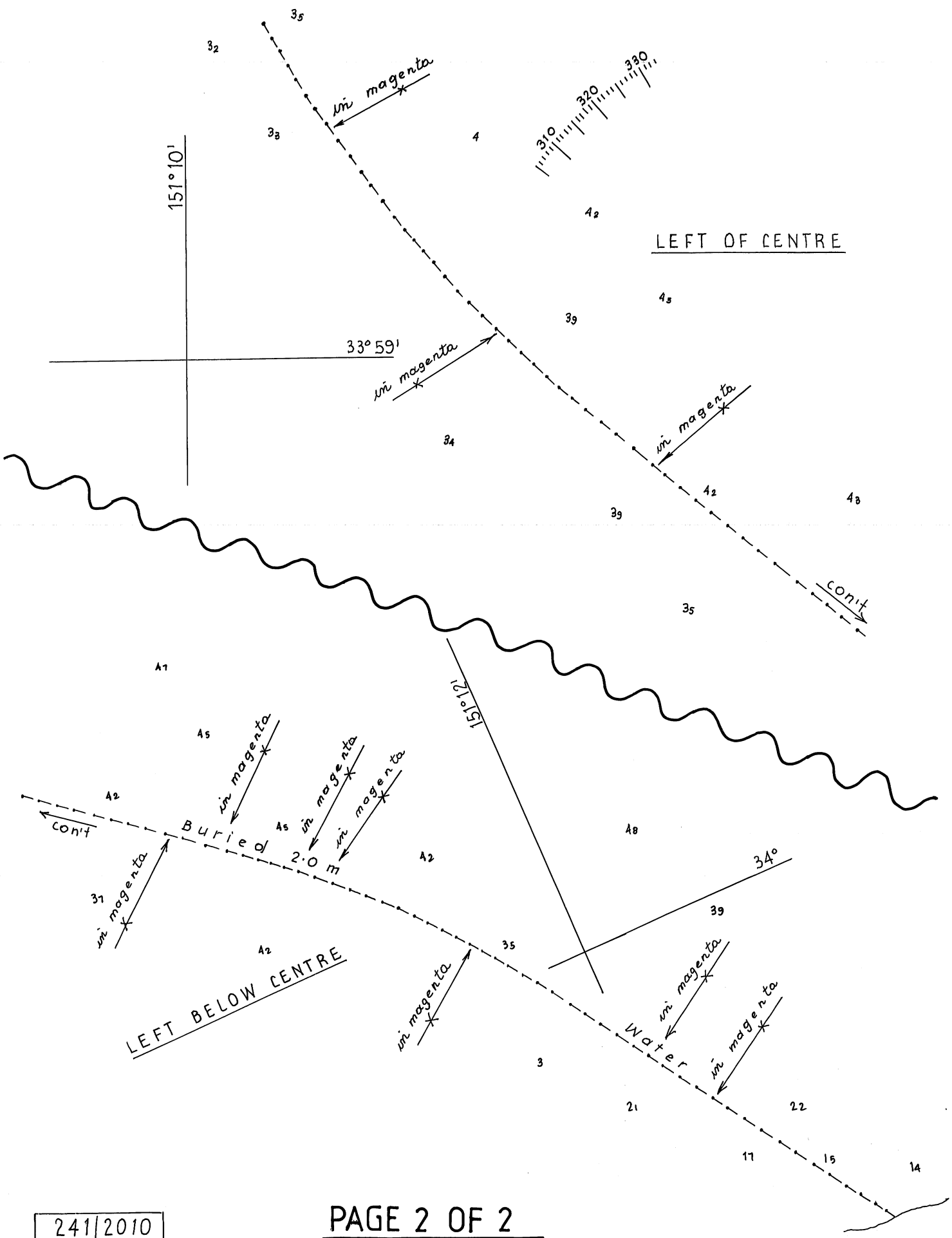

241|2010

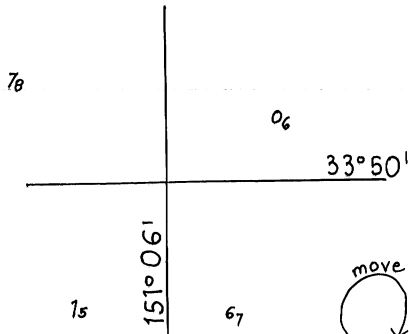

LEFT ABOVE CENTRE

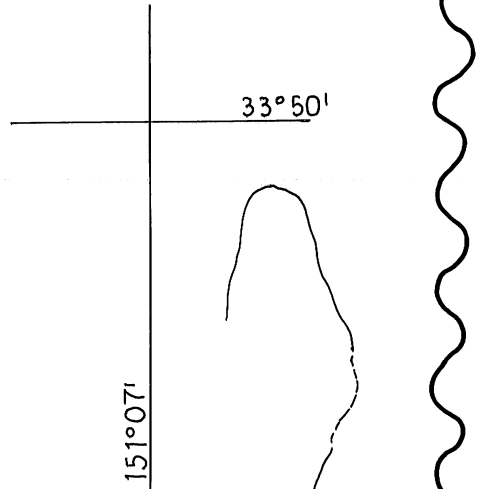

LEFT ABOVE CENTRE

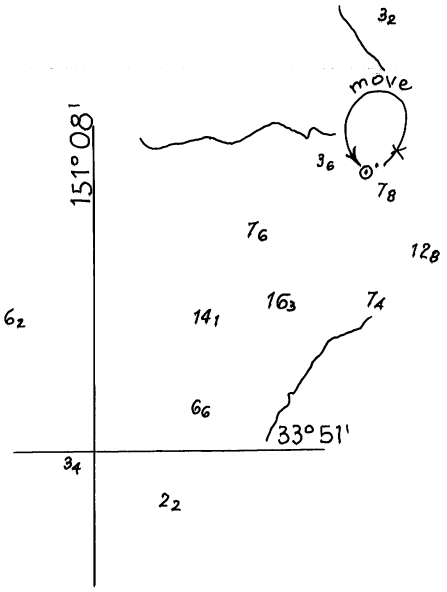

RIGHT OF CENTRE

135/2009

645/2010

© Commonwealth of Australia 2010

AUS 203

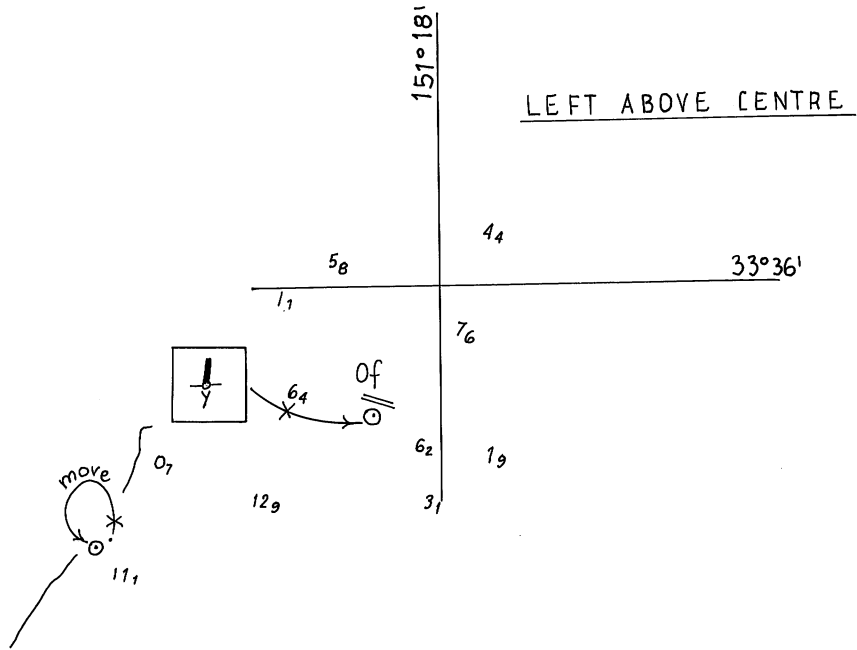

351/2010

646/2010

© Commonwealth of Australia 2010

AUS 215

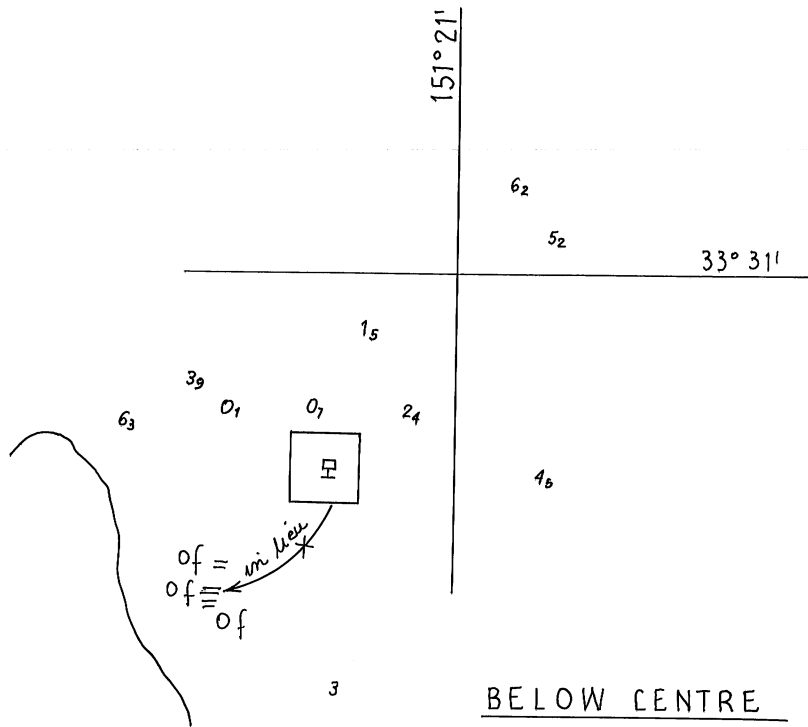

284/2010

647/2010

© Commonwealth of Australia 2010

AUS 216

152° 48'

31° 38'

PLAN:
CAMDEN HAVEN

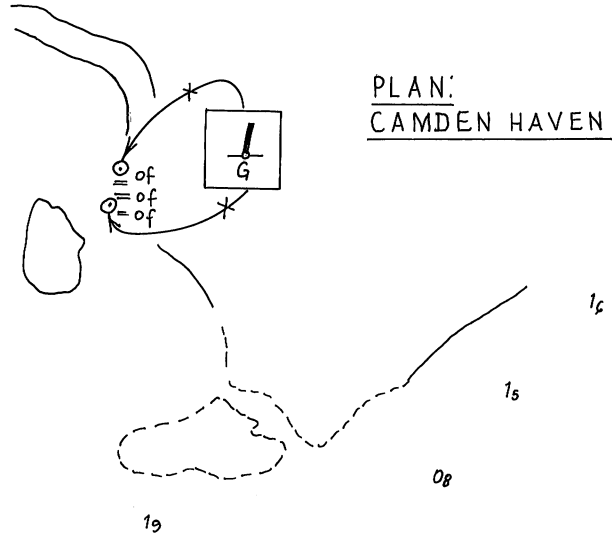

537/2010

648/2010

© Commonwealth of Australia 2010

AUS 219

RIGHT BELOW CENTRE

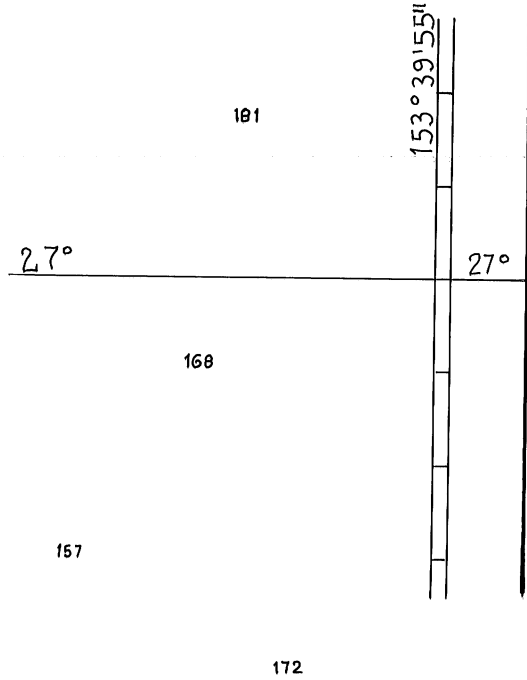
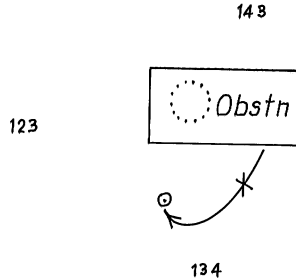

539/2010

649/2010

© Commonwealth of Australia 2010

AUS 235

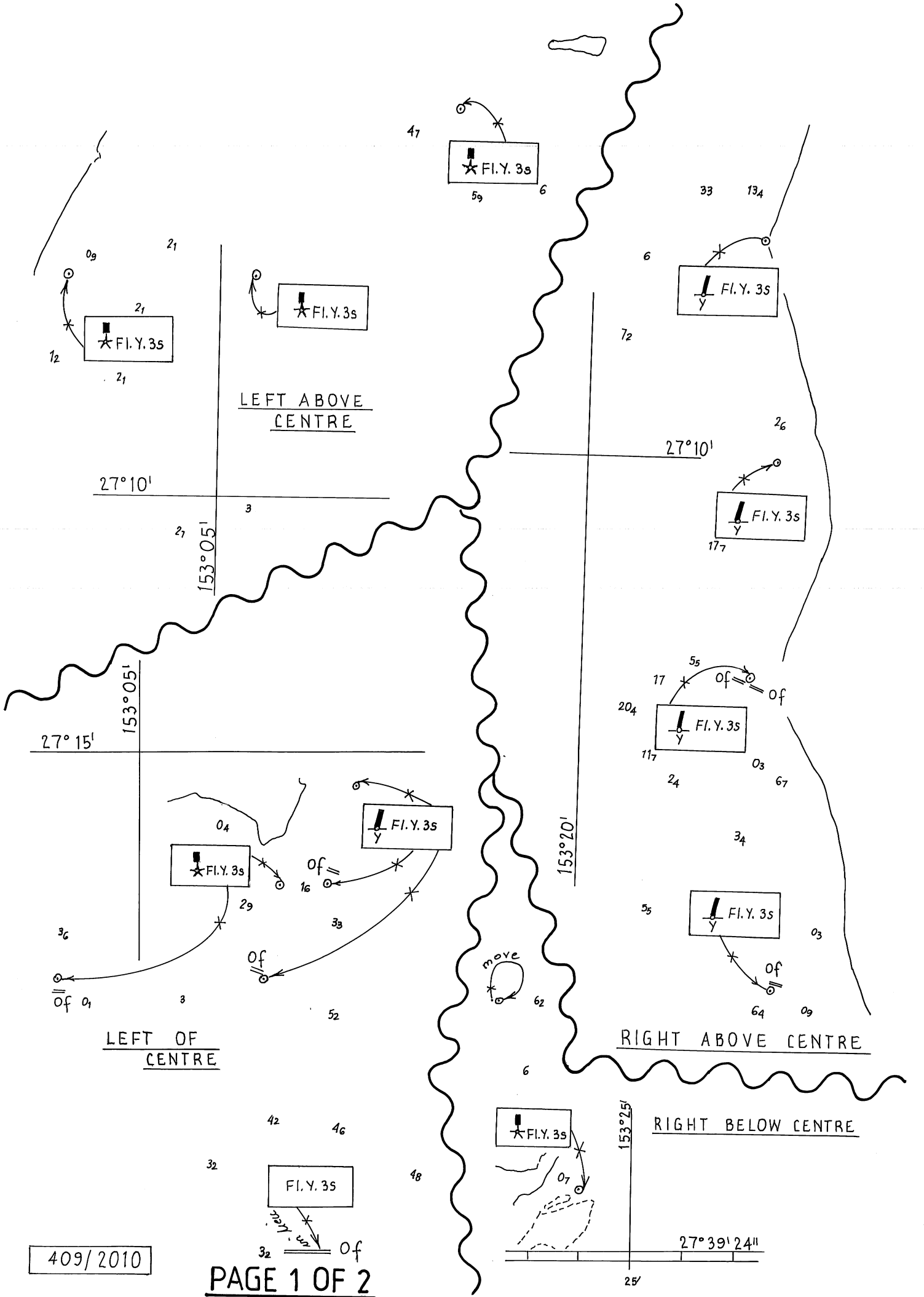

409/2010

PAGE 1 OF 2

650/2010

© Commonwealth of Australia 2010

AUS 236

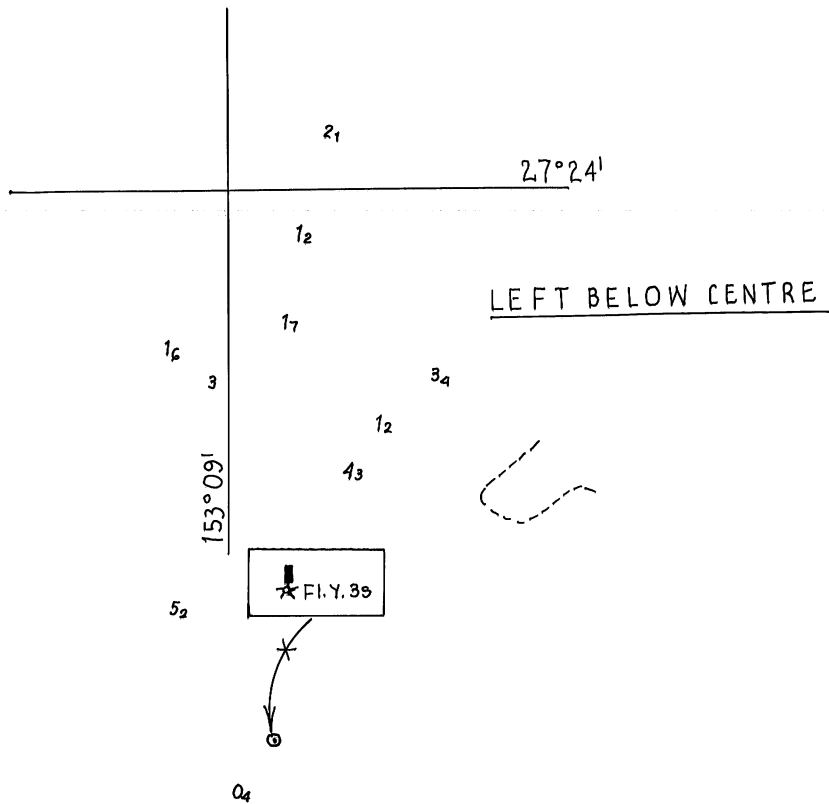

407/2010

651/2010

© commonwealth of Australia 2010

AUS 237

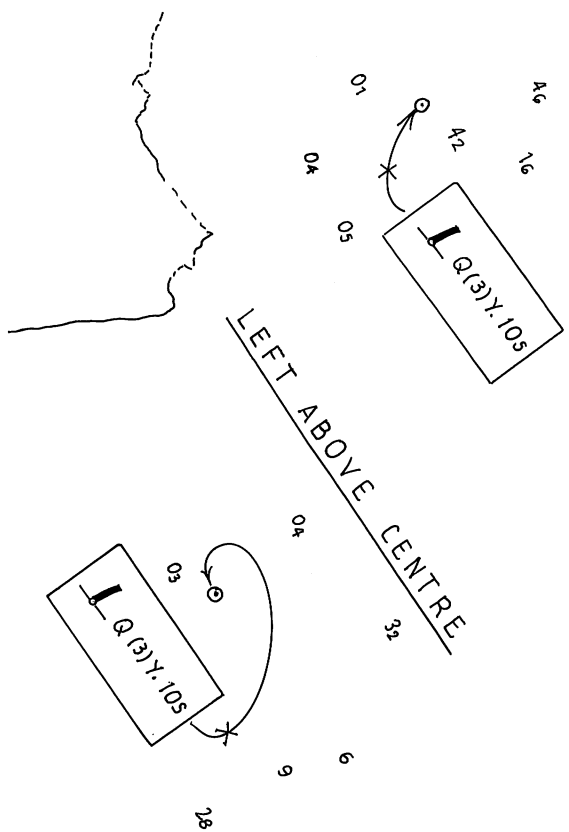
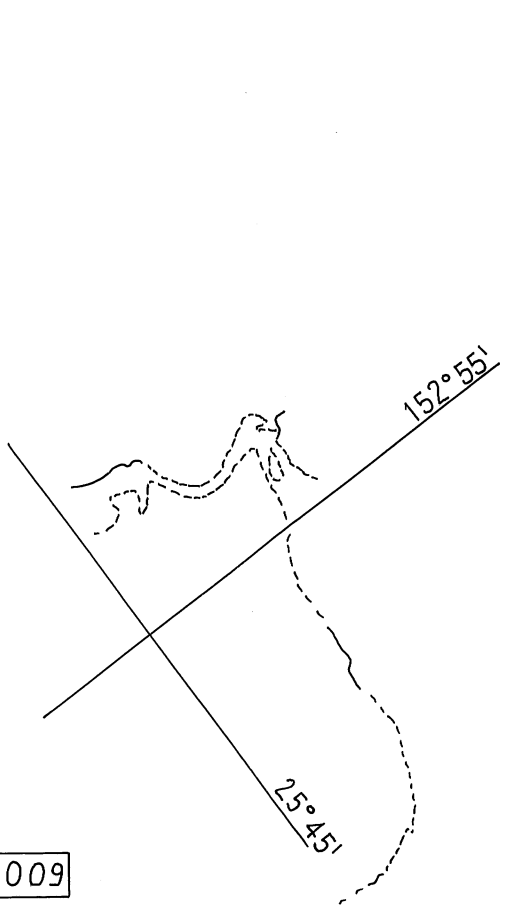

986/2009

652/2010

© Commonwealth of Australia 2010

AUS 240

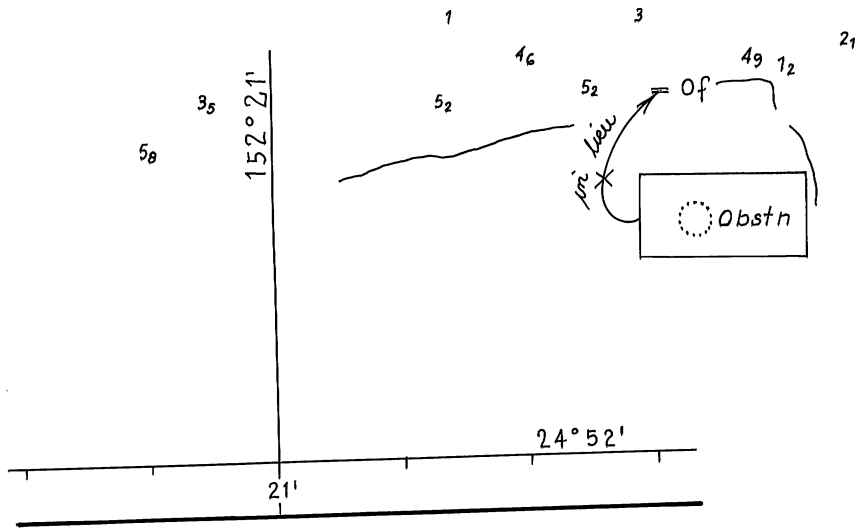

PLAN:
BURNETT RIVER (SOUTHERN SECTION)

41/2009

653/2010

© Commonwealth of Australia 2010

AUS 242

PLAN:
FISHERMANS LANDING
WHARVES

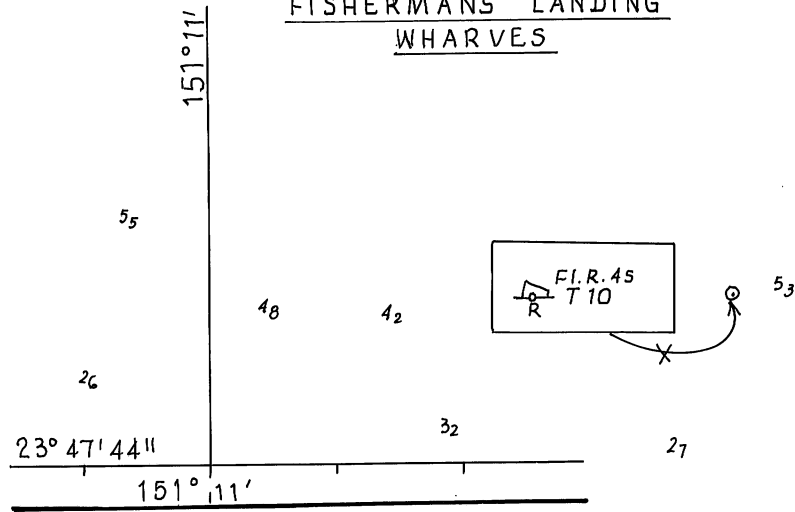

196/2010

654/2010

© Commonwealth of Australia 2010

AUS 244

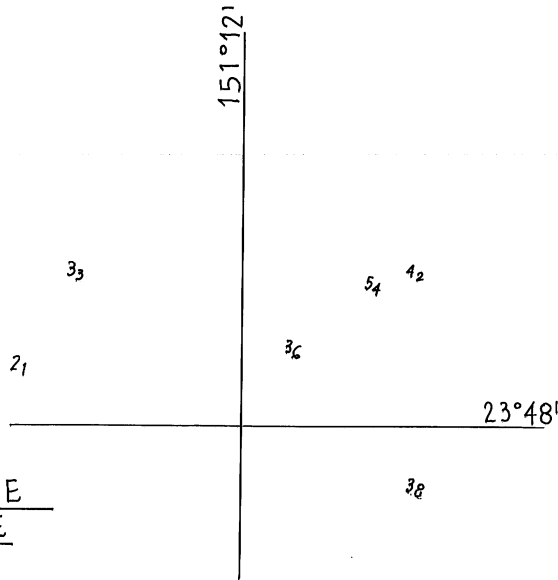
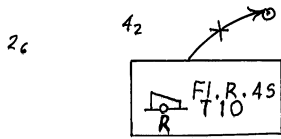

LEFT ABOVE
CENTRE

196/2010

654/2010

© Commonwealth of Australia 2010

AUS 245

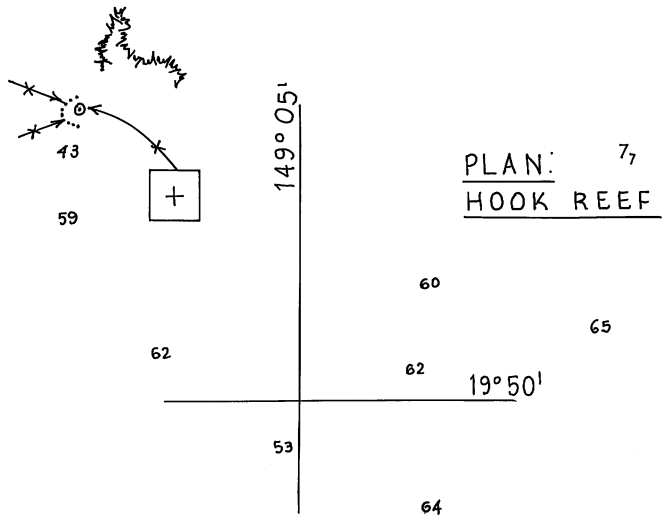

31/2010

655/2010

© commonwealth of Australia 2010

AUS 254

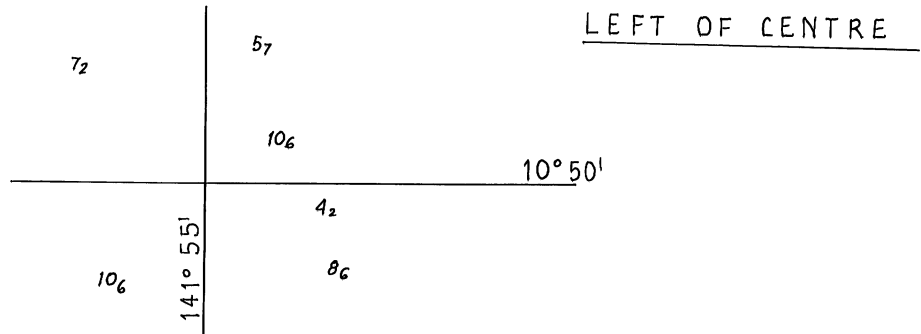
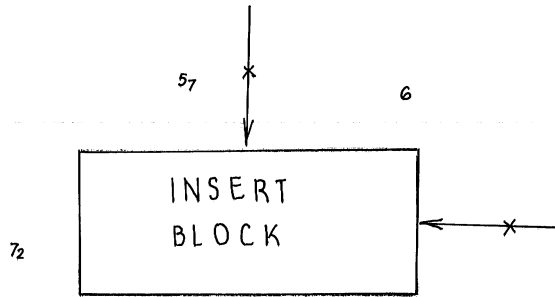

1097/2009

656/2010

© Commonwealth of Australia 2010

AUS 294

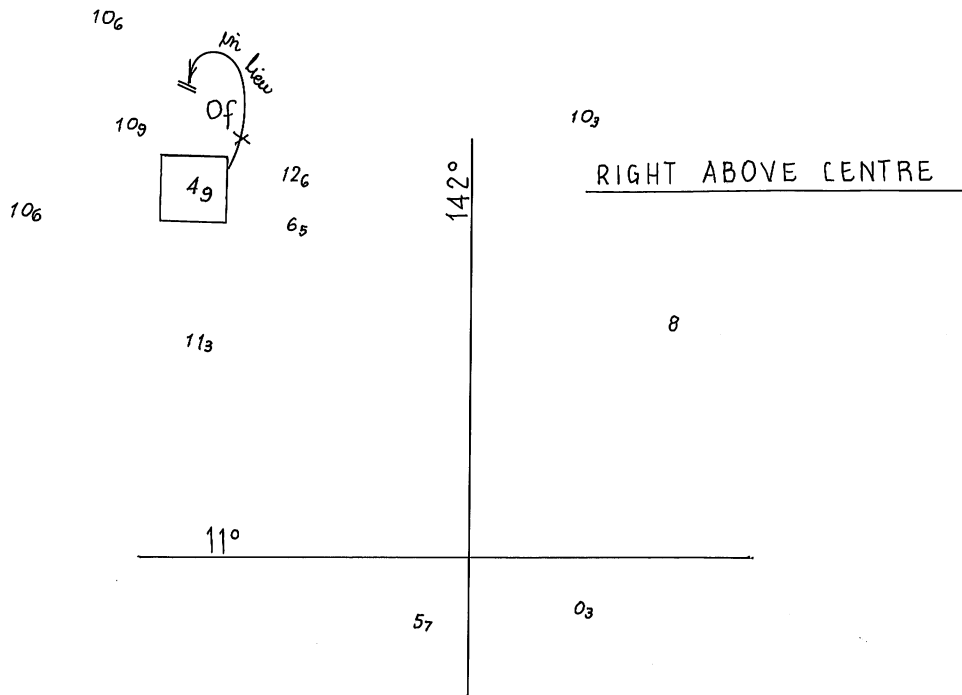

NE 26-2-2010

656/2010

© commonwealth of Australia 2010

AUS 301

896

272

LEFT ABOVE CENTRE

114° 30'

20° 30'

785

283

832

690:Obstn

218

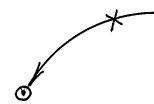

547/2010

657/2010

© Commonwealth of Australia 2010

AUS 328

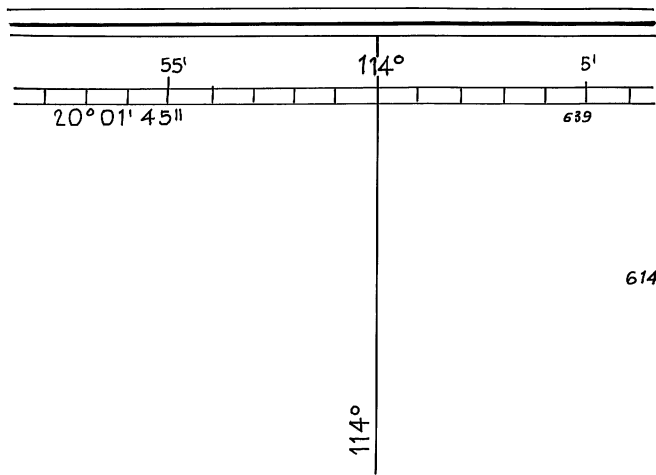

614



611

609

RIGHT ABOVE CENTRE

547/2010

658/2010

© Commonwealth of Australia 2010

AUS 329

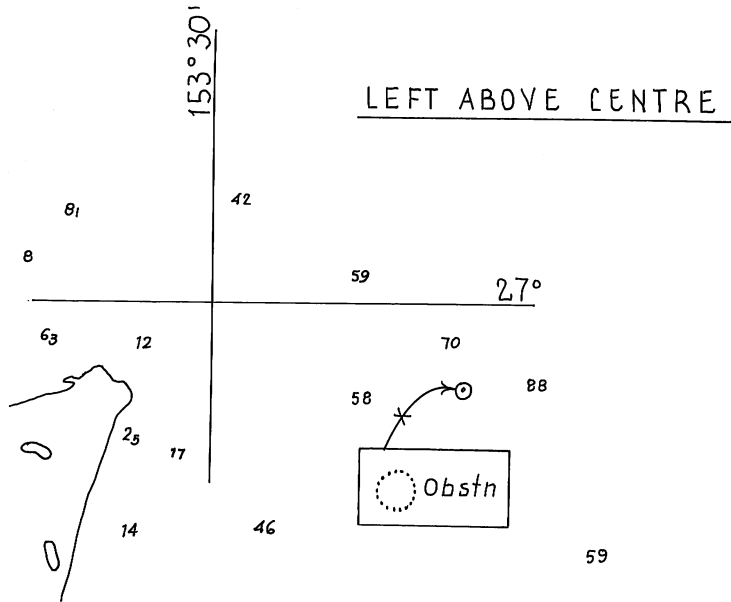

103/2010

649/2010

© Commonwealth of Australia 2010

AUS 364

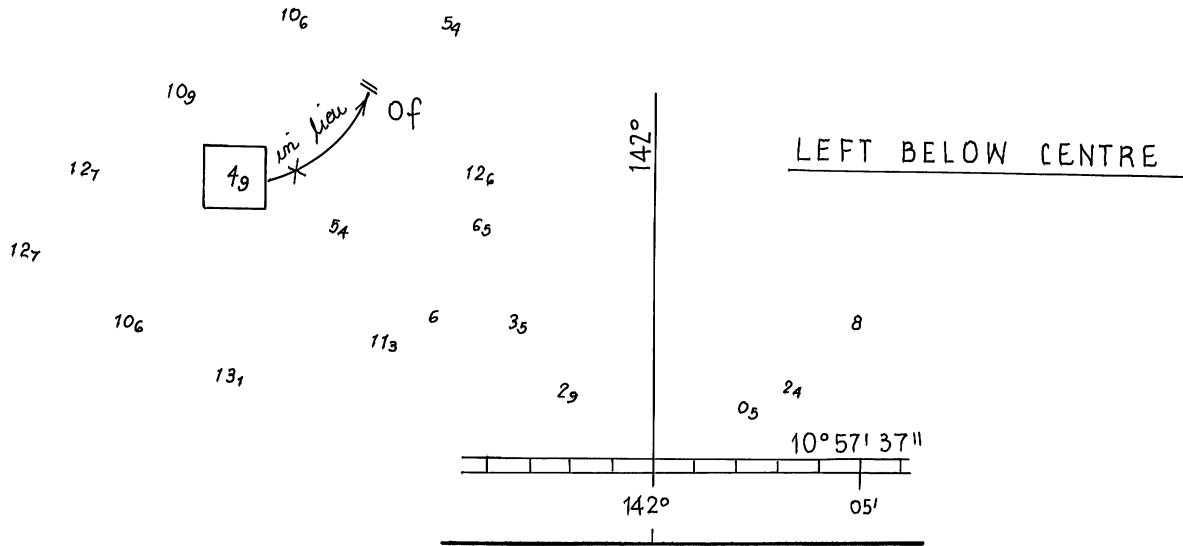

590/2010

656/2010

© Commonwealth of Australia 2010

AUS 376

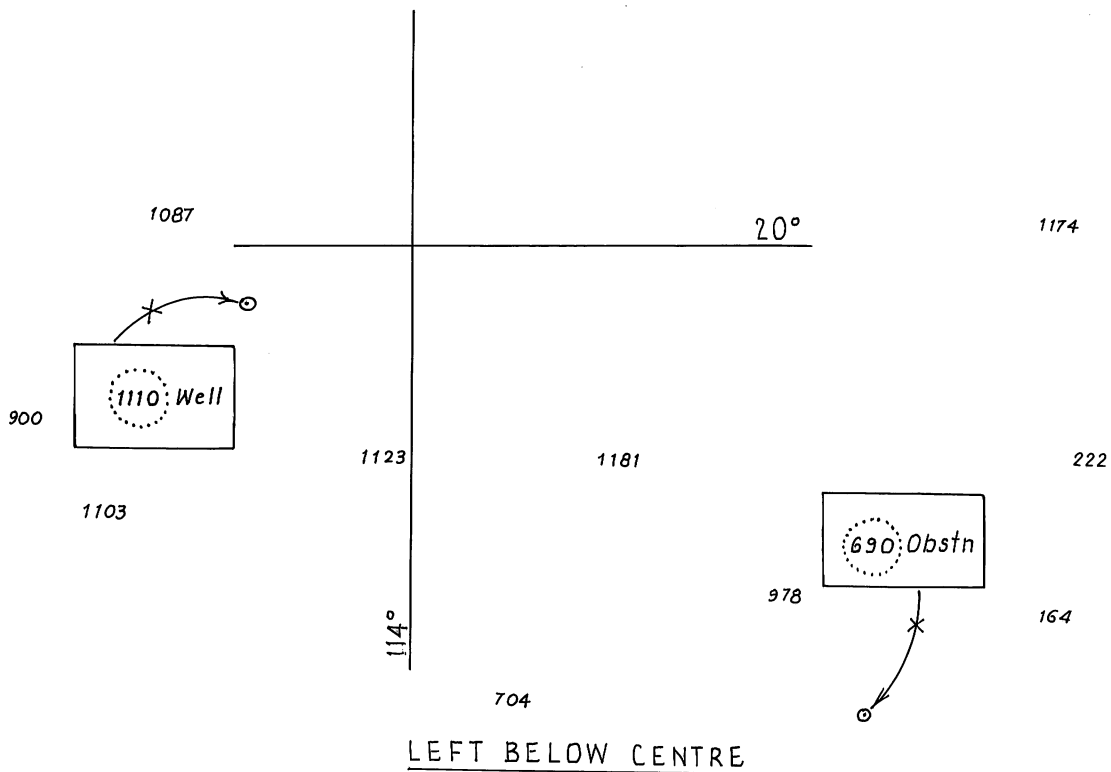

482/2010

657,658/2010

© Commonwealth of Australia 2010

AUS 415

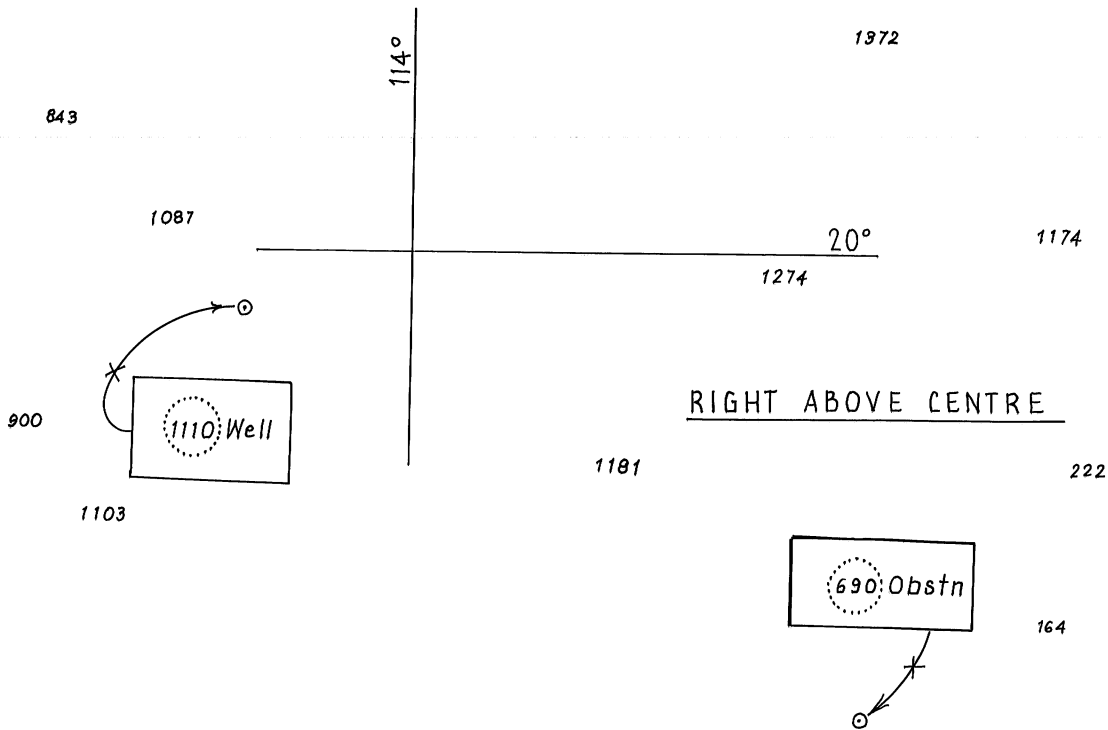

258/2010

657,658/2010

© Commonwealth of Australia 2010

AUS 416

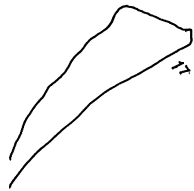

25

33

63

15

Of $\frac{1}{10}$

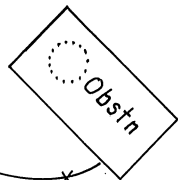

875

LEFT ABOVE CENTRE

154°

58

44

44

44

209

14.50

1072

26°

537/2010

649/2010

© Commonwealth of Australia 2010

AUS 424

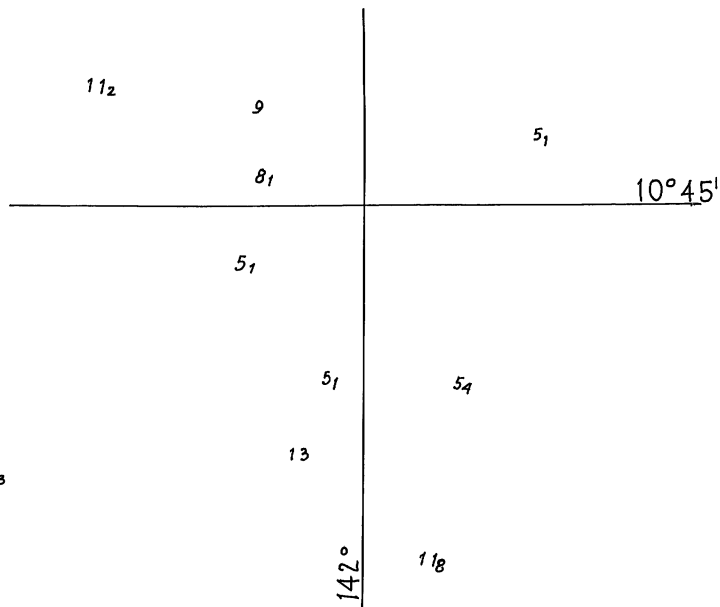
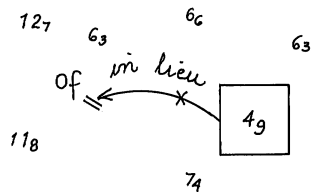

RIGHT BELOW CENTRE

590/2010

656/2010

© commonwealth of Australia 2010

AUS 700

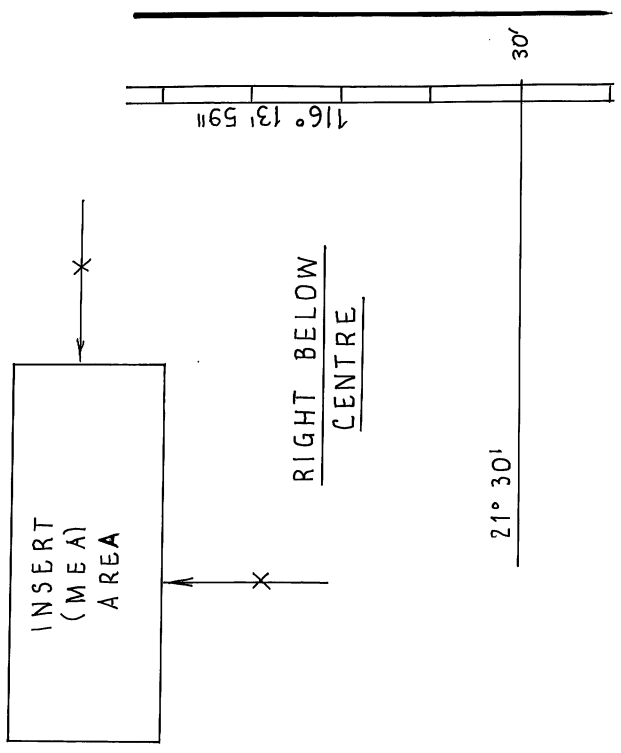
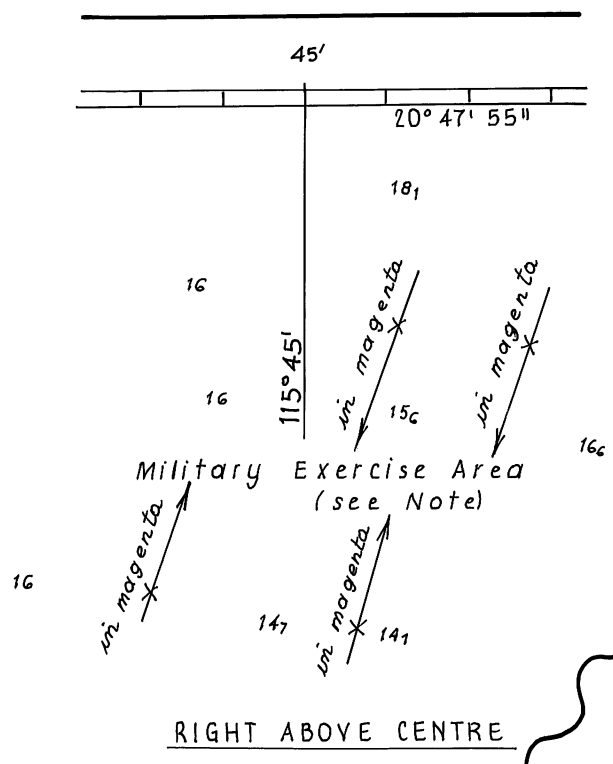
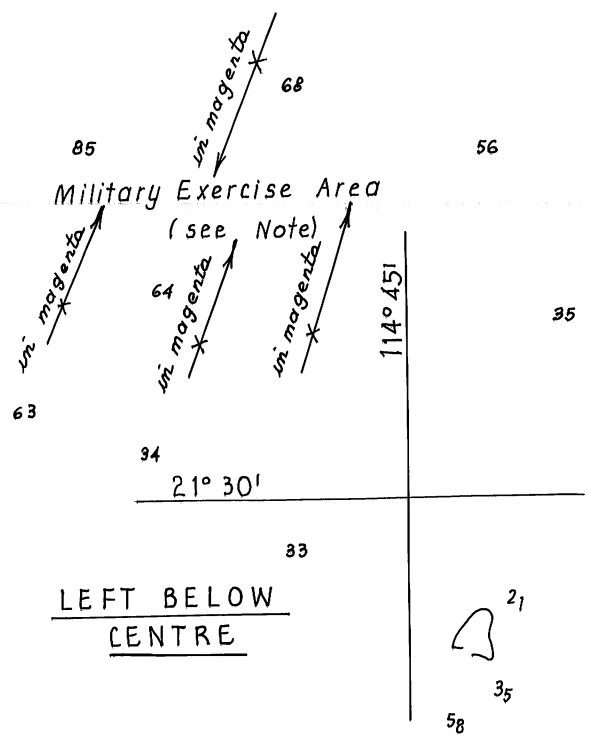
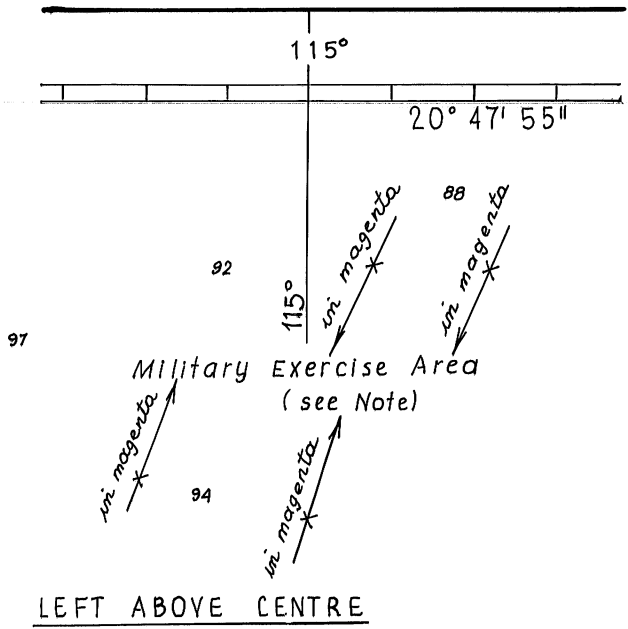

P
R
C
L
T

418/2010

659/2010

© Commonwealth of Australia 2010

AUS 743

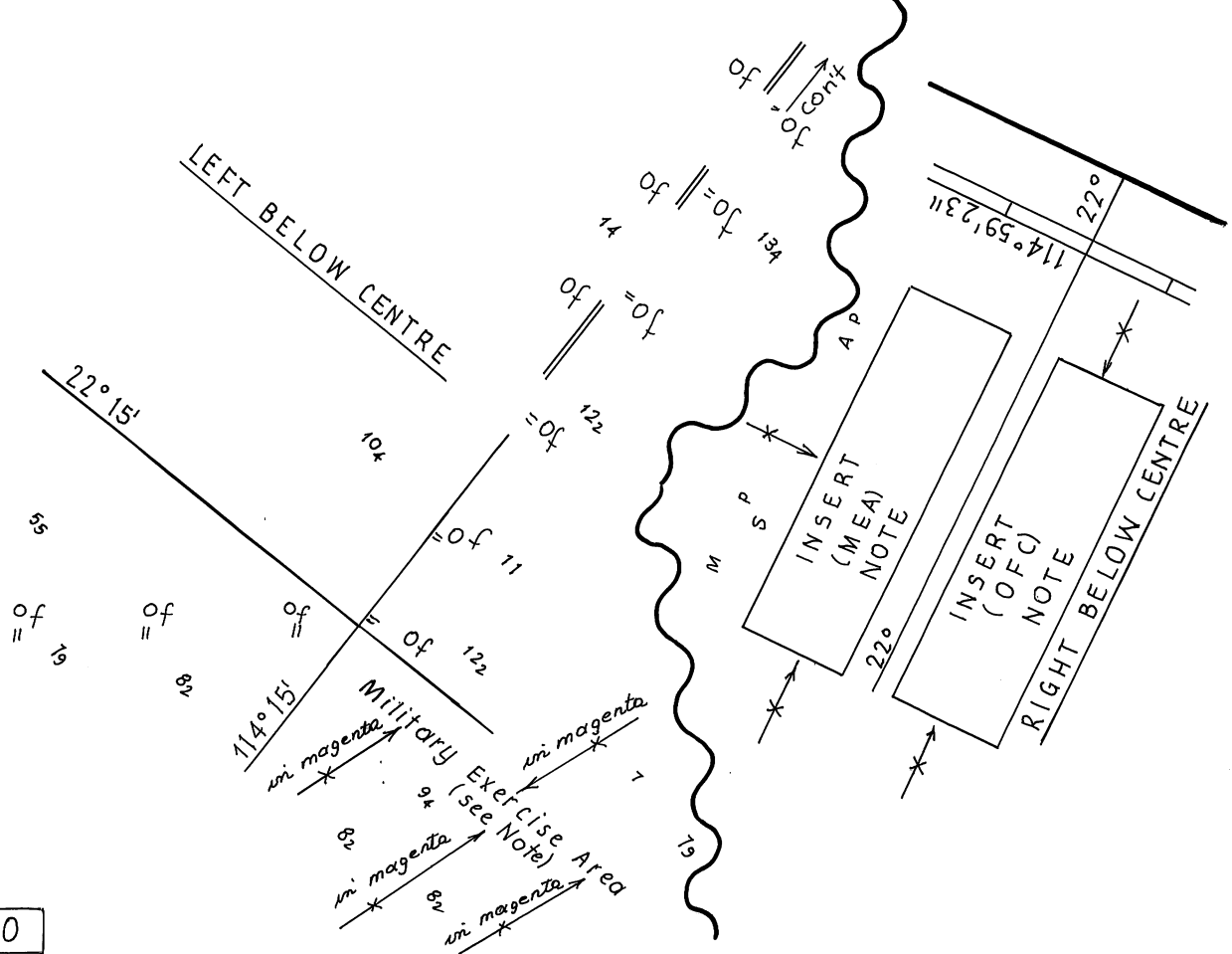
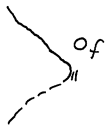

547/2010

659/2010

PAGE 1 OF 2

© Commonwealth of Australia 2010

AUS 744

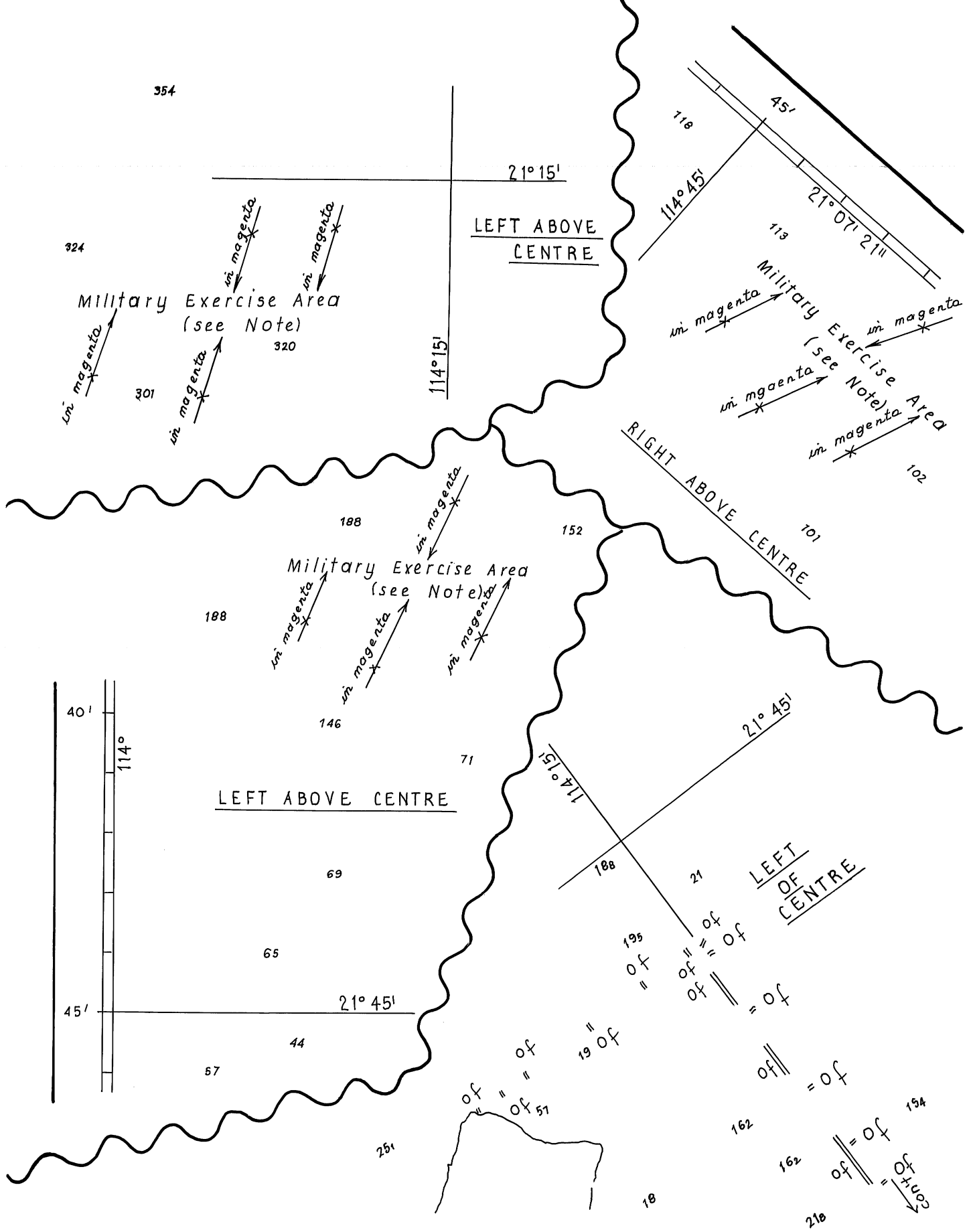

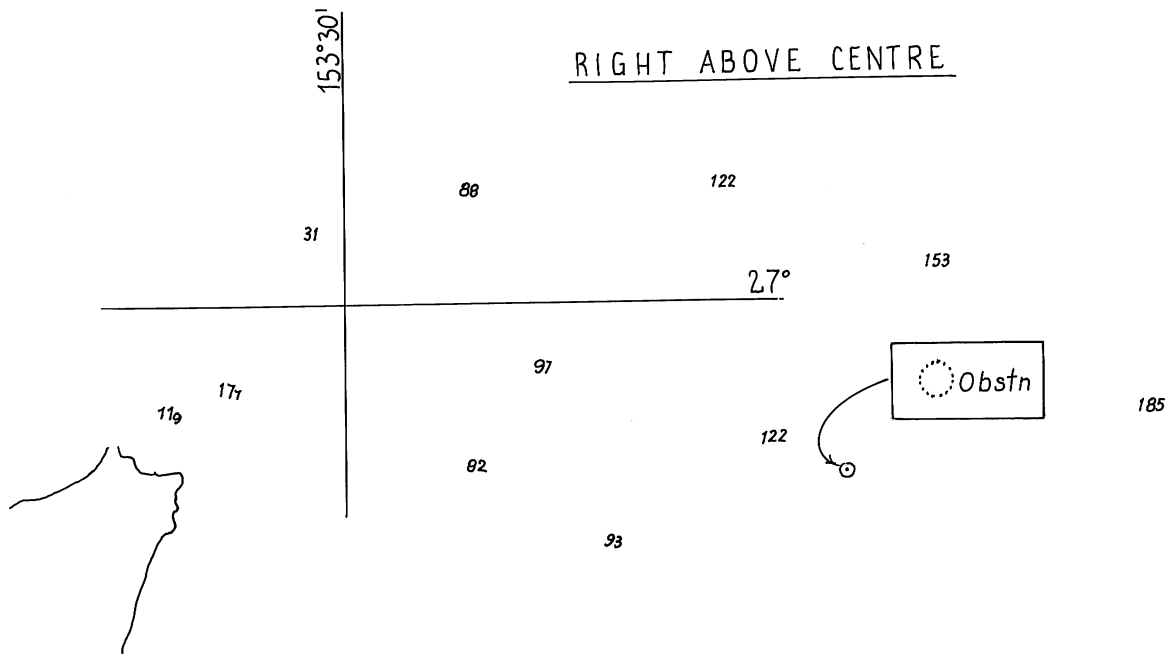

104/2010

649/2010

© Commonwealth of Australia 2010

AUS 814

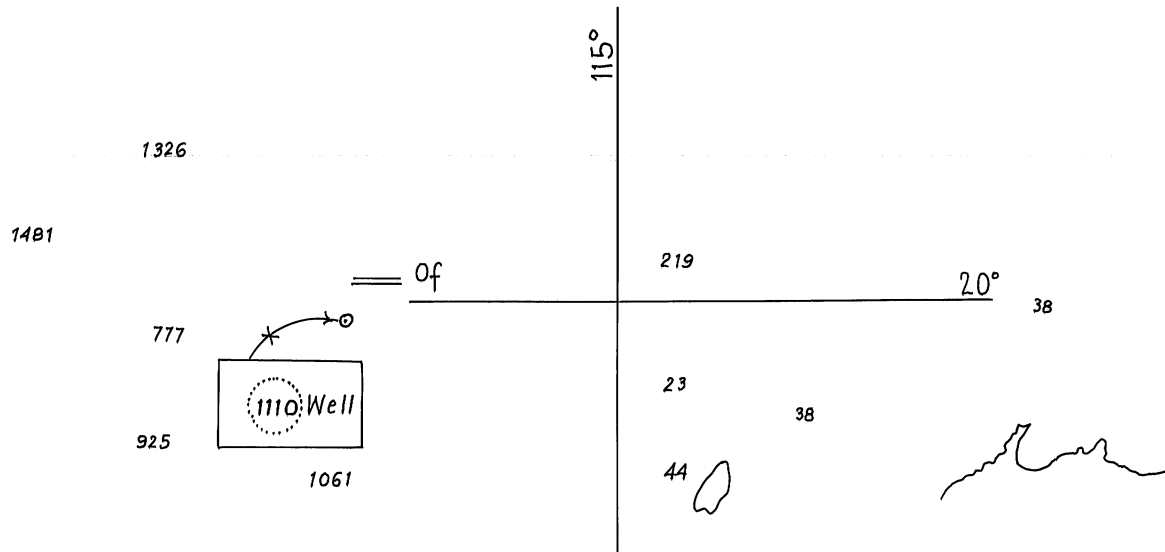

RIGHT ABOVE CENTRE

597/2010

658/2010

© Commonwealth of Australia 2010

INT 708
AUS4708