

PLAN:
BICKERTON
ISLAND

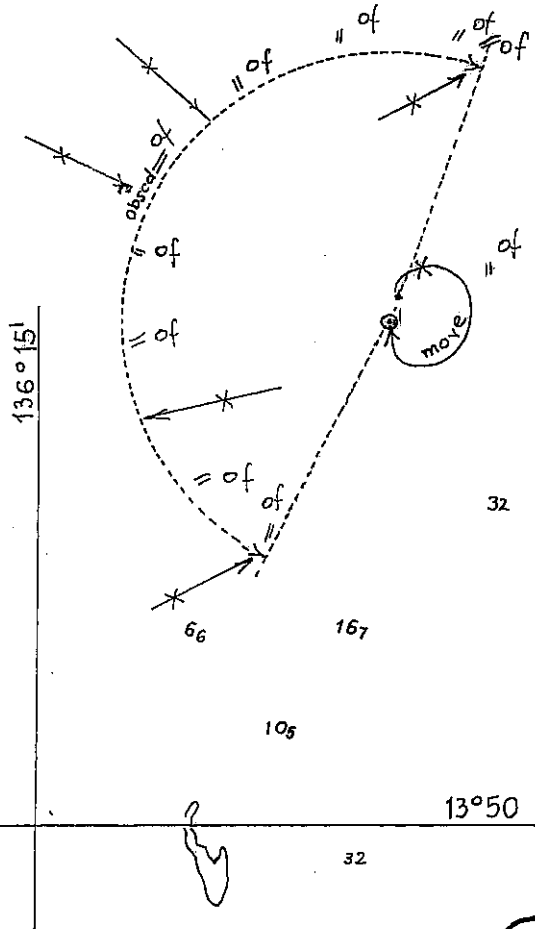

678/2005

168/2006

© Commonwealth of Australia 2006

13

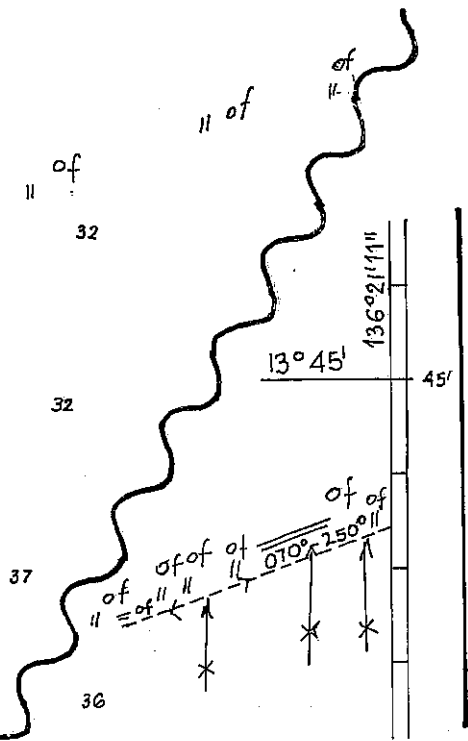

PLAN:
BICKERTON
ISLAND

F2

AUS

13

RIGHT BELOW CENTRE

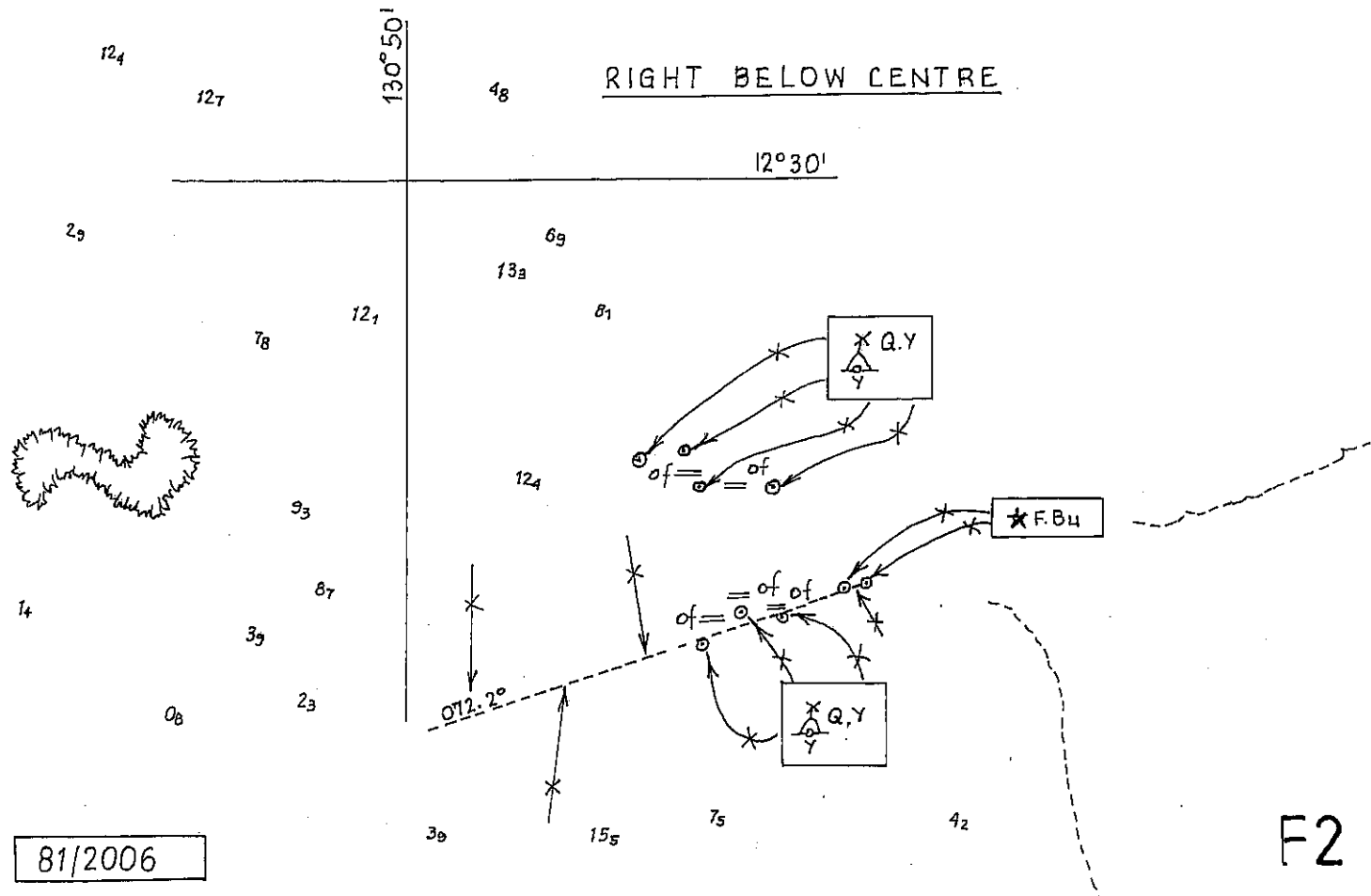

81/2006

169/2006

© Commonwealth of Australia 2006

F2
AUS 26

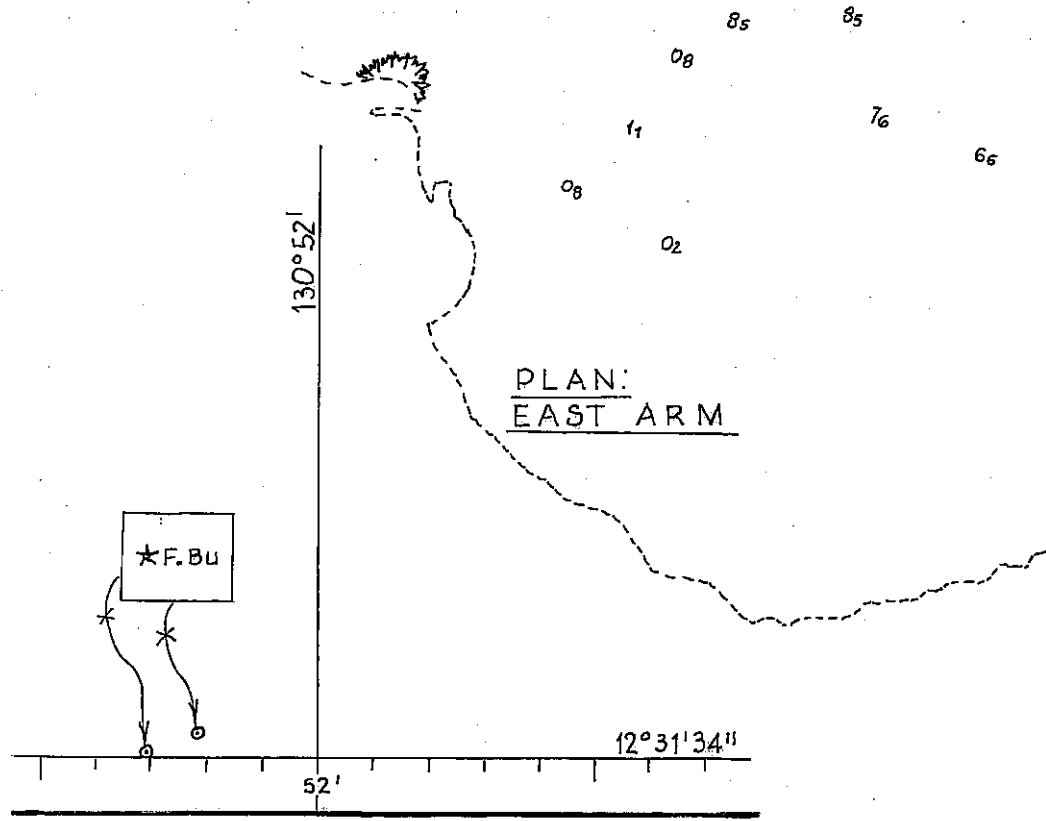

81/2006

169/2006

© Commonwealth of Australia 2006

F2
AUS 28

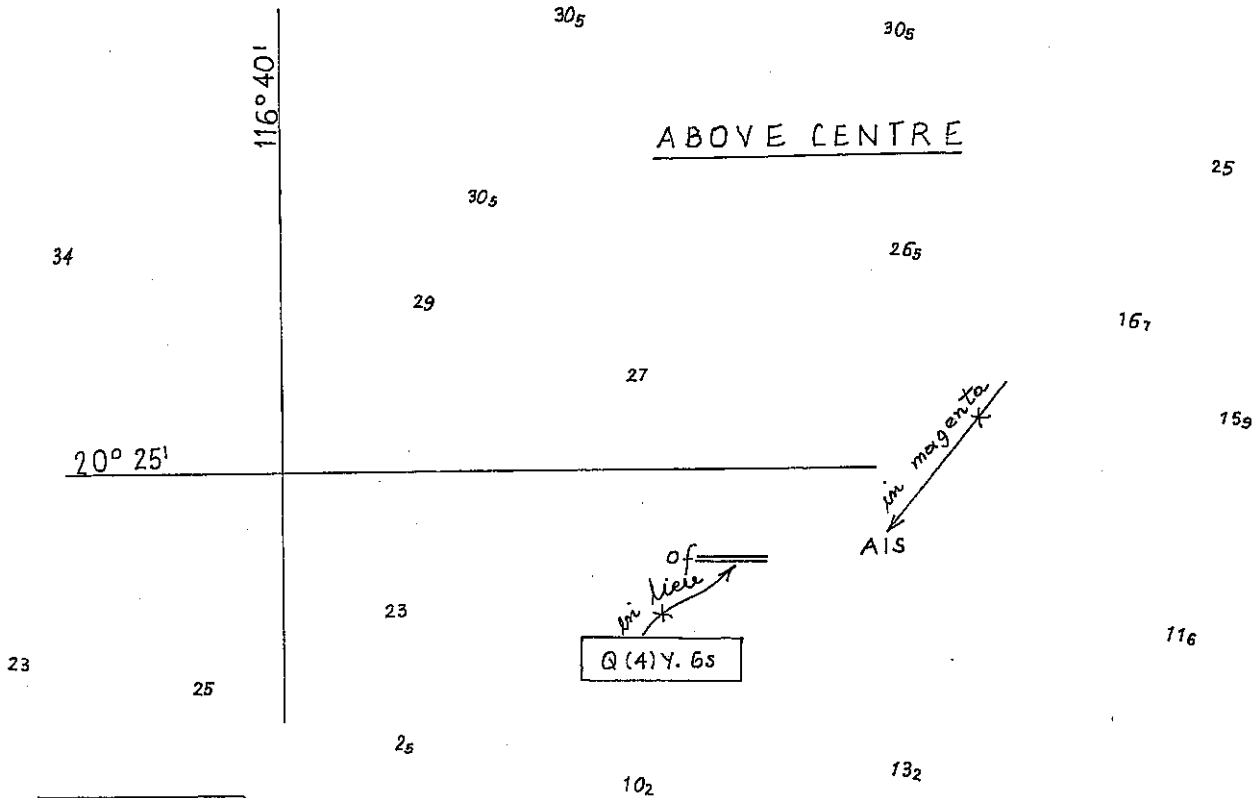

1072/2005

170/2006

© Commonwealth of Australia 2006

F3
AUS 57

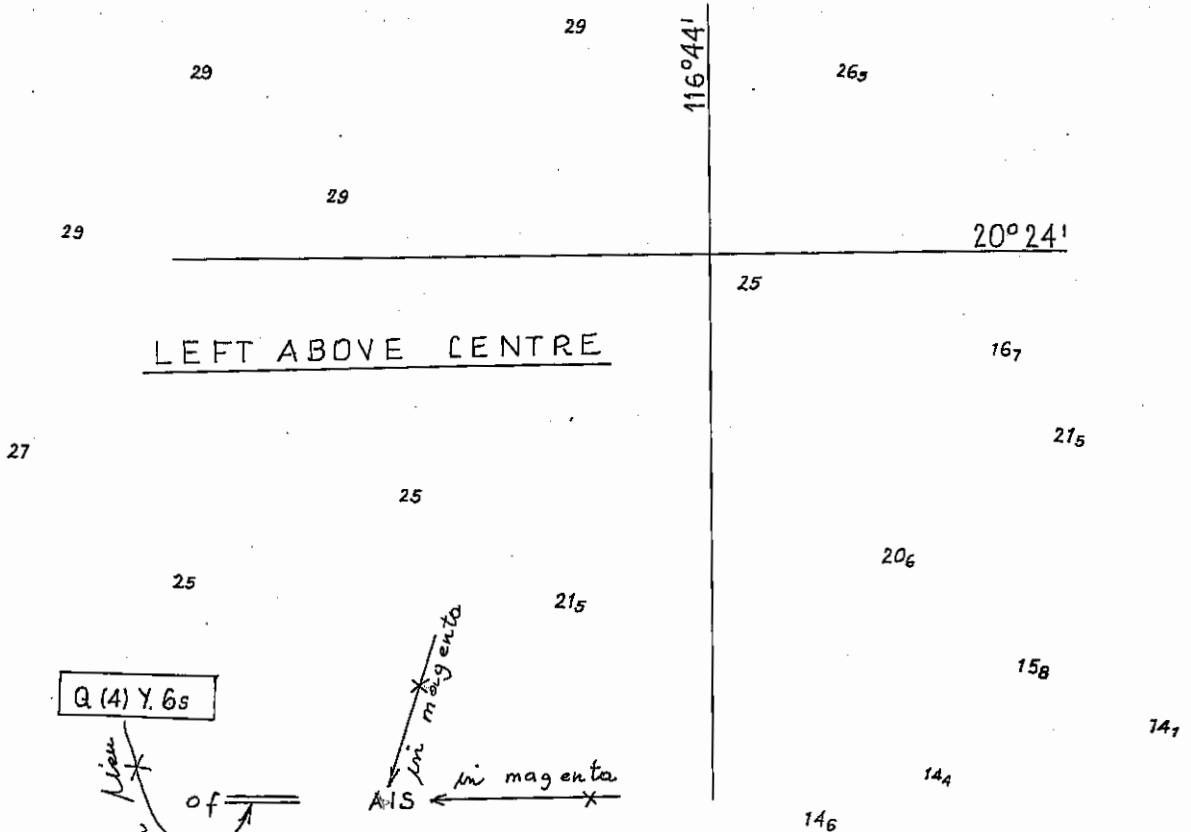

1106/2005

170/2006

© Commonwealth of Australia 2006

F3
AUS 58

PLAN:
PORT LINCOLN
WHARVES

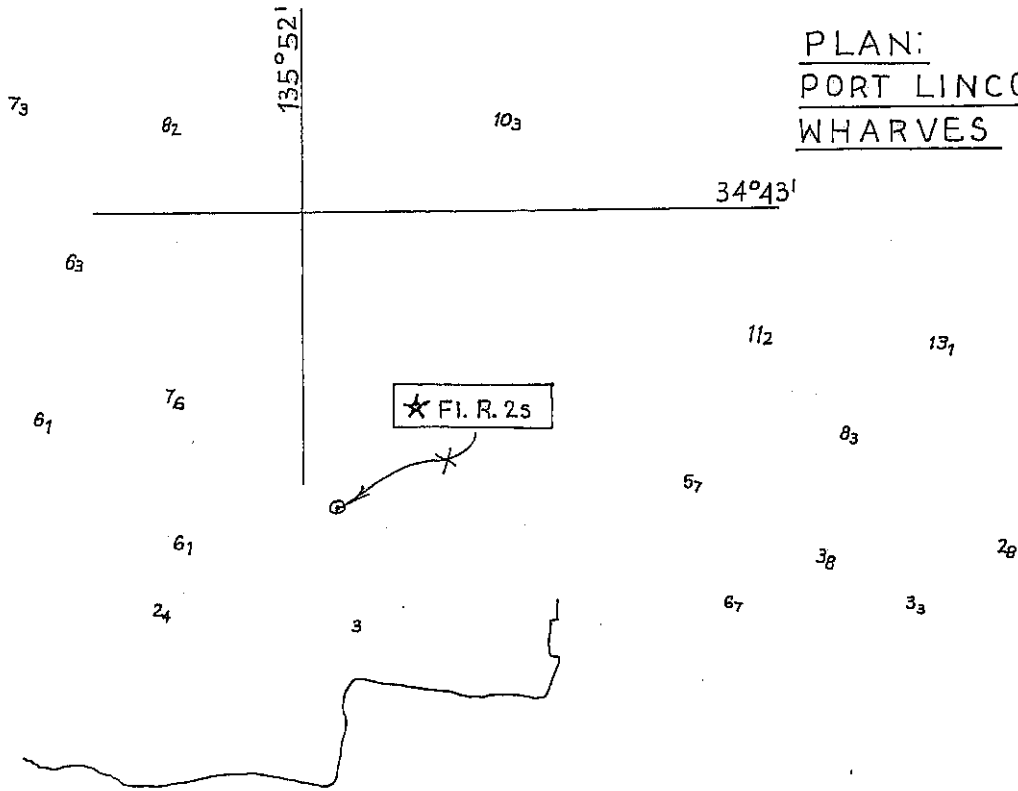

863/2005

171/2006

© Commonwealth of Australia 2006

F5

AUS 134

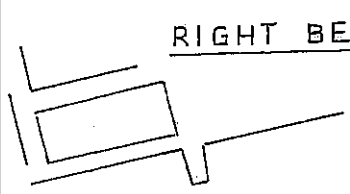
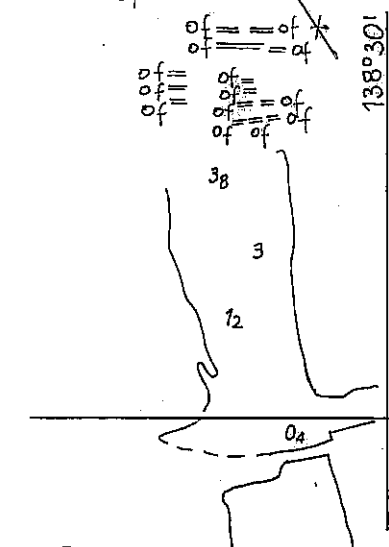
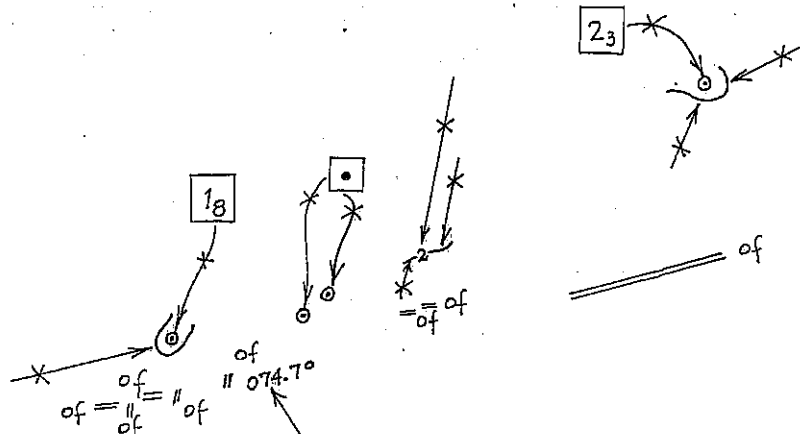

RIGHT BELOW CENTRE

34°51'

685/2005

172/2006

© Commonwealth of Australia 2006

F5
AUS 137

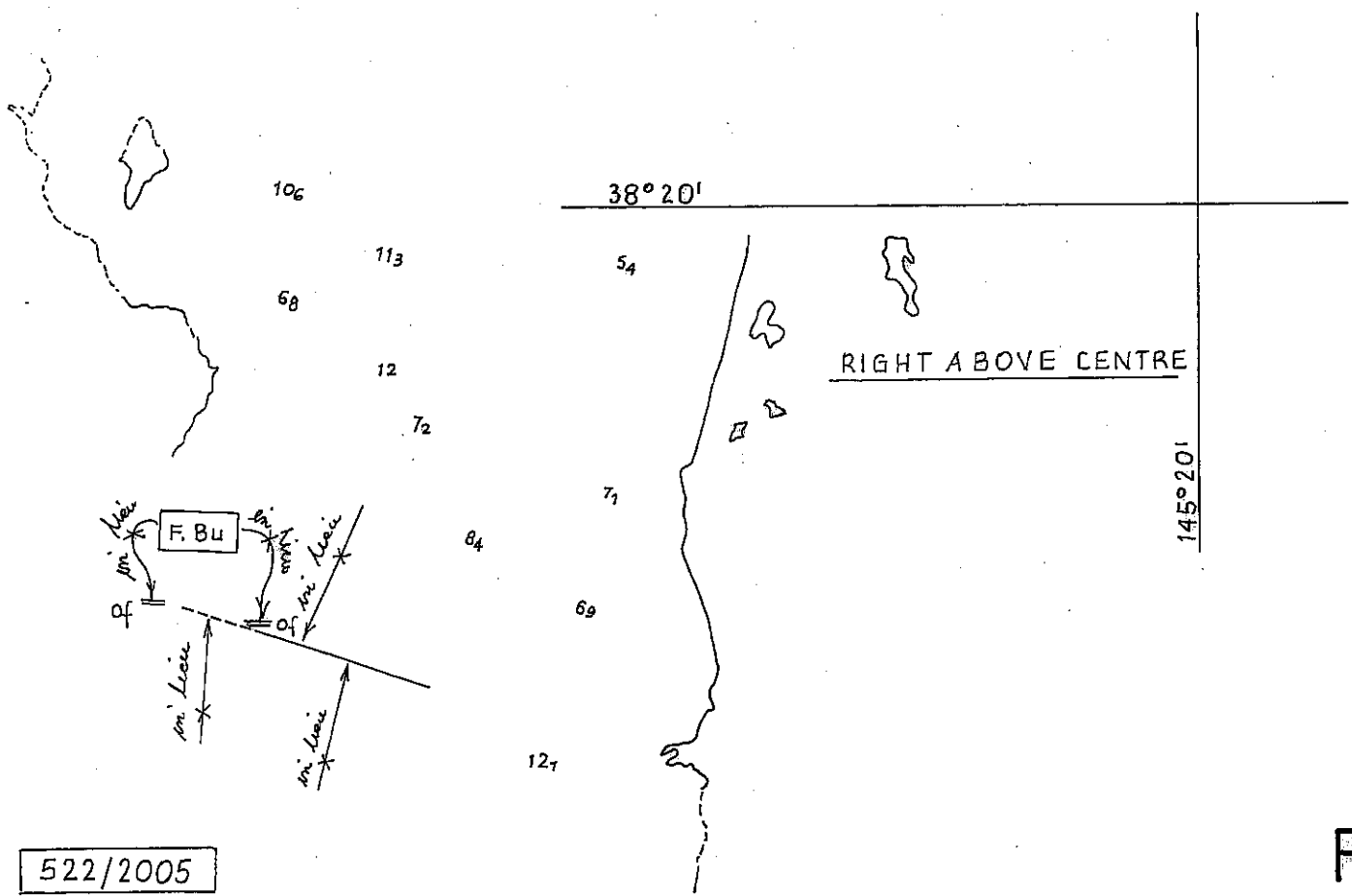

522/2005

176/2006

© Commonwealth of Australia 2006

F6
AUS 150

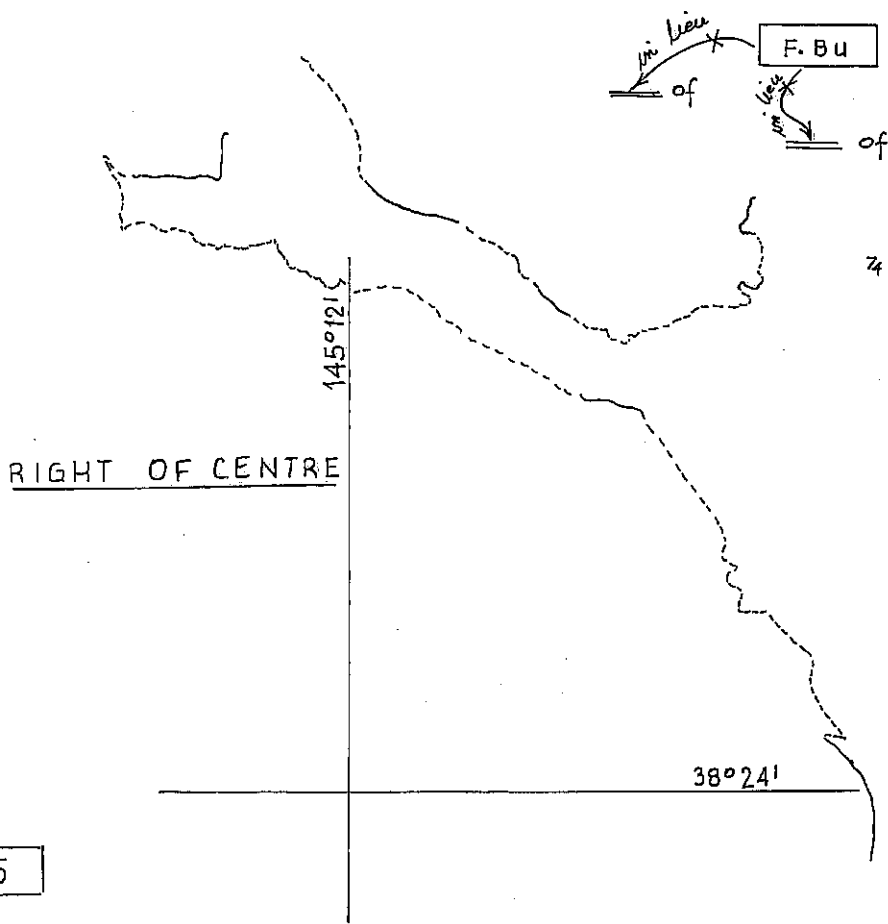

- 119
- 12
- 74
- 127
- 112
- 123
- 88
- 164
- 6
- 67
- 67
- 136
- 132

784 | 2005

176/2006

© Commonwealth of Australia 2006

F6
AUS 151

38°22'

F. BU. 10_m

here
↓
of

PLAN:
HANNS INLET

145°13'

75

9

25

79

08

26

29

62

03

26

22

03

59

here
↓
F. Bu
of

84

62

784/2005

176/2006

© Commonwealth of Australia 2006

F6

AUS 152

LEFT BELOW CENTRE

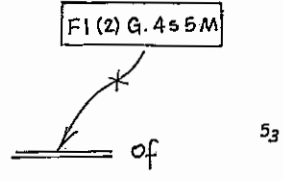
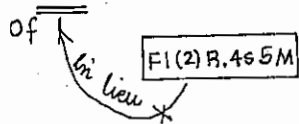
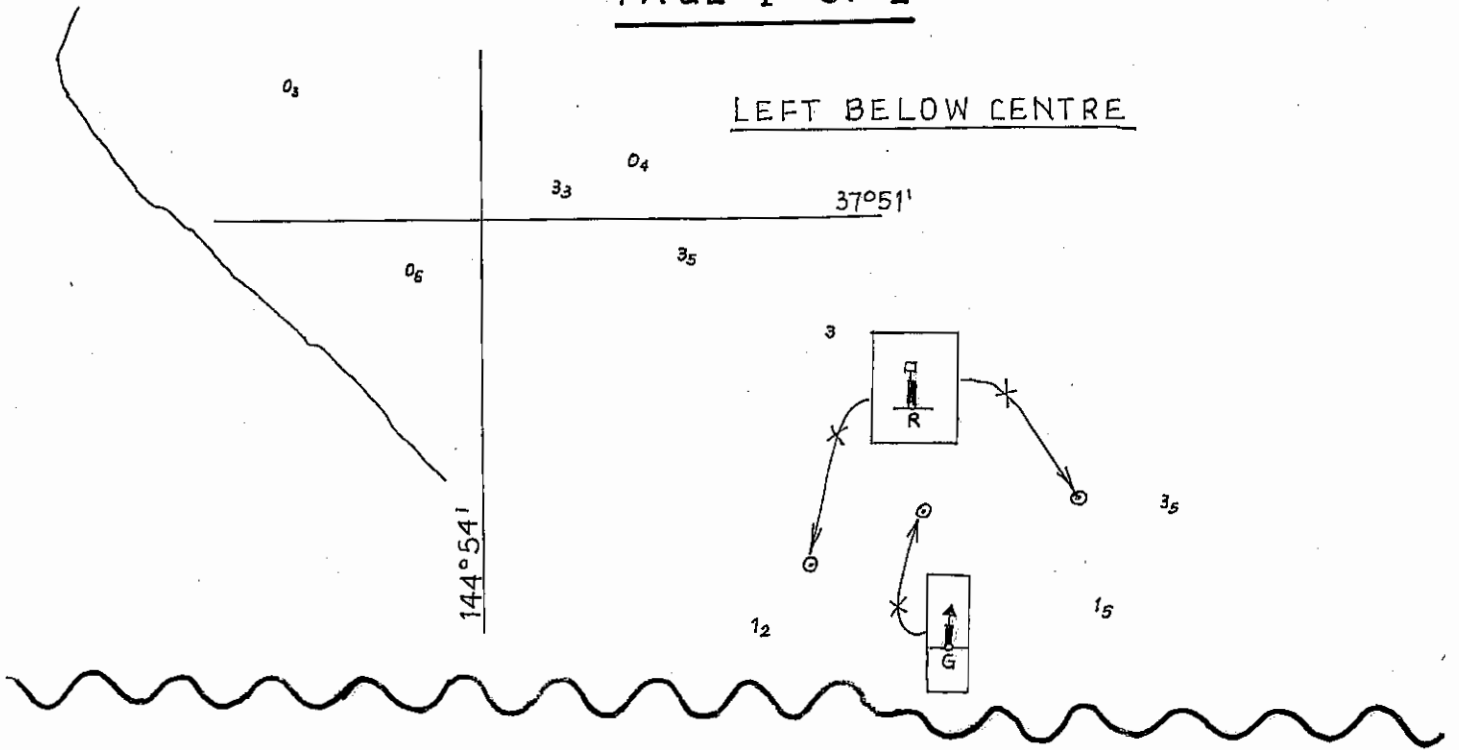

RIGHT BELOW CENTRE

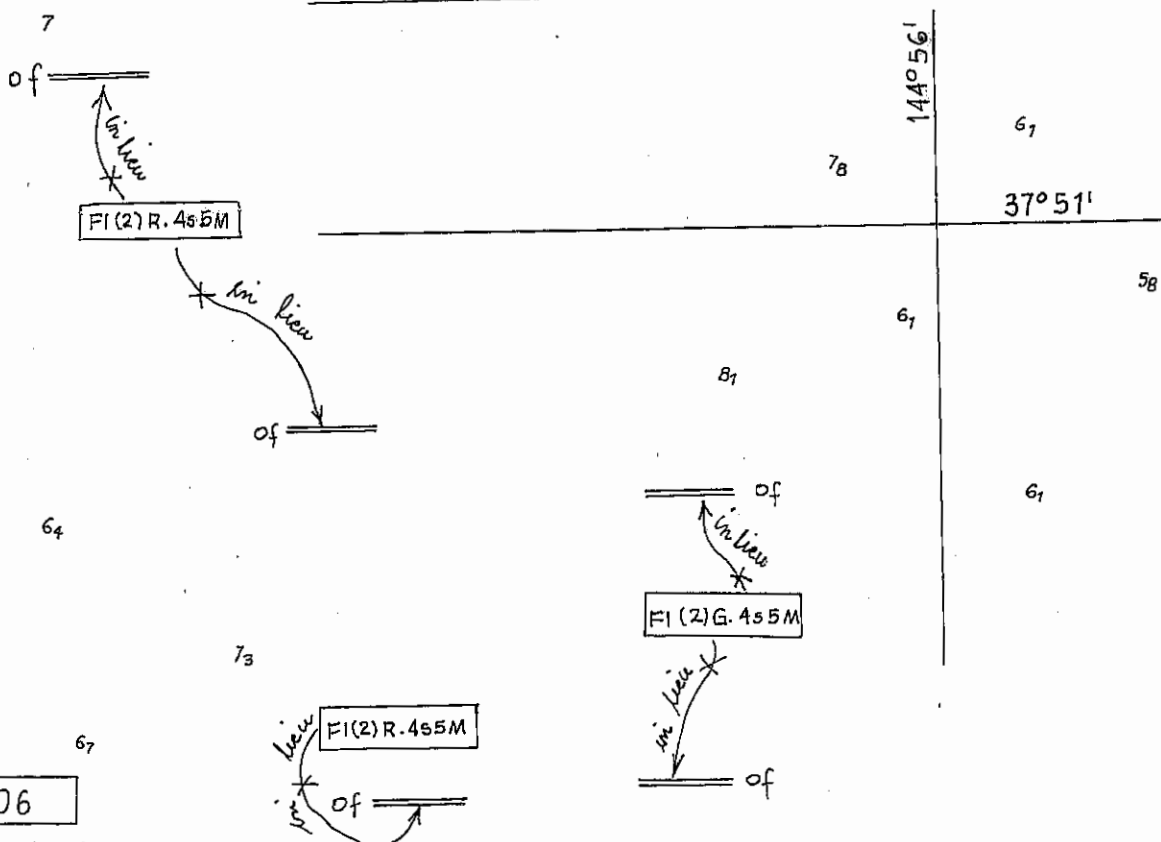

130/2006

85

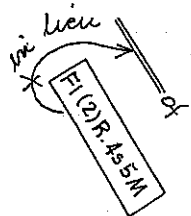

37°52'

RIGHT BELOW CENTRE

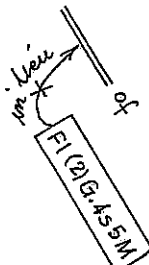
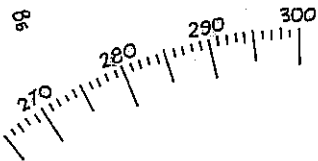

71

144°56'

52

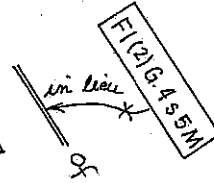
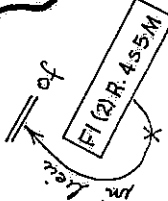
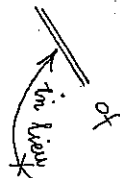

RIGHT BELOW CENTRE

144°56'

76

37°52' 43"

56'

130/2006

174,175/2006

F6

AUS 154

37° 56'

144° 56'

85/2006

174/2006

© Commonwealth of Australia 2006

F6
AUS 155

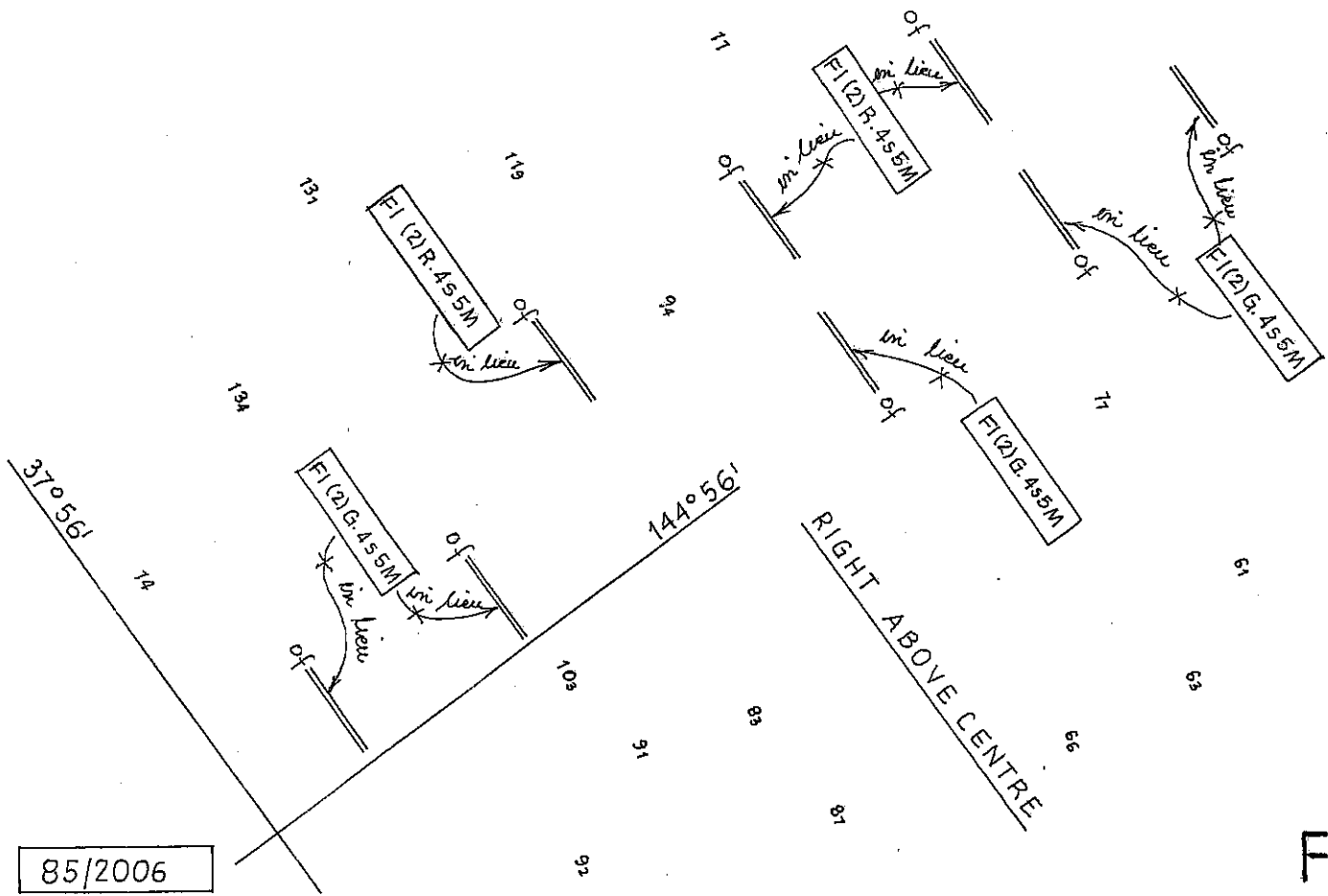

LEFT ABOVE CENTRE

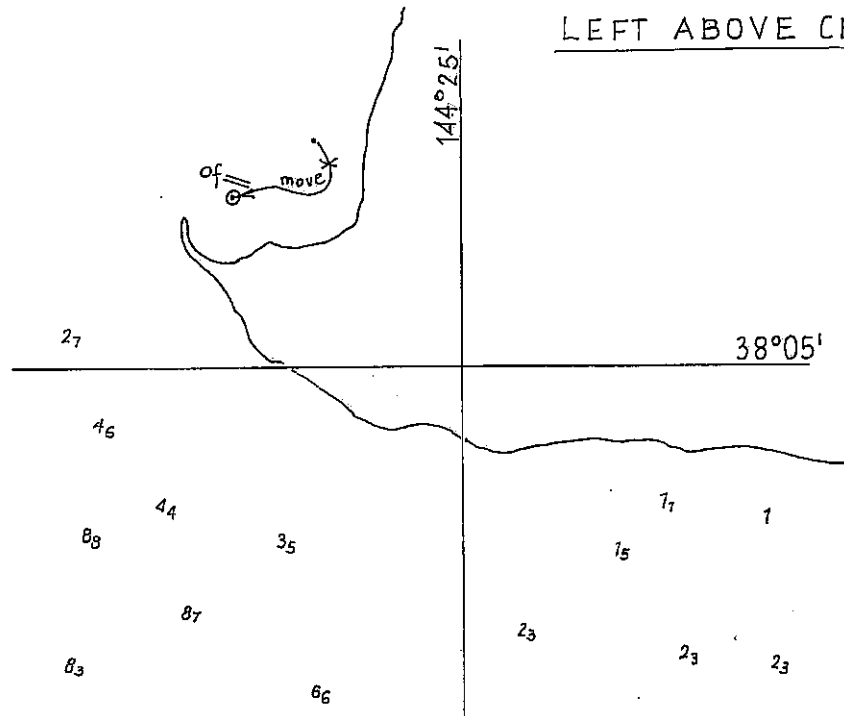

1003/2005

173/2006

© Commonwealth of Australia 2006

F6
AUS 157

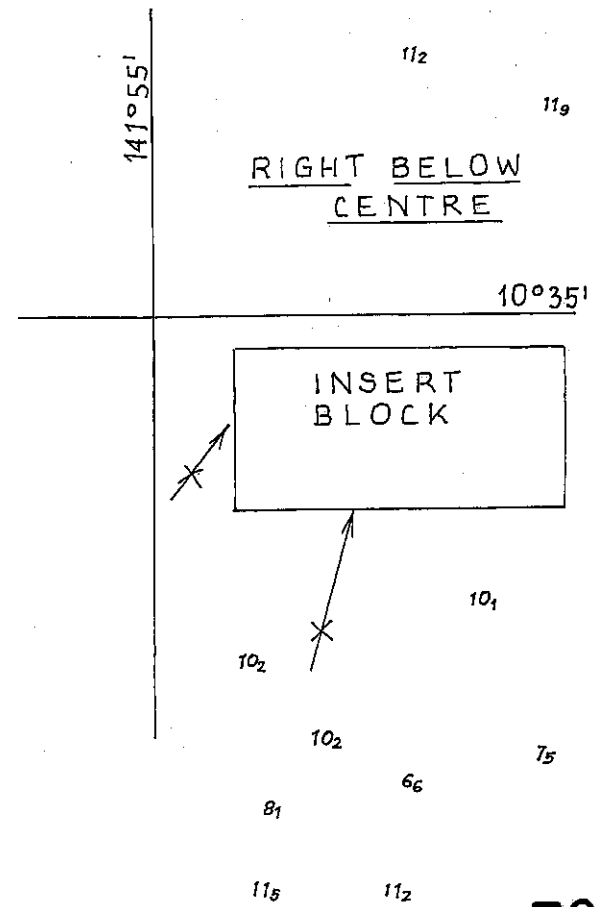
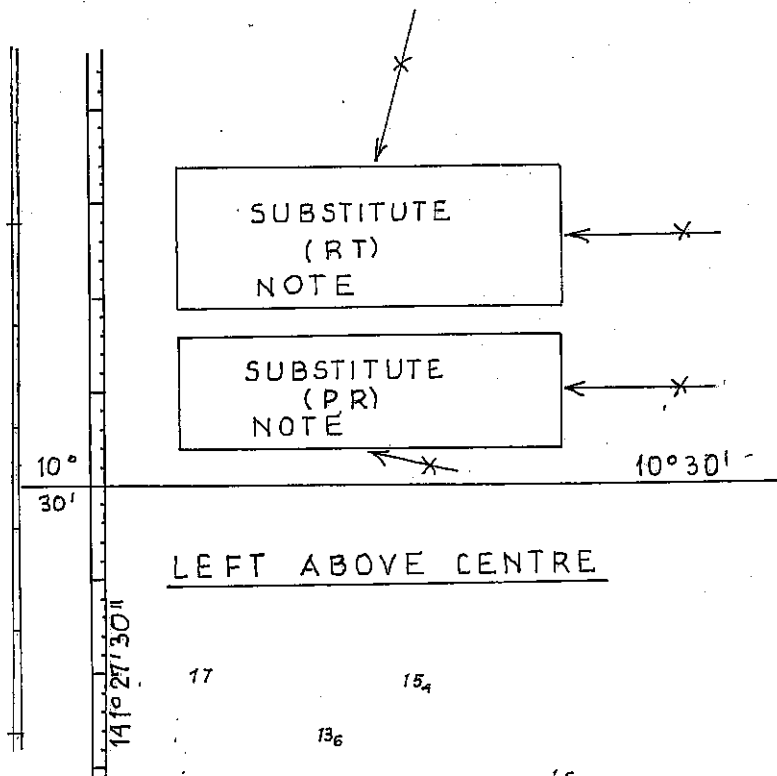

1104/2005

163,167/2006

© Commonwealth of Australia 2006

F8

AUS 296

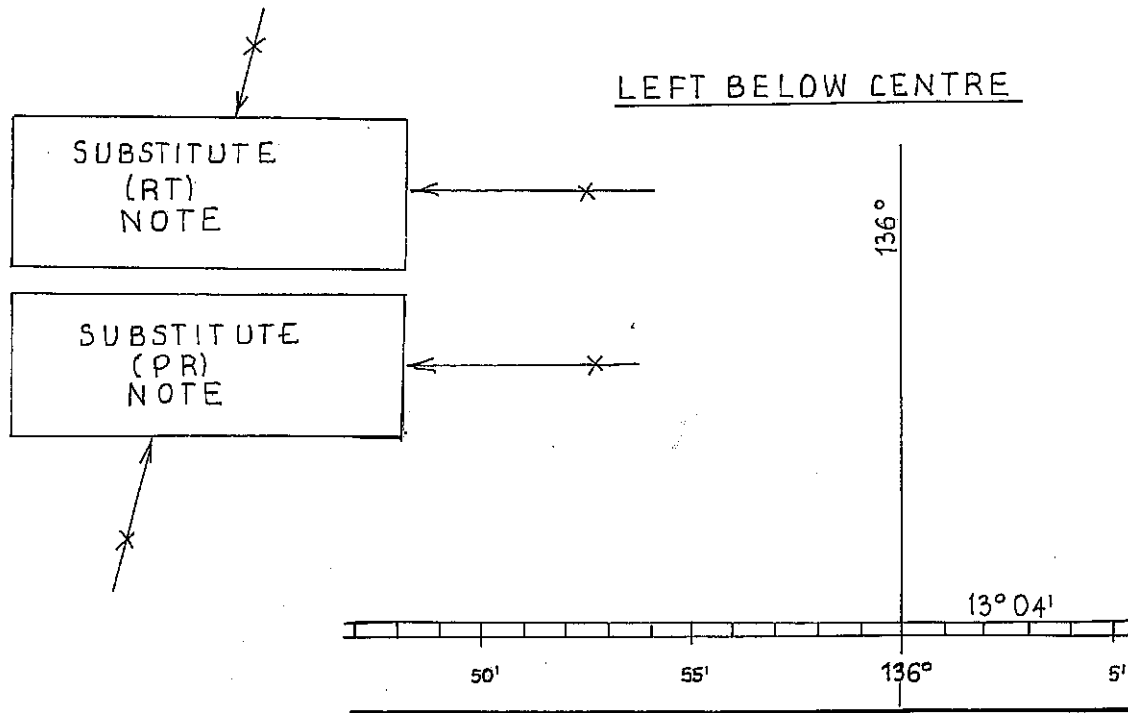

1066/2005

163/2006

© Commonwealth of Australia 2006

F2
AUS 306

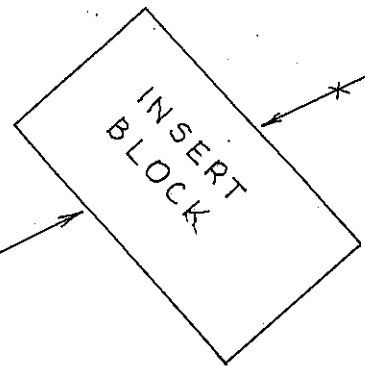

RIGHT ABOVE CENTRE

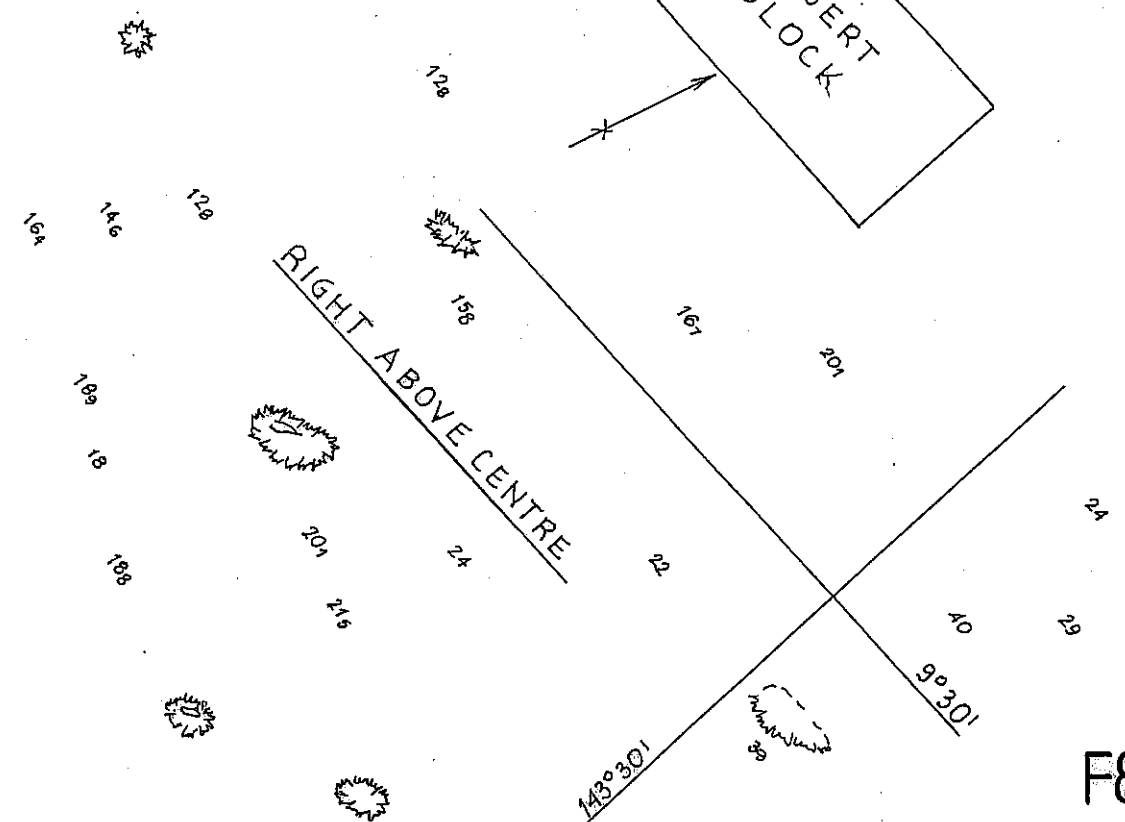
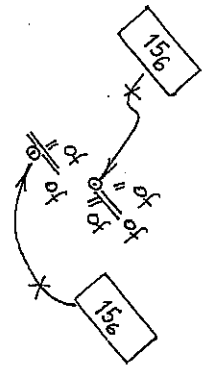

41/2006

164,165/2006

© Commonwealth of Australia 2006

F8
AUS 376

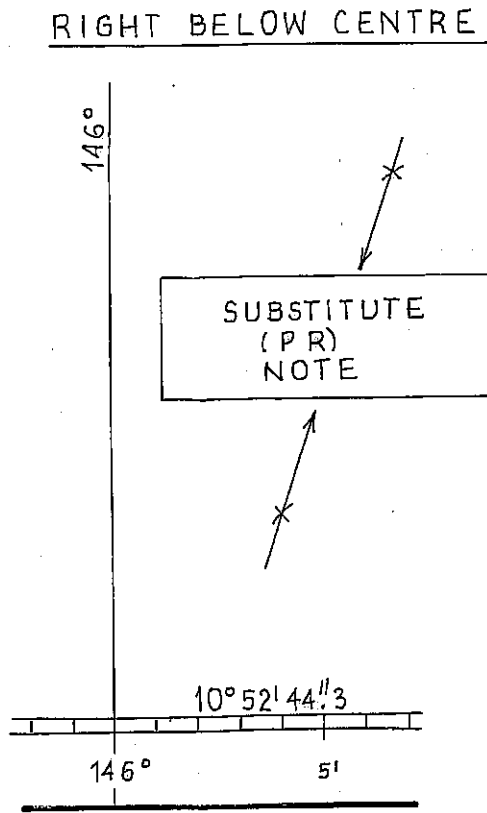
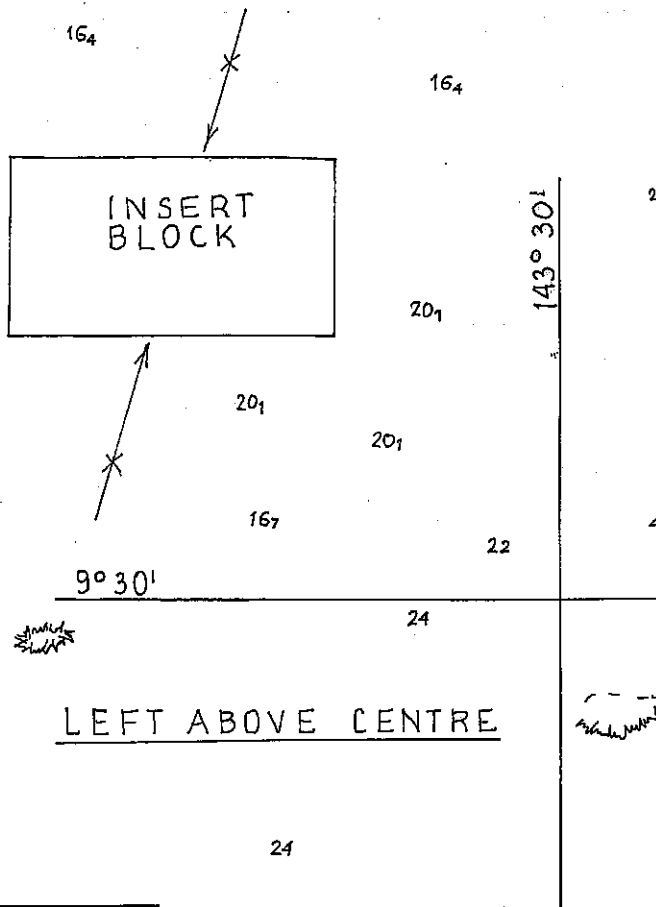

41/2006

163,165/2006

© Commonwealth of Australia 2006

F8
AUS 377

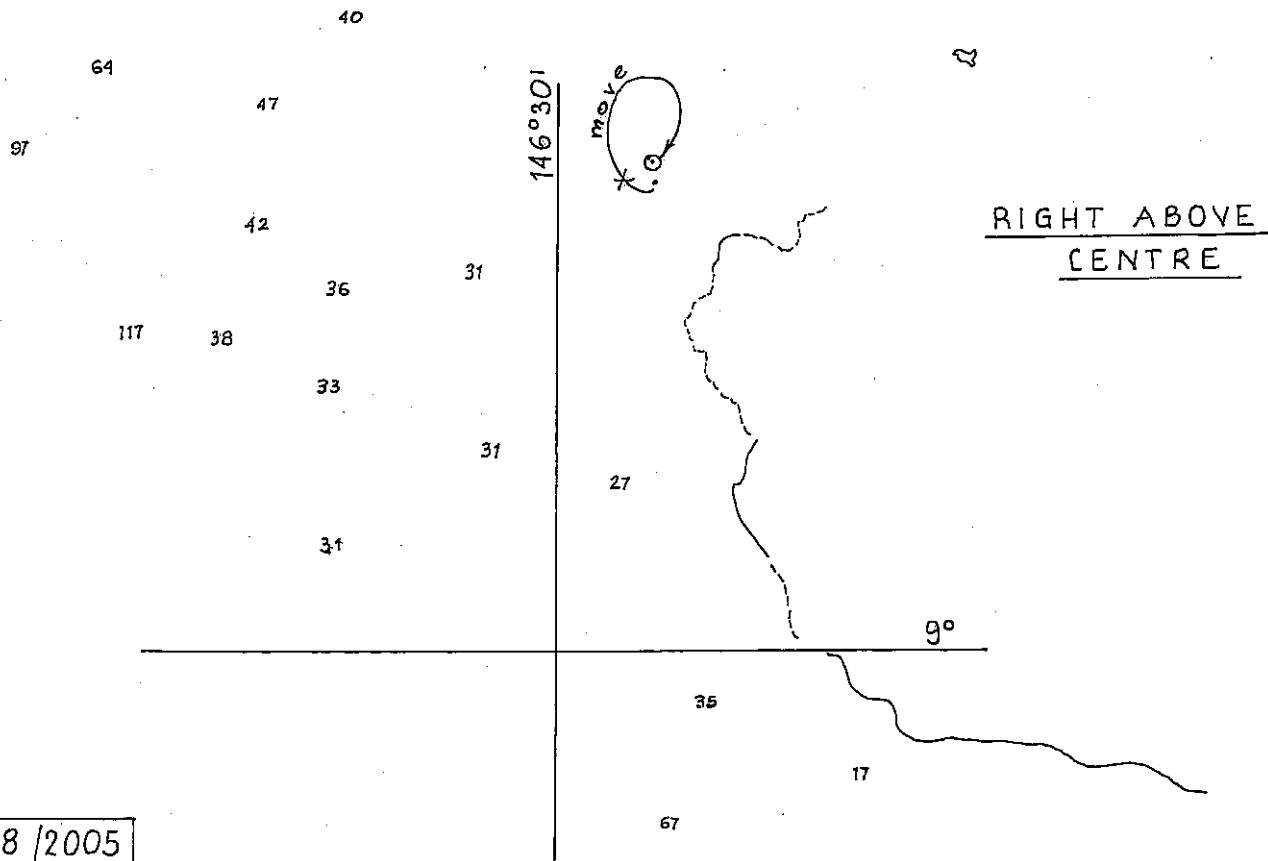

888 / 2005

166/2006

© Commonwealth of Australia 2006

F9

AUS 379

LEFT ABOVE
CENTRE

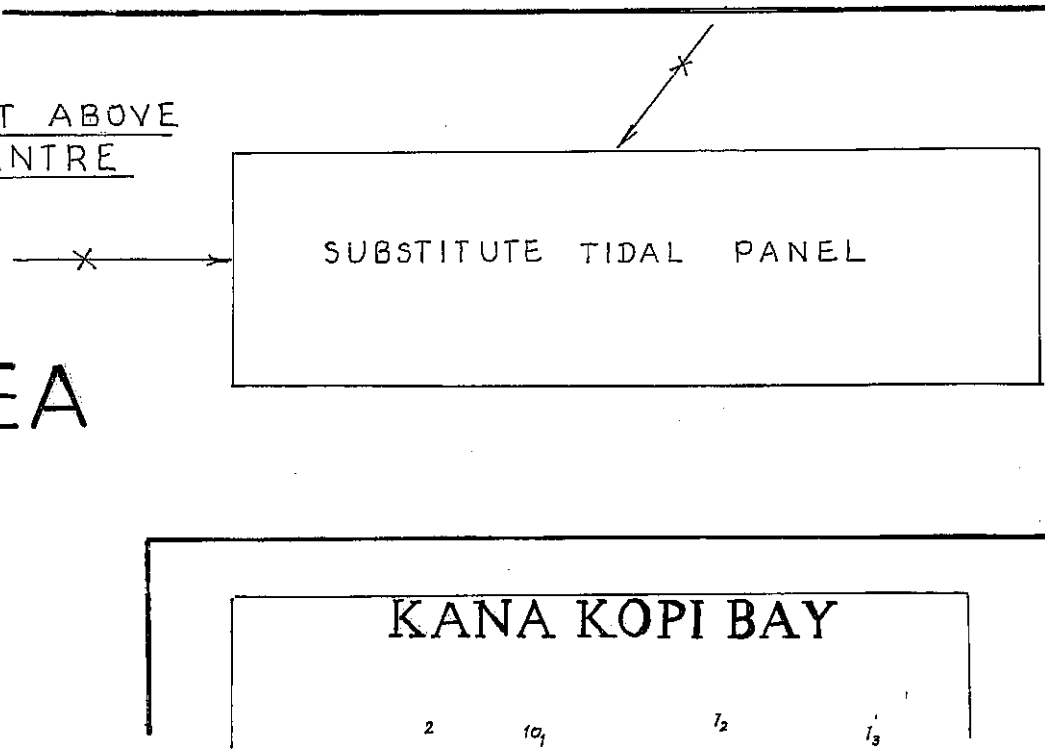

SUBSTITUTE TIDAL PANEL

UINEA

KANA KOPI BAY

2

10₁

1₂

1₃

21

1054/2005

F10

163/2006

© Commonwealth of Australia 2006

AUS 654

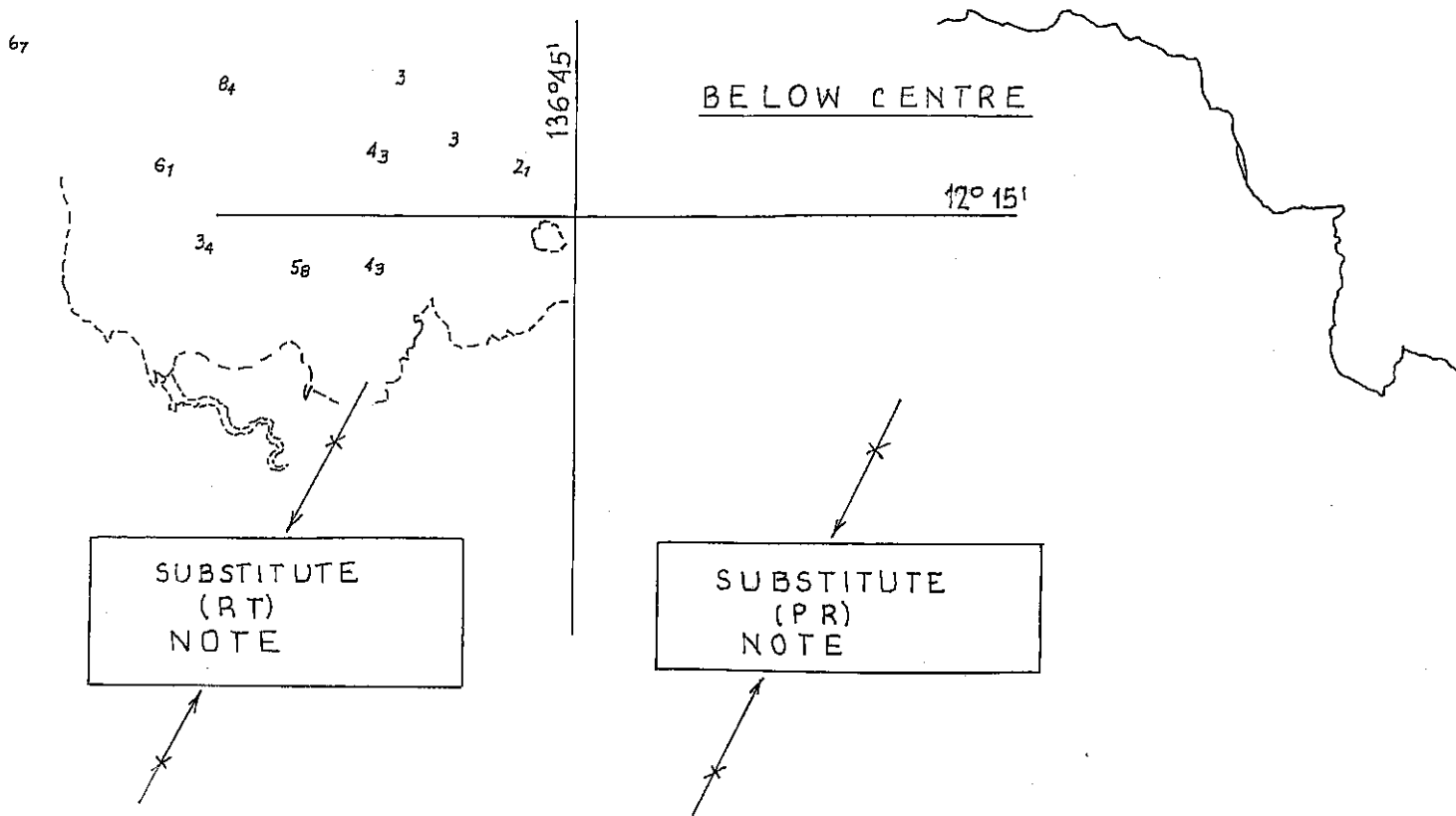

777/2005

163/2006

© Commonwealth of Australia 2006

F2
AUS 715

31

33

11

27

3

14

67

mi magenta
AIS

Q (4) Y. 65

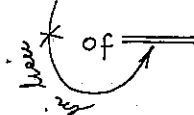

116°45'

106

11

LEFT BELOW CENTRE

20°30'

134

286/2005

170/2006

© Commonwealth of Australia 2006

F3

AUS 741

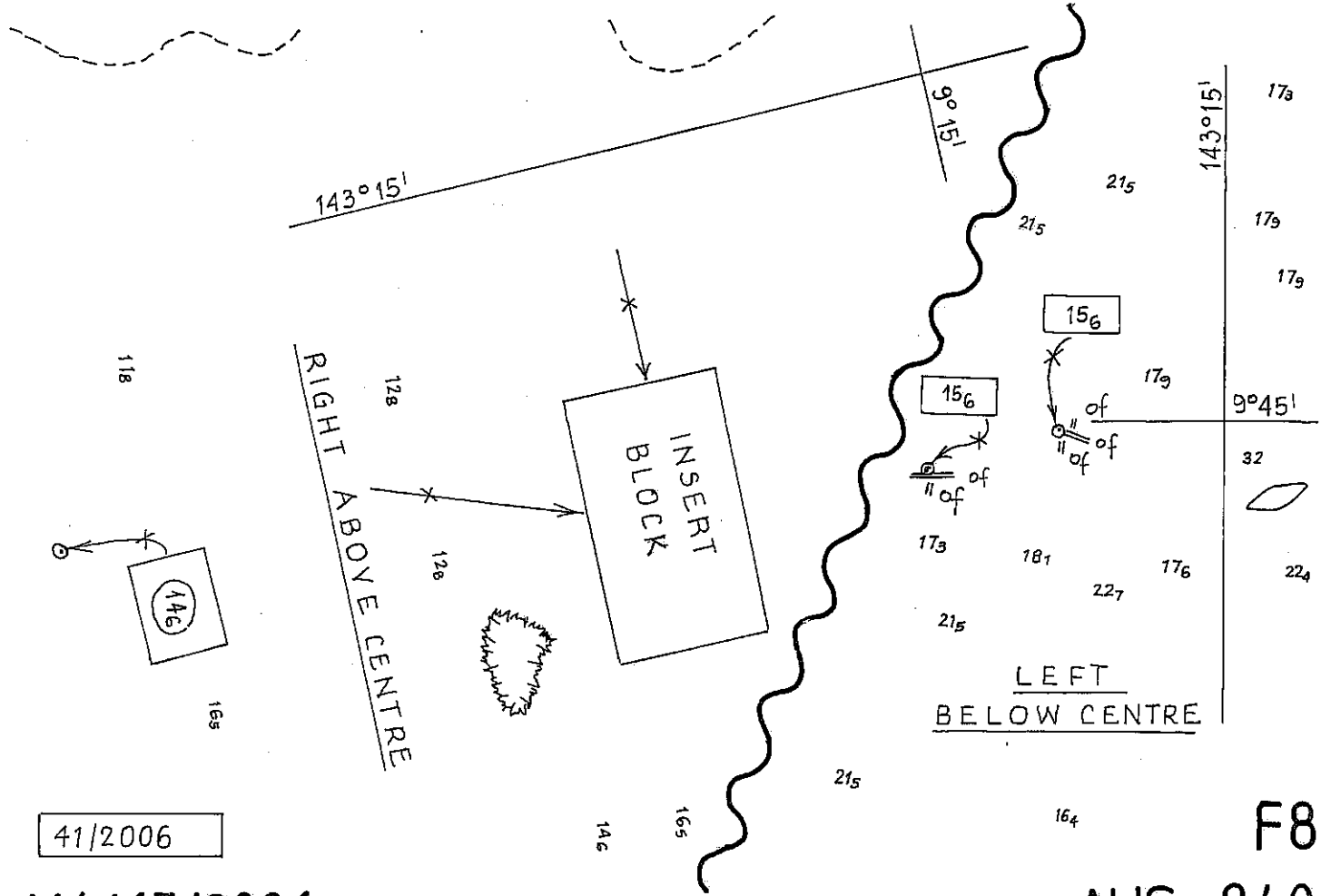

41/2006

164,165/2006

© Commonwealth of Australia 2006

F8
AUS 840