

108

11

11

108

SUBSTITUTE NOTE

RIGHT BELOW CENTRE

141° 58' 12"

10° 37'

300/2002

3921/2002

© Commonwealth of Australia 2002

AUS 289

F8

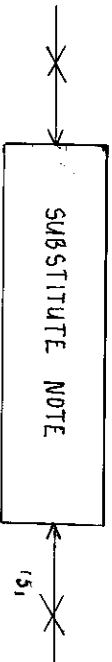

10° 30'

142

151

16

145

LEFT ABOVE CENTRE

141° 35'

300/2002

3921/2002

© Commonwealth of Australia 2002

AUS 296

F8

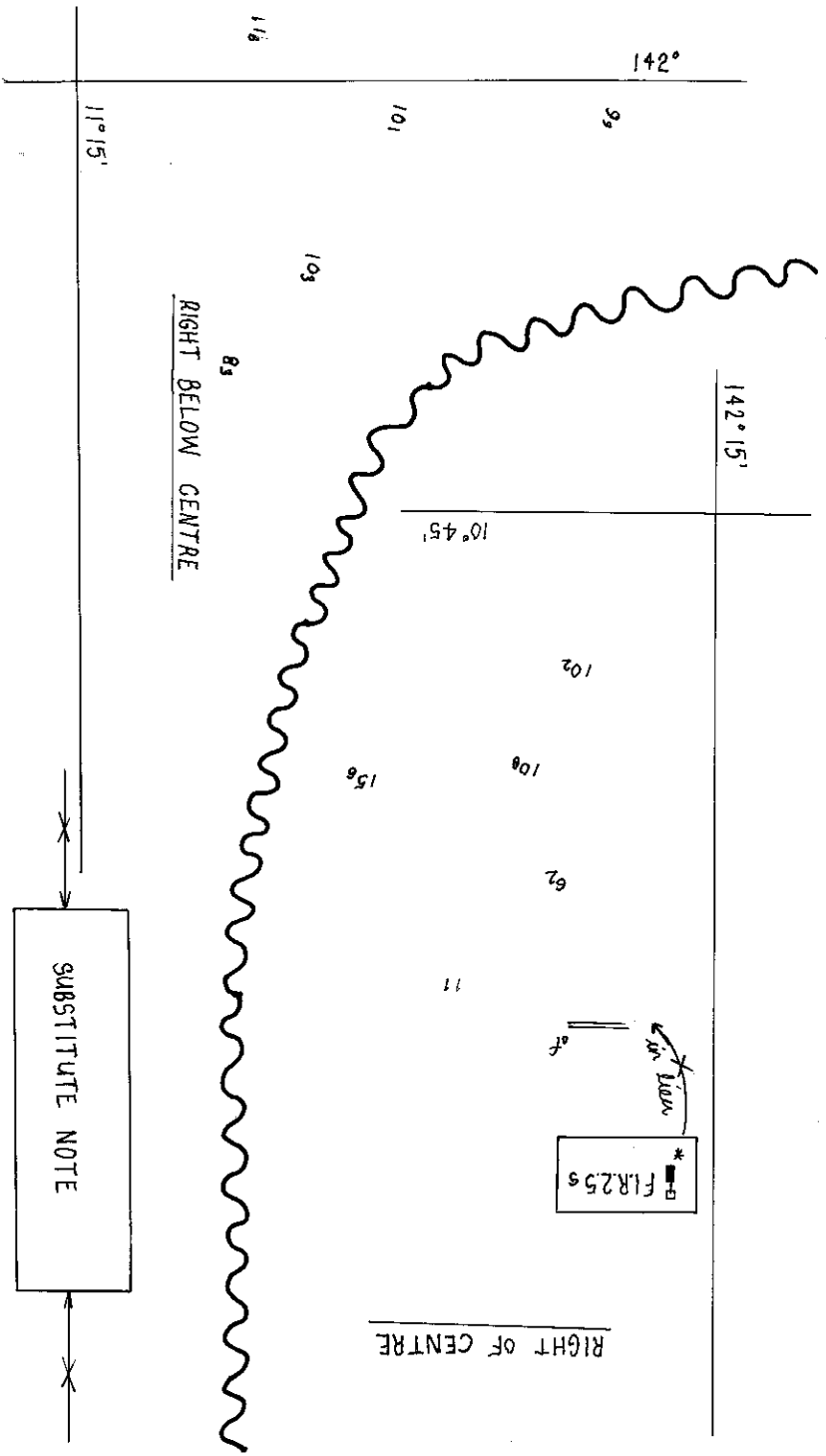

300/2002

392, 396/2002

© Commonwealth of Australia 2002

F8

AUS 700

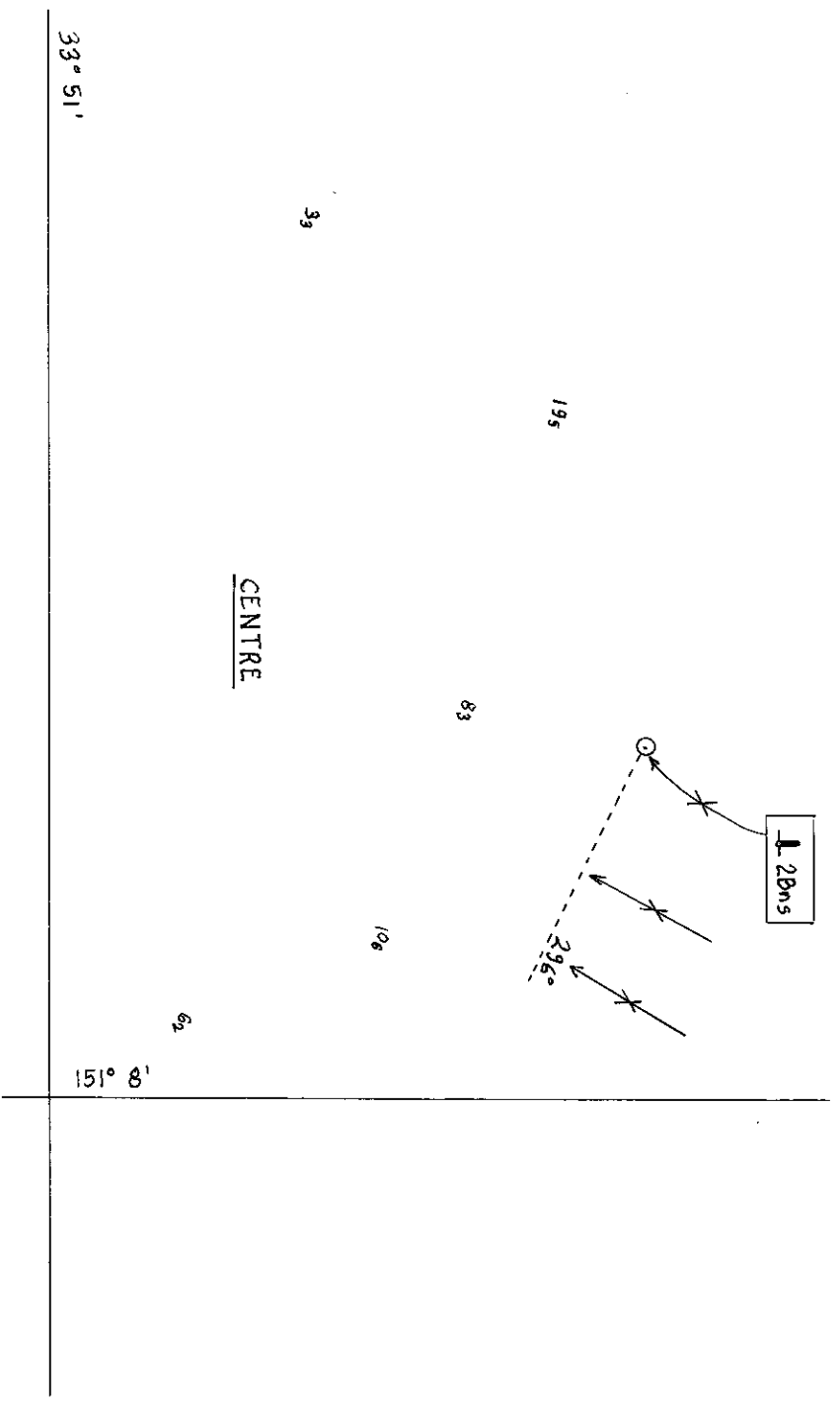

39/2002

393/2002

© Commonwealth of Australia 2002

F7

AUS 203

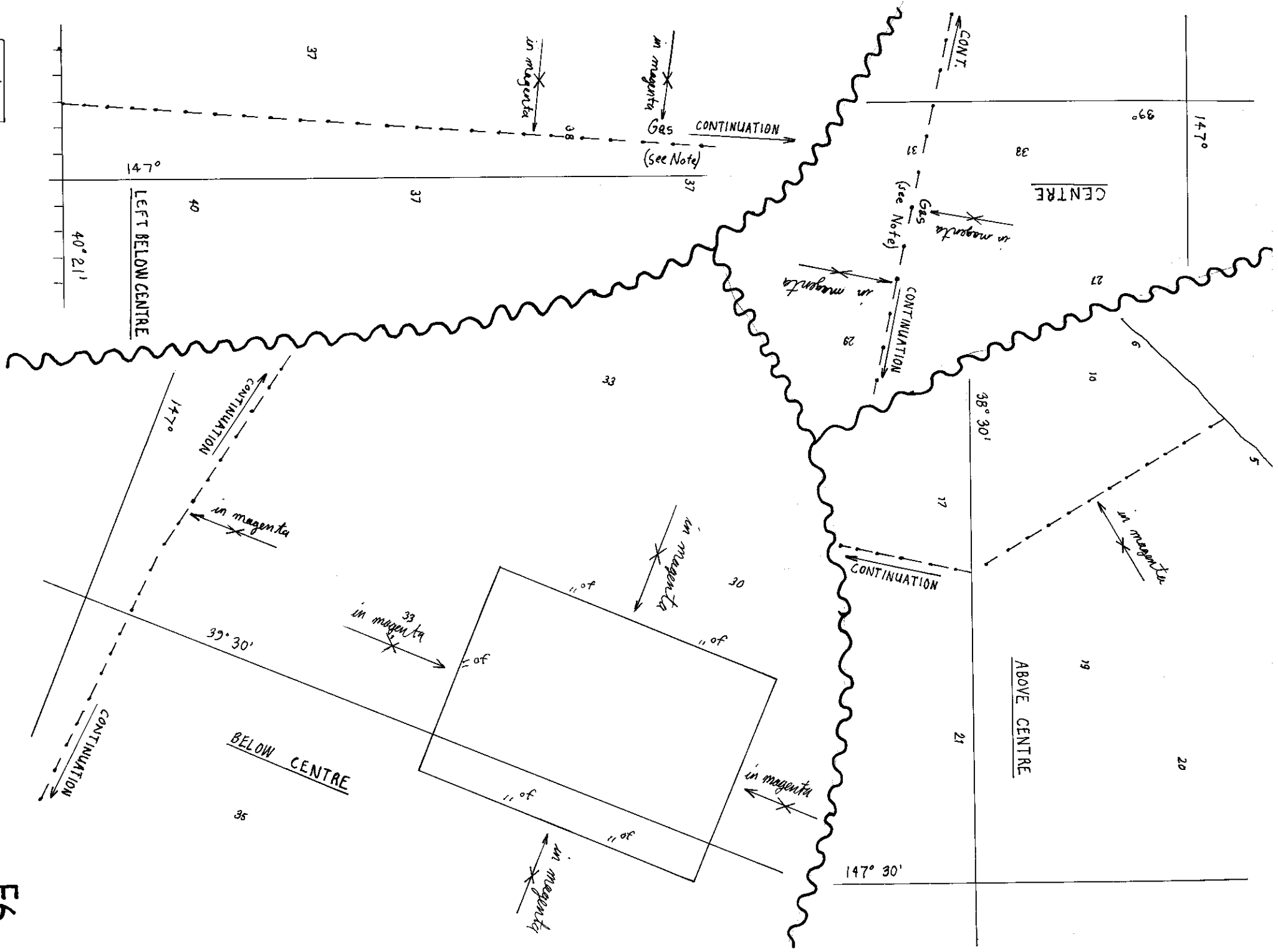

368/2002

392,401/2002

© Commonwealth of Australia 2002

AUS 357

F6

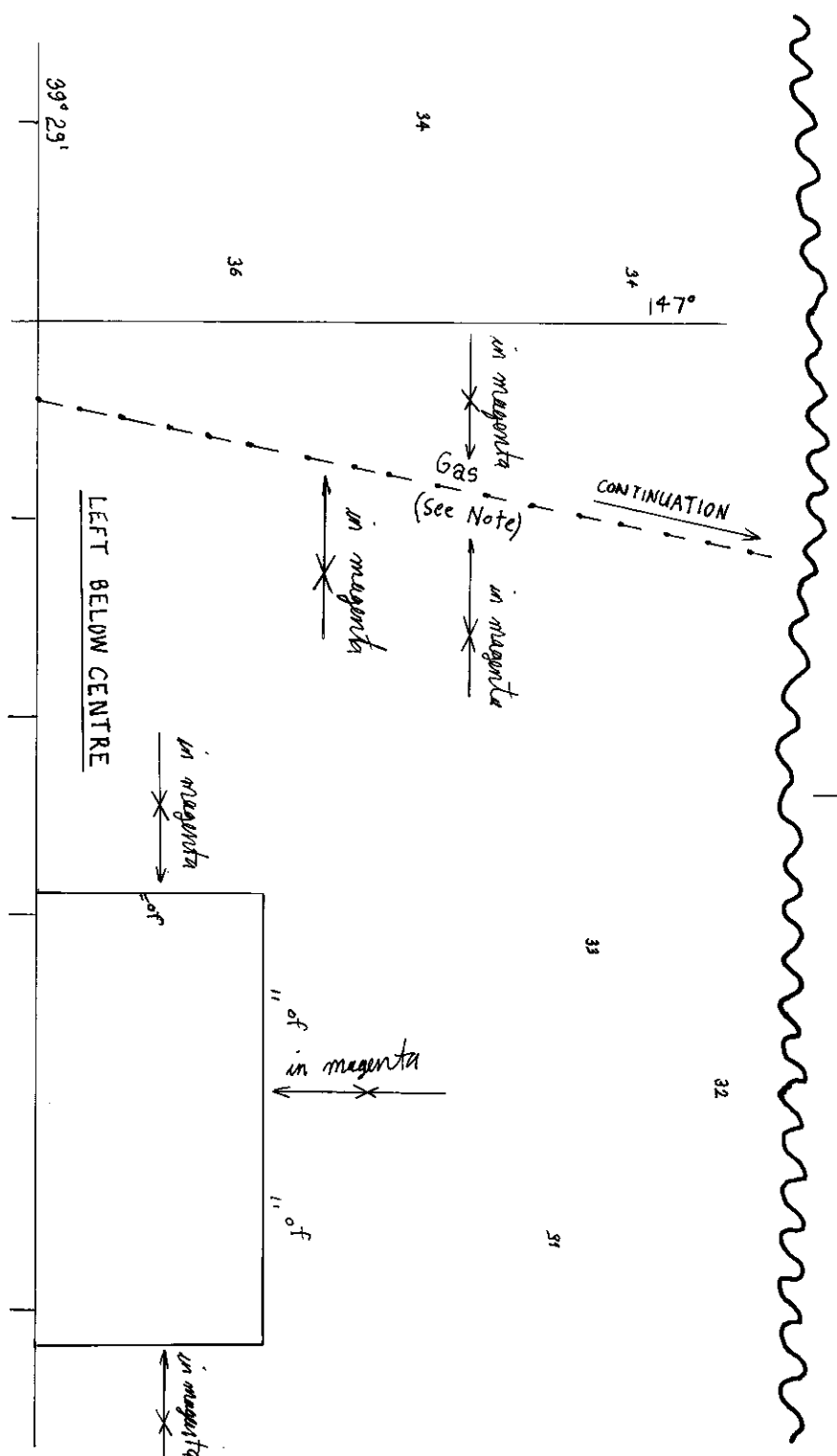
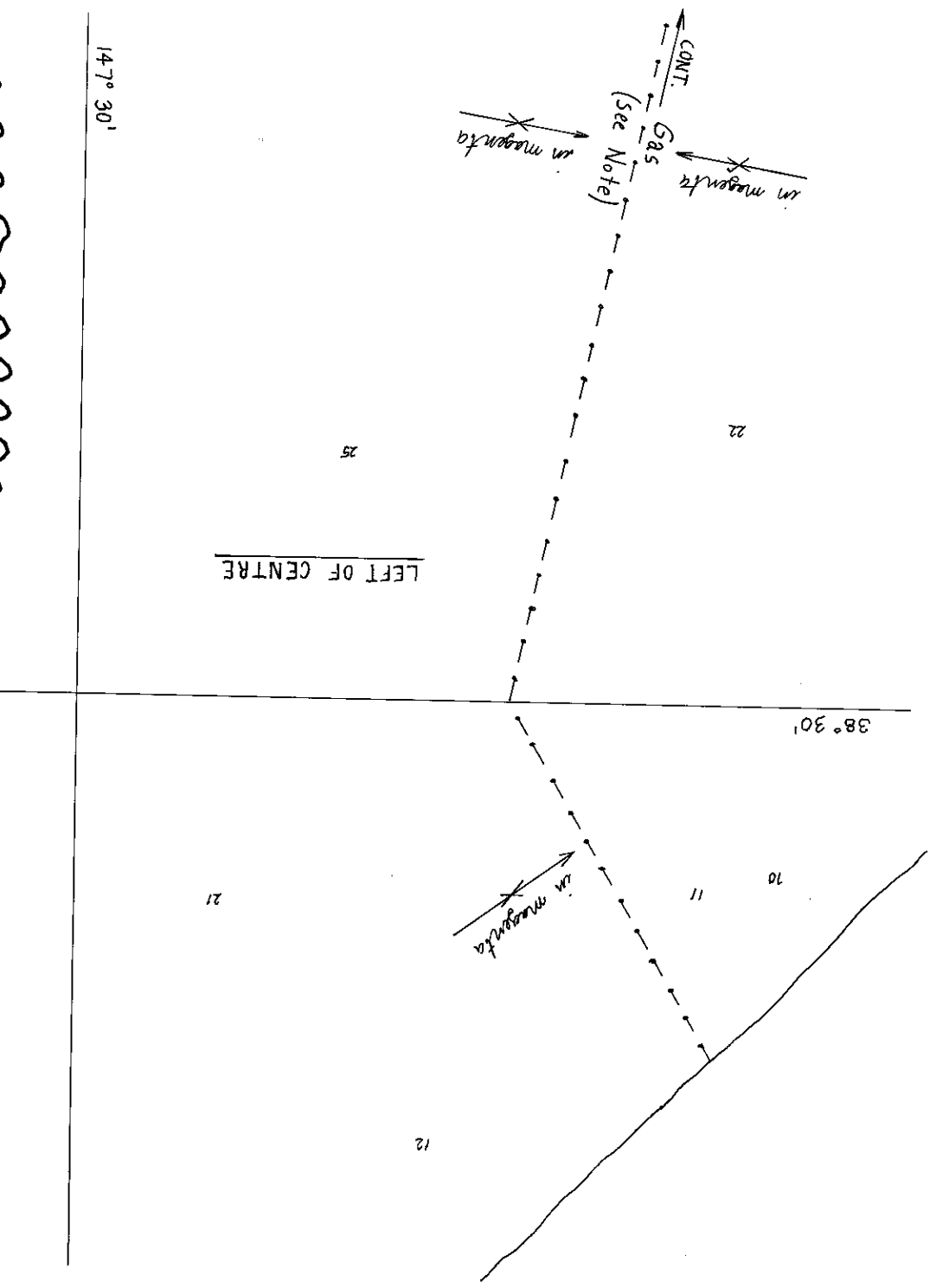
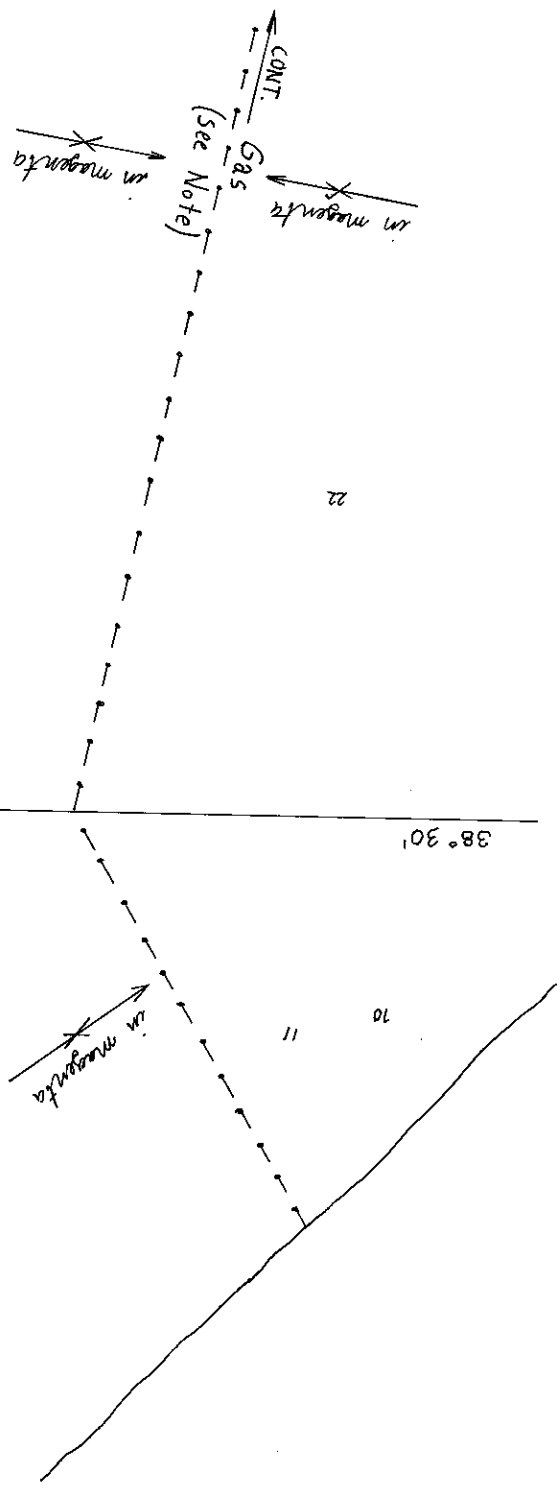

368/2002

392,401/2002

© Commonwealth of Australia 2002

F6

AUS 357A

RIGHT OF CENTRE

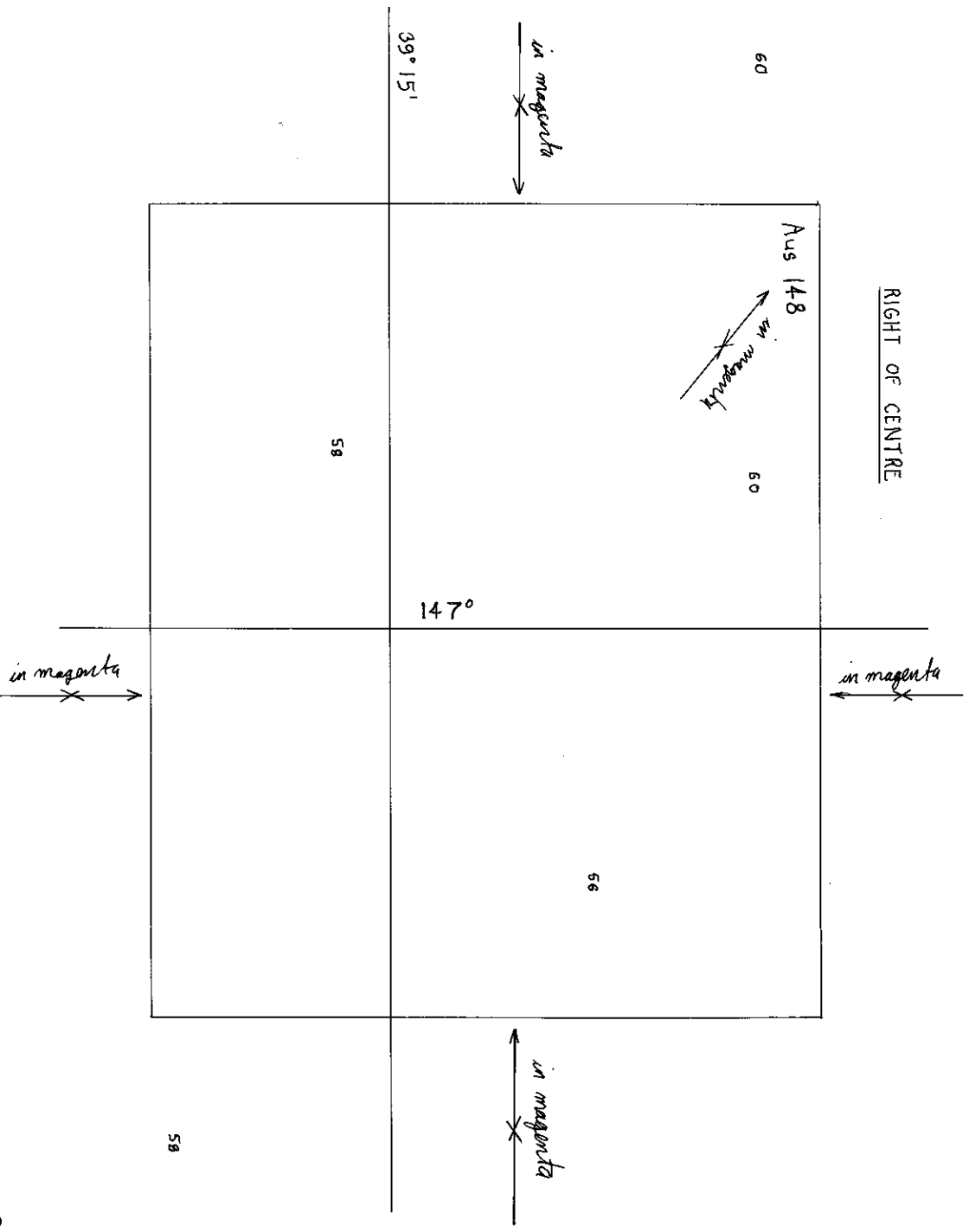

RIGHT BELOW CENTRE

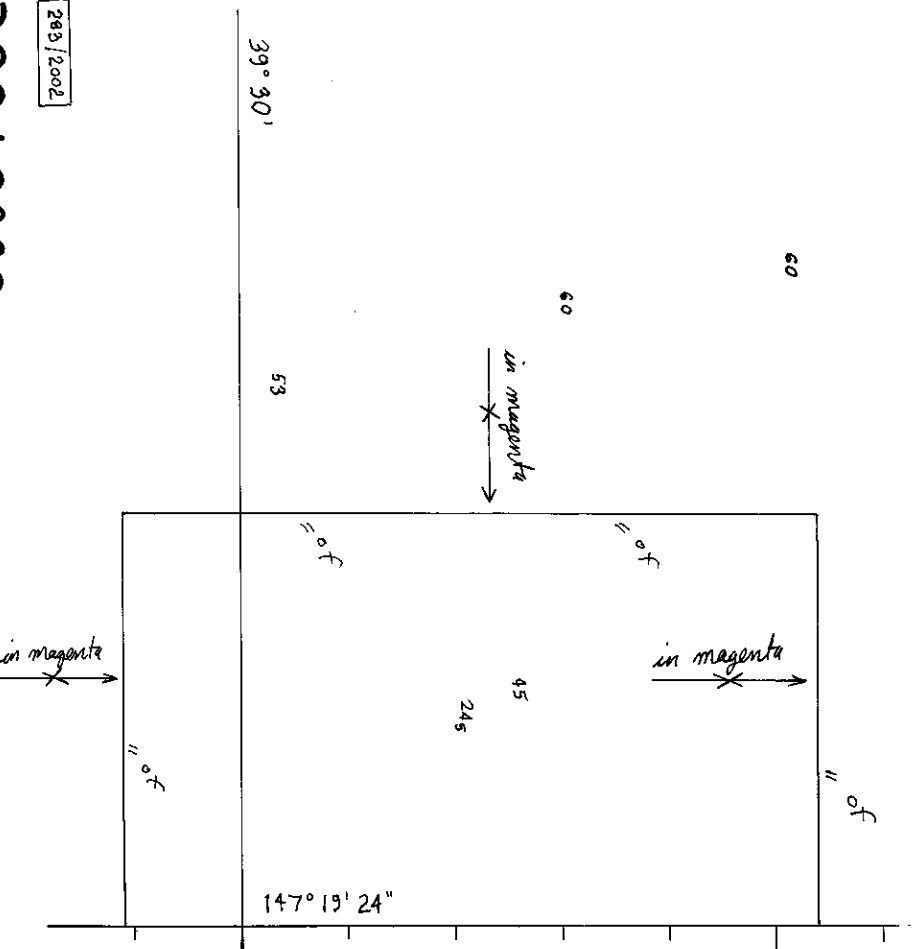

293/2002

3921/2002

© Commonwealth of Australia 2002

AUS 802

F6

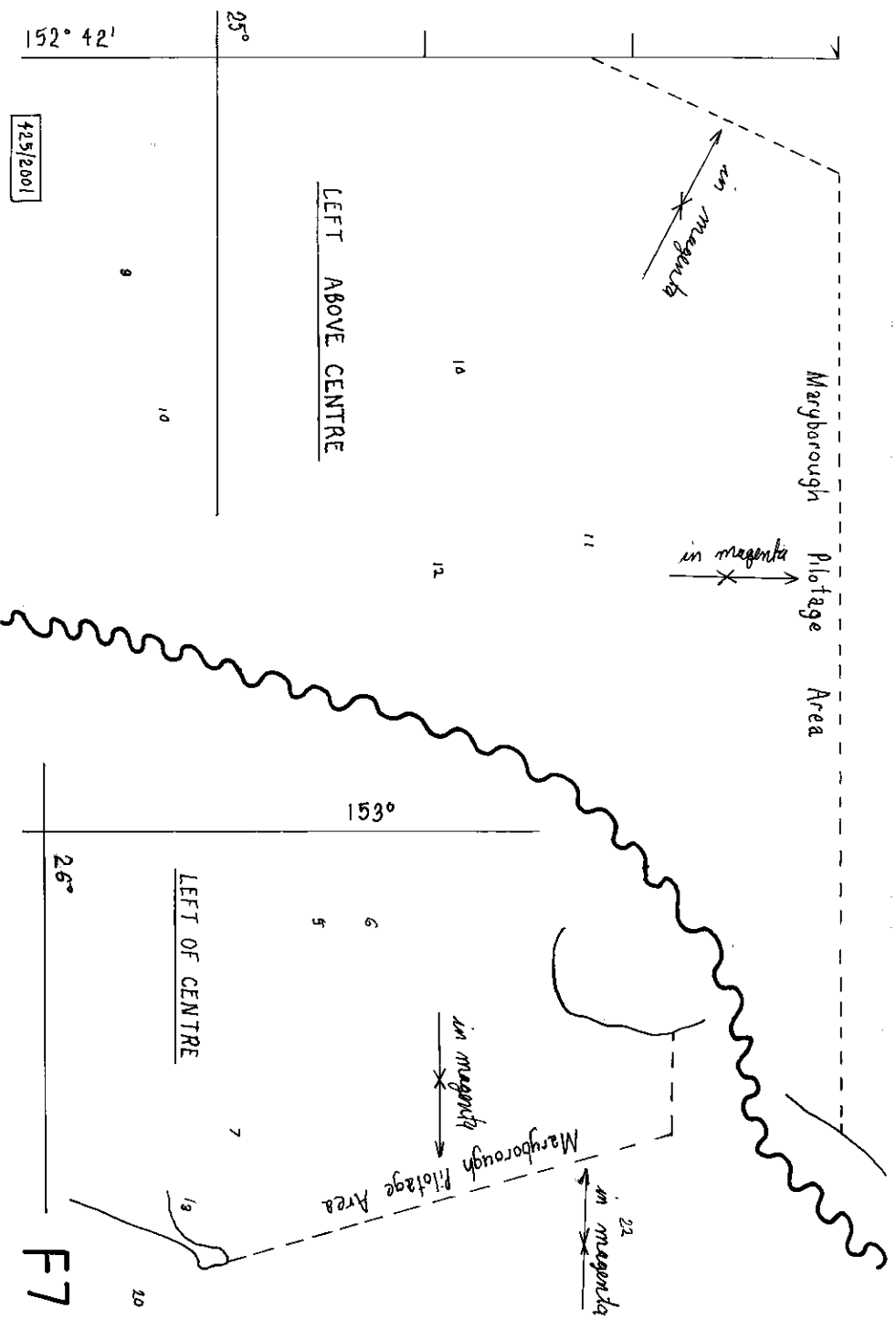

425/2001

394/2002

© Commonwealth of Australia 2002

AUS 365

F7

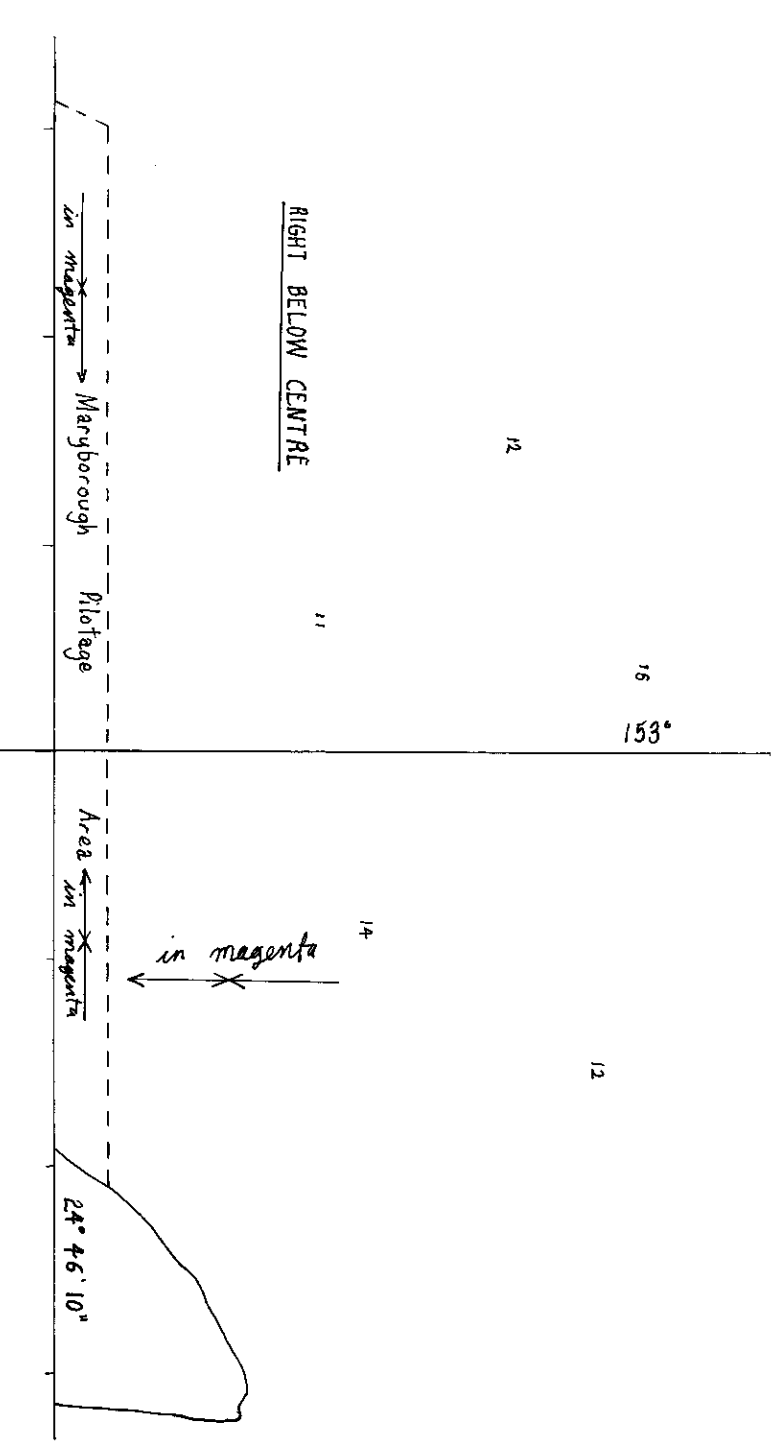

104/2002

394/2002

© Commonwealth of Australia 2002

AUS 366

F7

127/2002

396/2002

© Commonwealth of Australia 2002

AUS 292

F 8

10° 40'

142° 15'

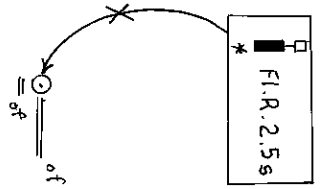

5,

7

6,

LEFT OF CENTRE

9,

10° 40'

142° 15'

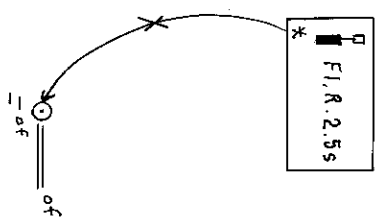

5,

10,

10,

RIGHT ABOVE CENTRE

11

695/2001

396/2002

© Commonwealth of Australia 2002

AUS 294

F 8

51

9°



LEFT OF CENTRE

149° 30'

432

488

501

F9

233/2002

3971/2002

© Commonwealth of Australia 2002

AUS 384

40

21

9°

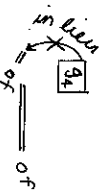

21

24

RIGHT BELOW CENTRE

27

149° 34'

98/2002

3971/2002

© Commonwealth of Australia 2002

F9

AUS 385

9°



35

80

88

80

LEFT OF CENTRE

149° 30'

293/2002

57

F9

3971/2002

© Commonwealth of Australia 2002

AUS 519

31

25

9°



53

RIGHT OF CENTRE

21

149° 30'

34

423/2001

F9

3971/2002

© Commonwealth of Australia 2002

AUS 520

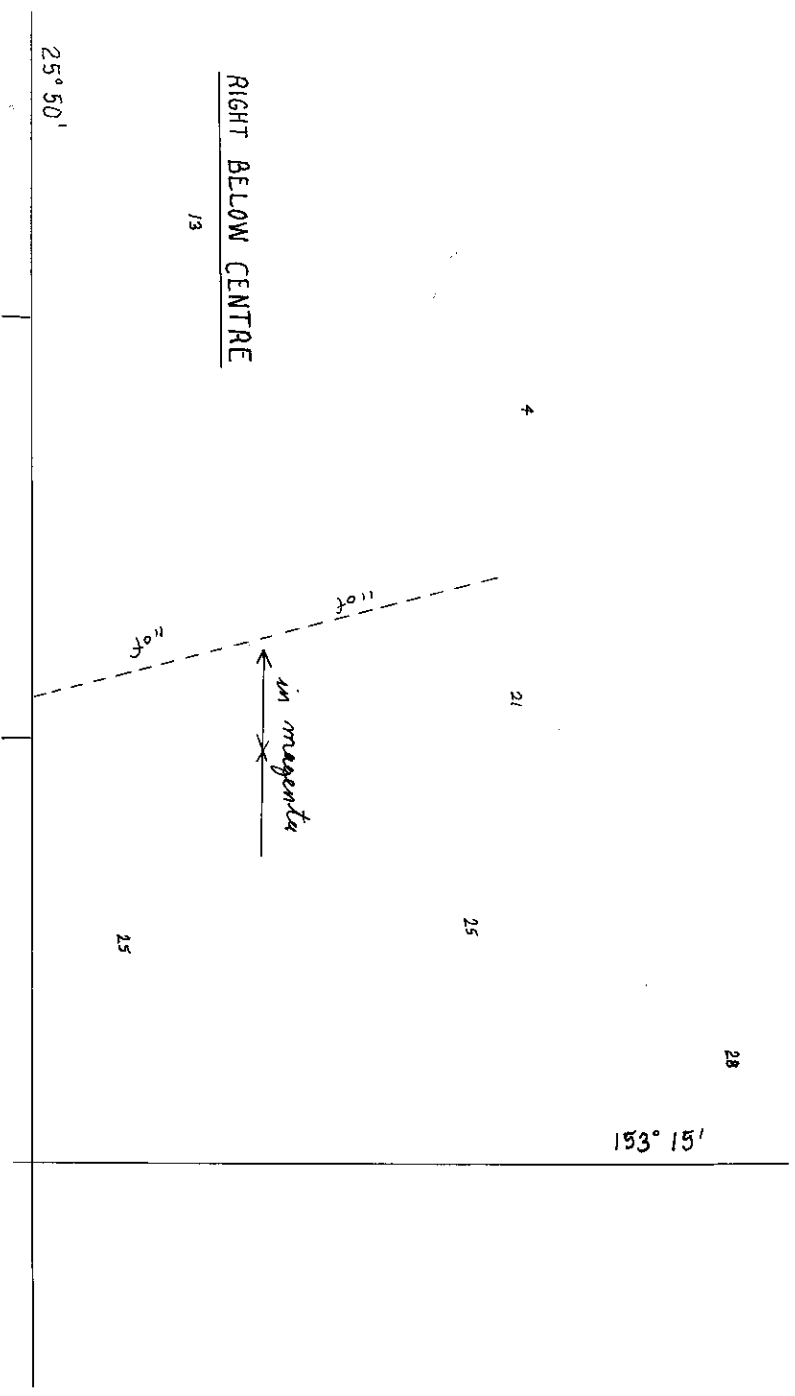

269/2002

394/2002

© Commonwealth of Australia 2002

AUS 817

F7

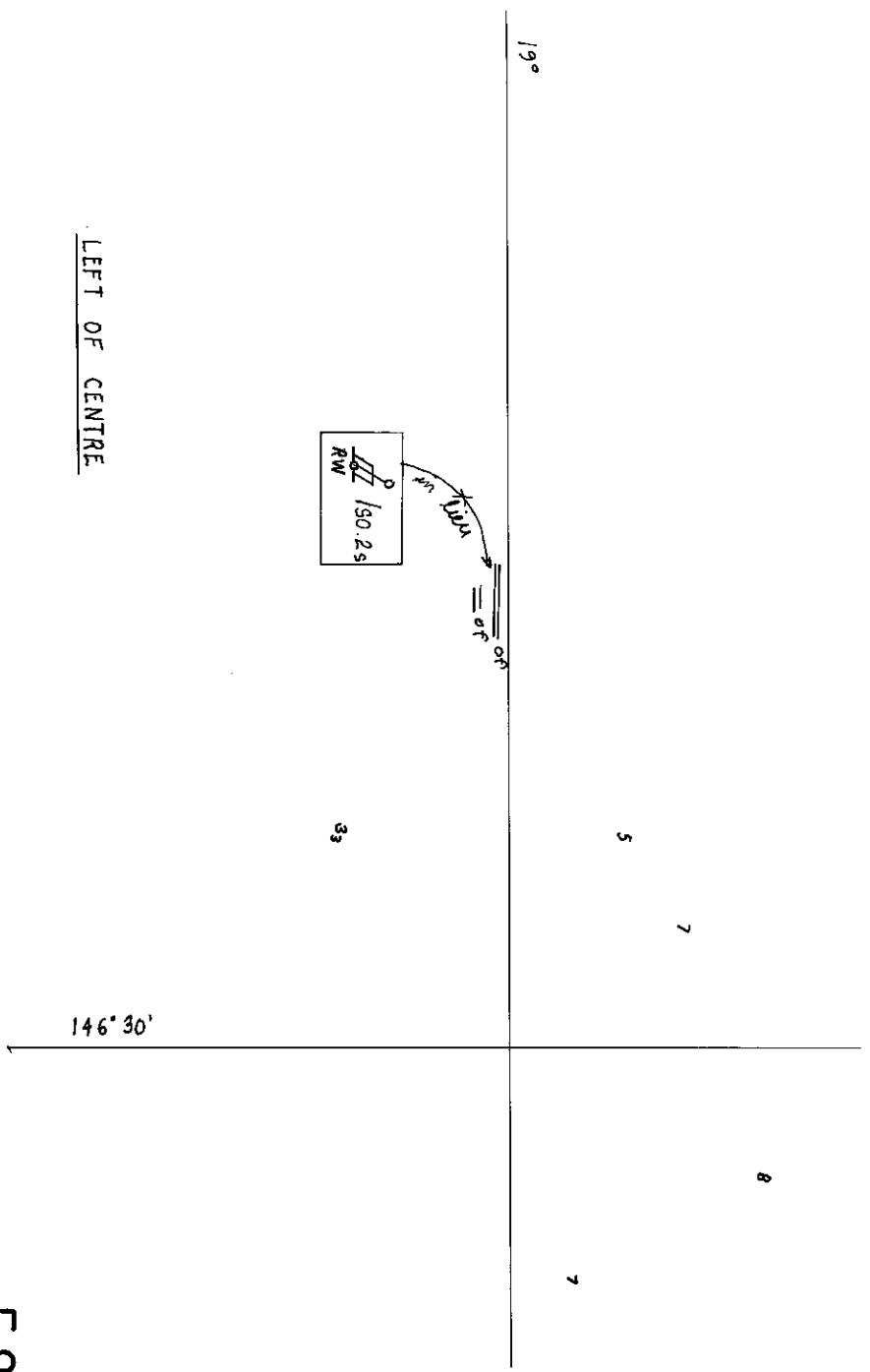

42/2002

395/2002

© Commonwealth of Australia 2002

AUS 827

F8

32°

11g

10g

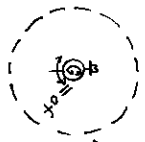

in magnetika

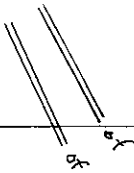

16g

115° 42'

11g

RIGHT BELOW CENTRE

278/2002

398/2002

© Commonwealth of Australia 2002

AUS 112

F 4

33°



15g



16g



maka

13g



maka

12g

12

RIGHT ABOVE CENTRE

12g

137° 45'



male

364/2002

399/2002

© Commonwealth of Australia 2002

AUS 778

F 5

PLAN: PORT BONYTHON

33° 01' 31"



16a

20g



137° 46'



20g

33°

7g

LEFT BELOW CENTRE

10g

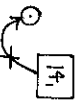
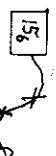
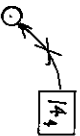

14a

18a

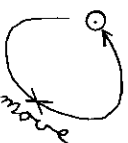

137° 40'

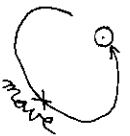

365/2002

3991/2002

©Commonwealth of Australia 2002

F5

AUS 136

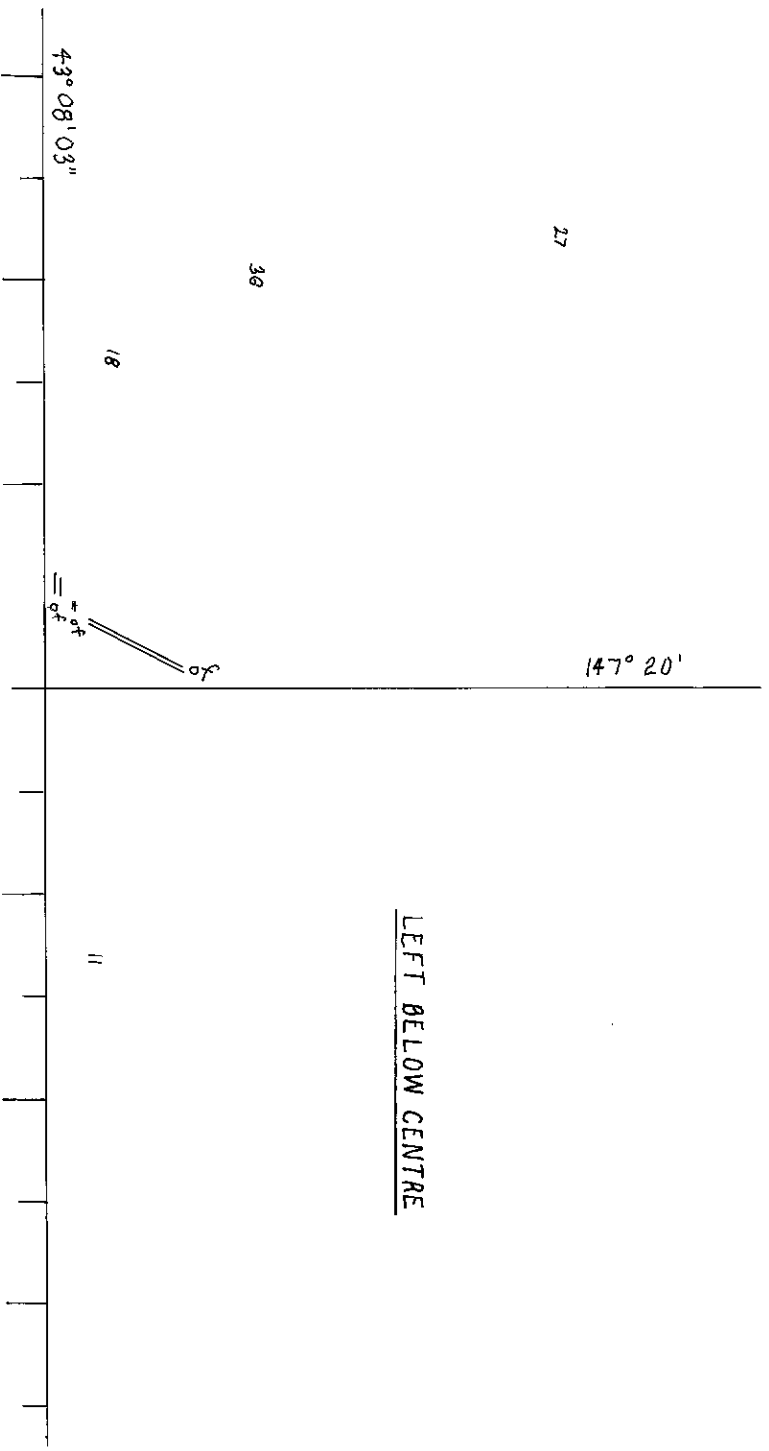

LEFT BELOW CENTRE

306/2002

400/2002

© Commonwealth of Australia 2002

F 6
AUS 171

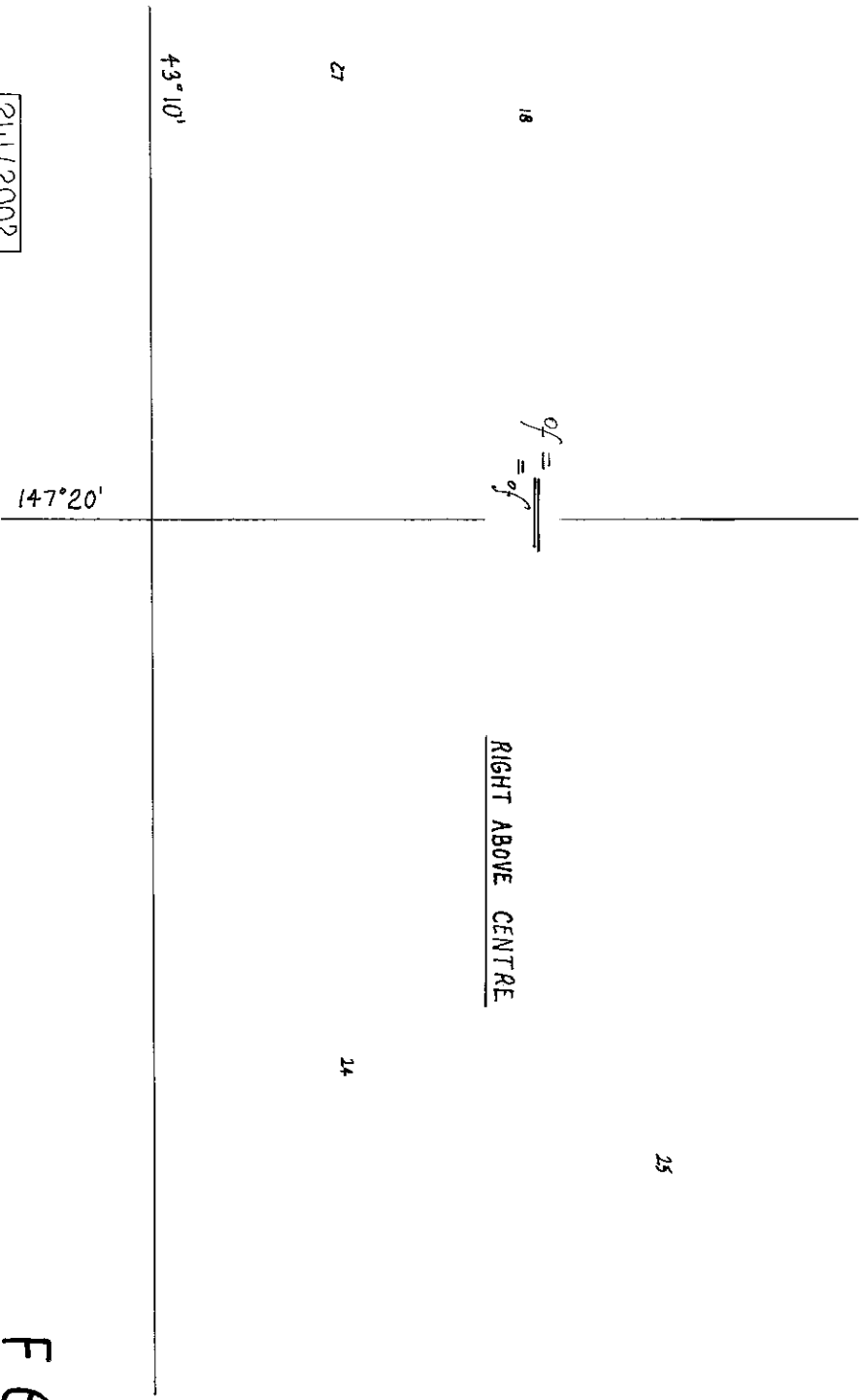

RIGHT ABOVE CENTRE

241/2002

400/2002

© Commonwealth of Australia 2002

F 6
AUS 173

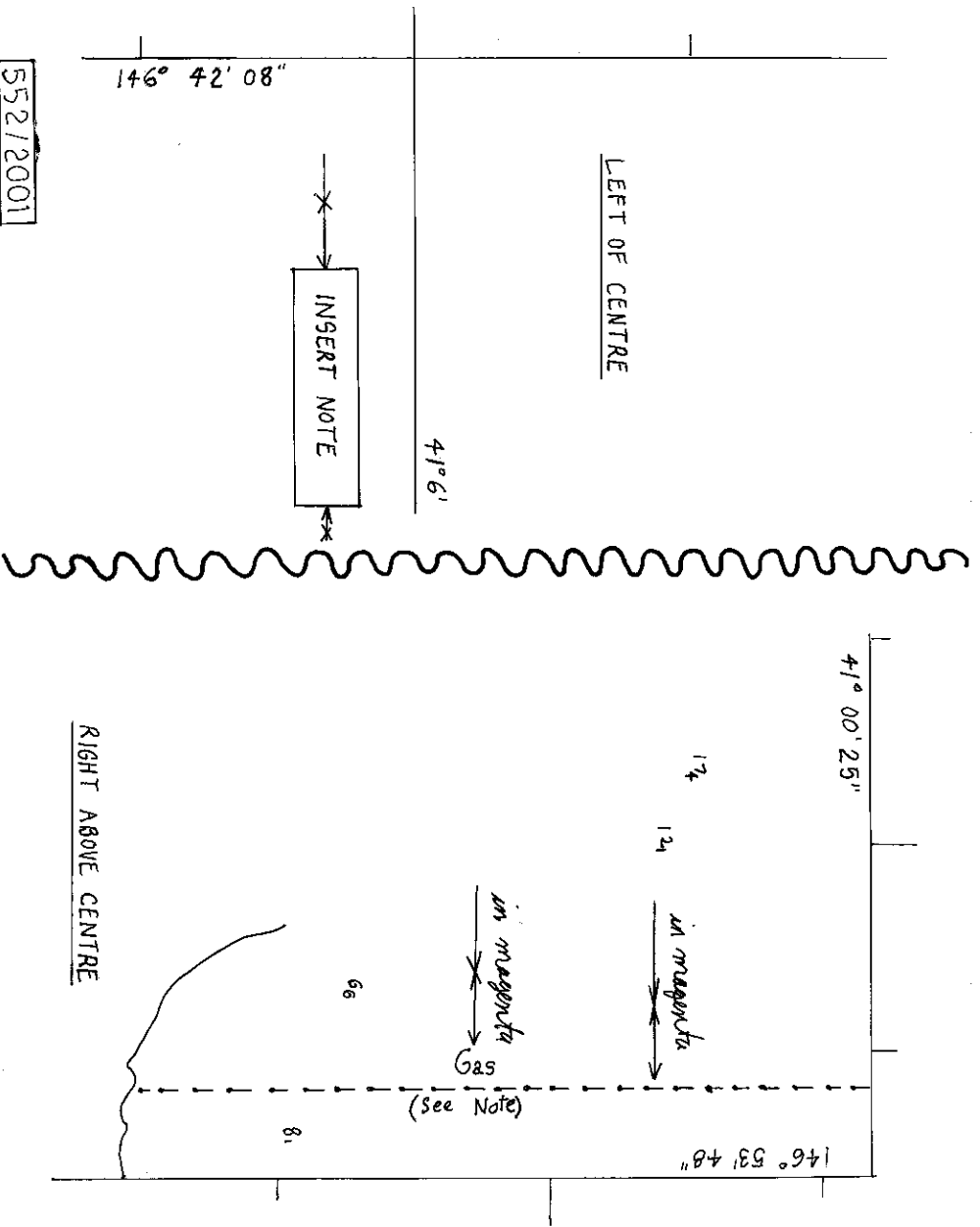

552/2001

401/2002

© Commonwealth of Australia 2002

AUS 167

F 6

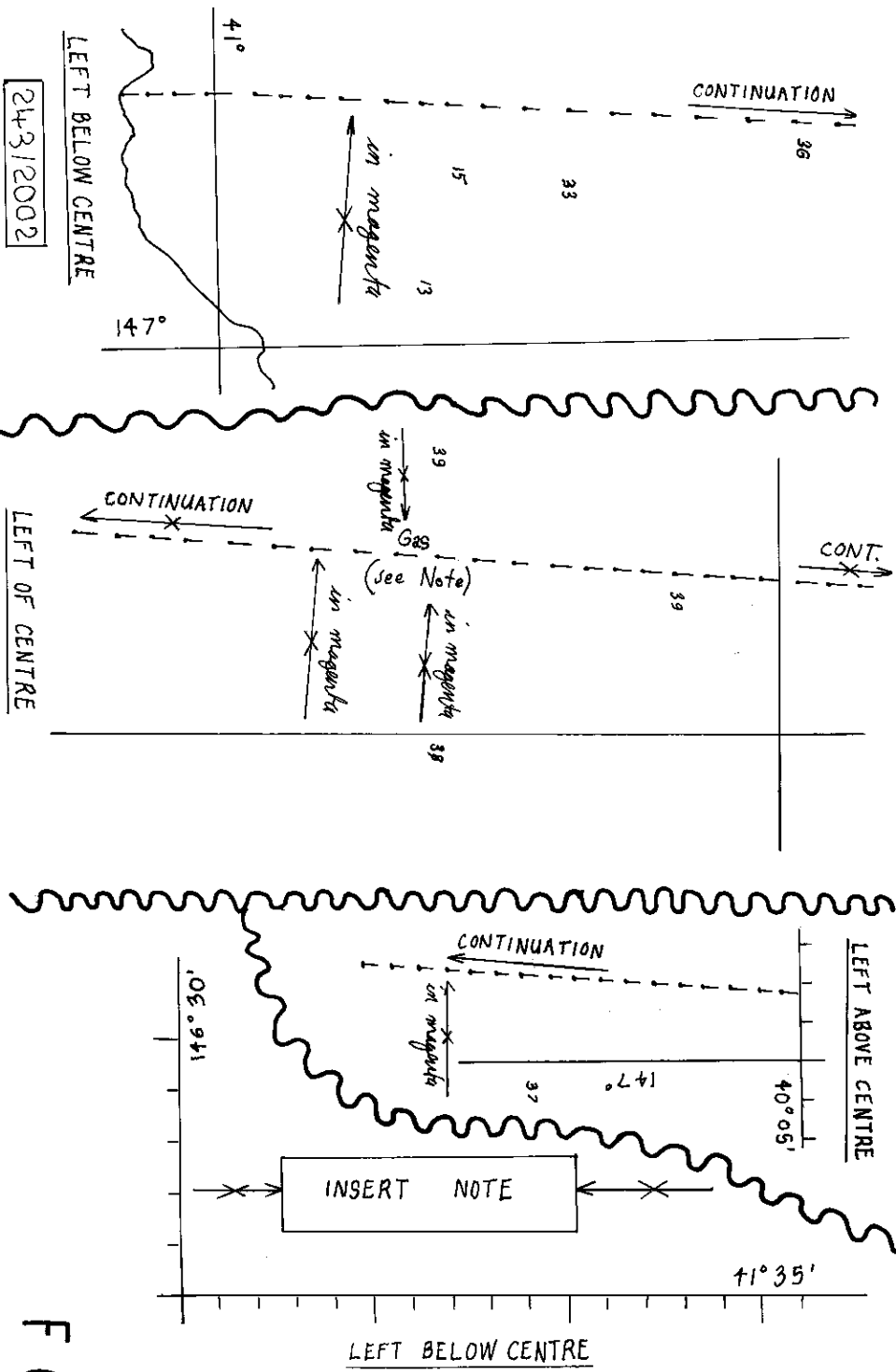

243/2002

401/2002

© Commonwealth of Australia 2002

AUS 356

F 6

50°05'1

57

77

18

69

52

RIGHT ABOVE CENTRE

38°

146°

ABOVE CENTRE

38°

40°

146°

CENTRE

40

42

40

48

in magnetic

in magnetic

Gas
(see Note)

CONTINUATION

30

CONTINUATION

in magnetic

34

in magnetic
Gas
(see Note)
in magnetic

12

13



243/2002

401, 402/2002

© Commonwealth of Australia 2002

AUS 422

F1

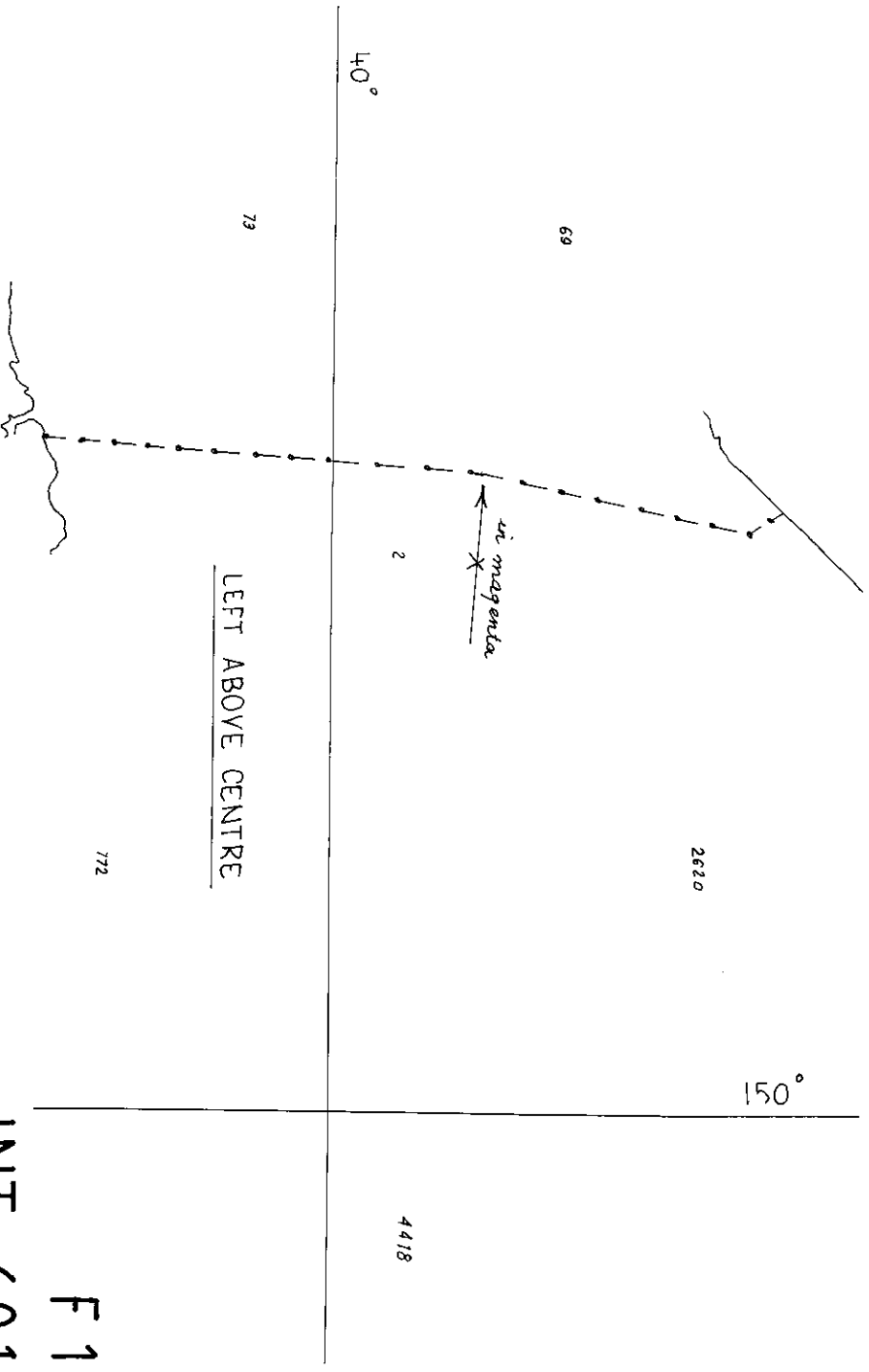

81/2002

401/2002

© Commonwealth of Australia 2002

AUS 4601

F 1
INT 601

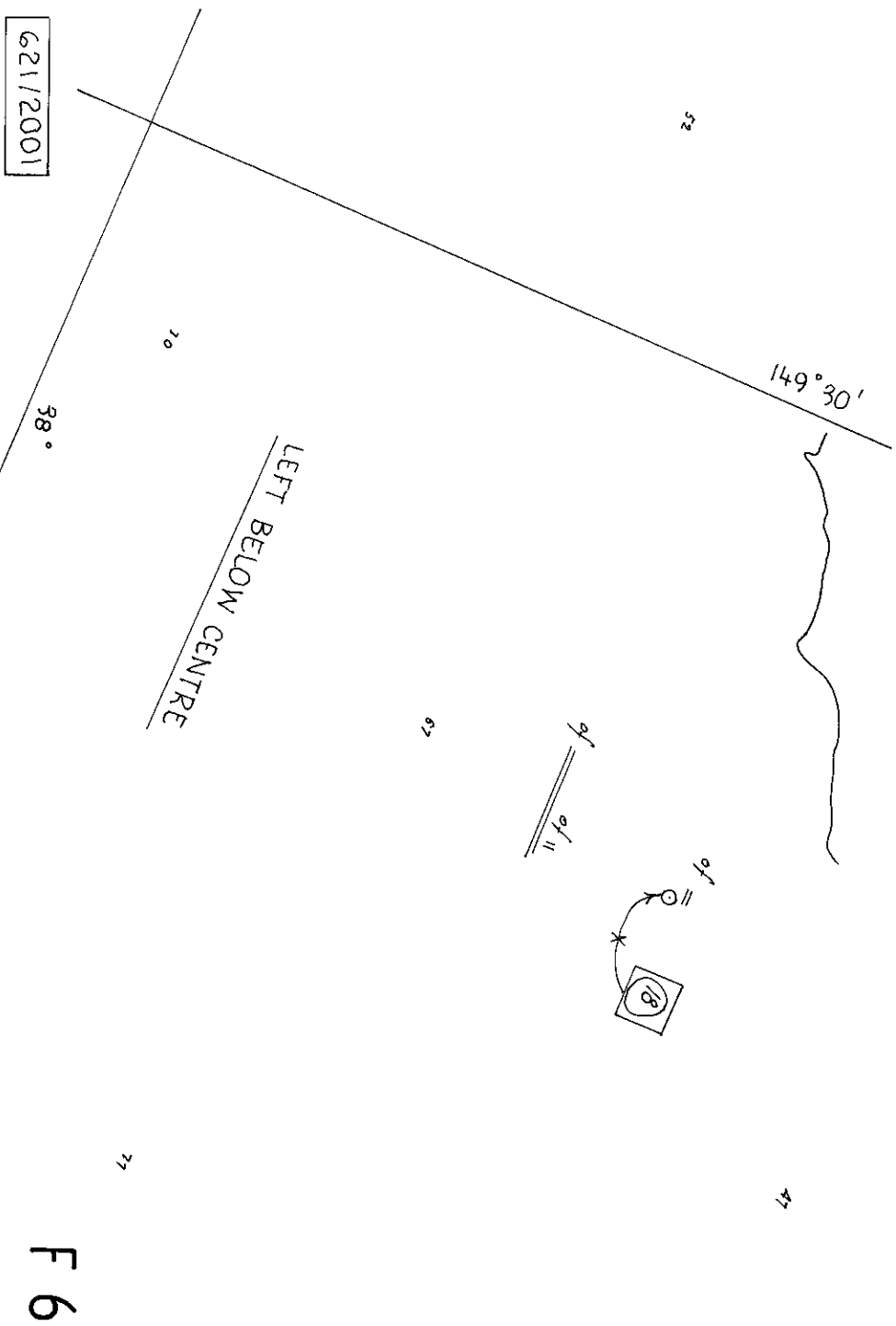

621/2001

402/2002

© Commonwealth of Australia 2002

AUS 359

F 6

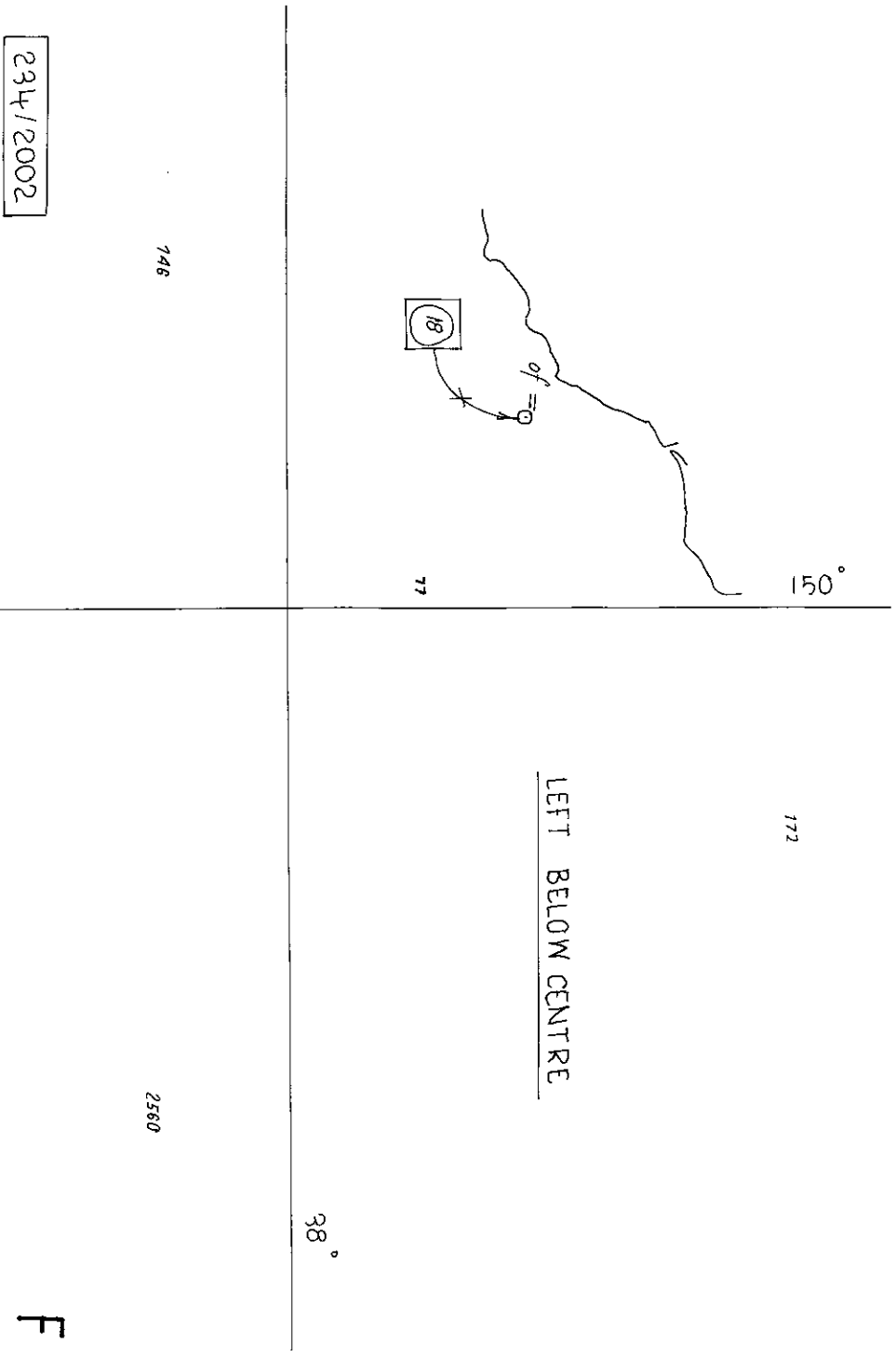

234/2002

402/2002

© Commonwealth of Australia 2002

AUS 423

F 1