

20°  
30'



117°25'E

18<sub>6</sub>

of

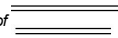

17<sub>6</sub>

2<sub>2</sub>

20°25'S

20°39'7"S

117°32'2"E

Previous Notice 143/2012

NTM 232/2012

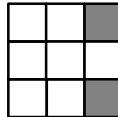

Australian Government  
Department of Defence

AUS 55

© Commonwealth of Australia 2012

24



28

13<sub>8</sub>

134°E

27

16



32°40'S

14<sub>6</sub>

32°45'S



INSERT  
BLOCK



134°05'E

49

46

PLAN: STREAKY BAY

Previous Notice 105/2012

NTM 236/2012

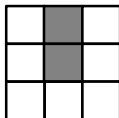

Australian Government  
Department of Defence

AUS 121

© Commonwealth of Australia 2012

0<sub>6</sub>

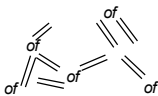

1<sub>9</sub>

147°59'E

37°53'S

**PLAN: LAKE ENTRANCE**

*Previous Notice 1315/2011*

**NTM 238/2012**

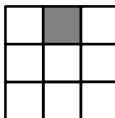

**AUS 182**

© Commonwealth of Australia 2012

150°11'E

35°43'S

2<sub>3</sub>

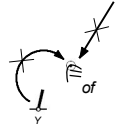

2<sub>4</sub>

**PLAN: BATEMANS BAY MARINA**

*Previous Notice 239/2011*

**NTM 221/2012**

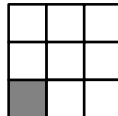

**AUS 191**

© Commonwealth of Australia 2012

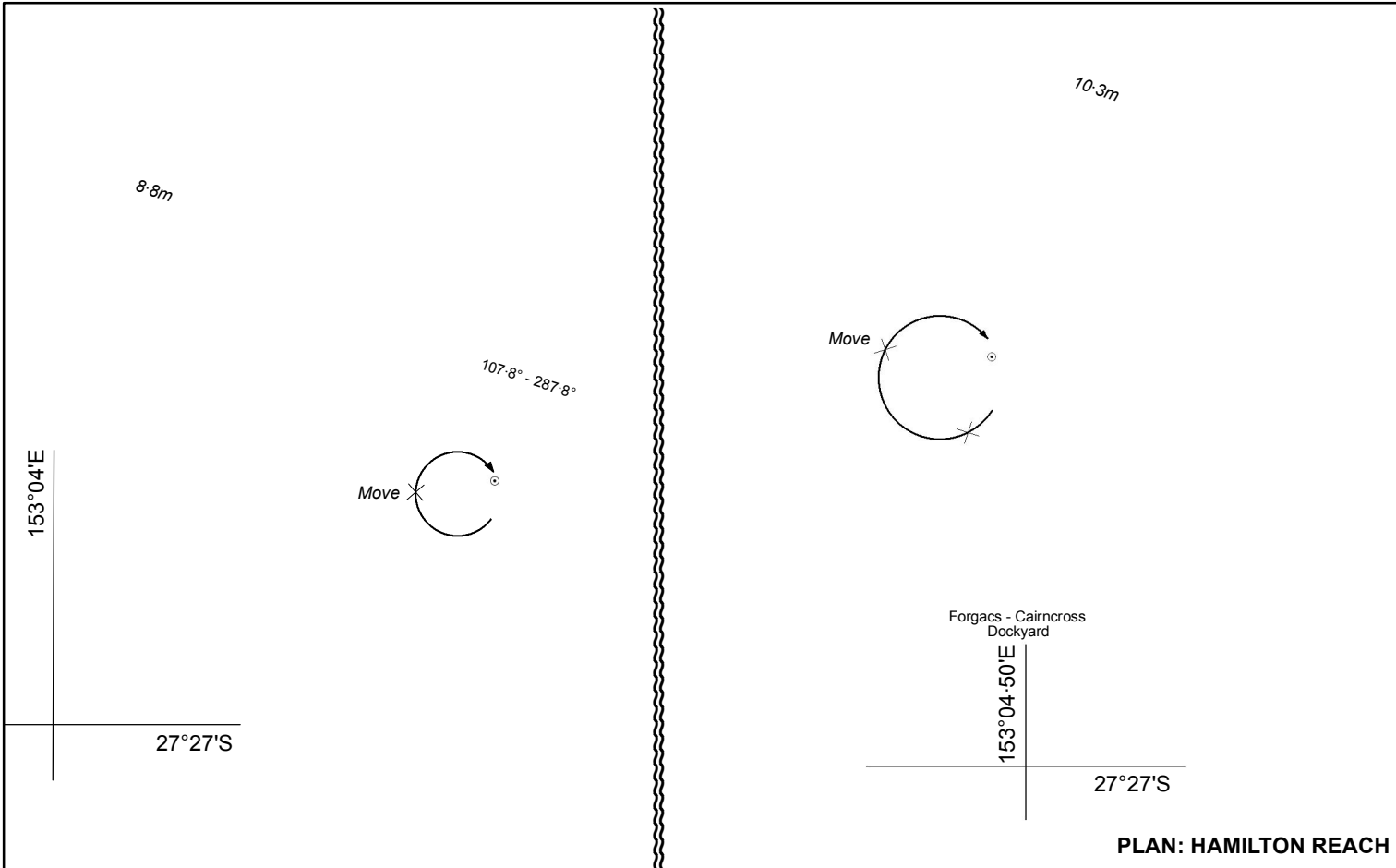

Previous Notice 1299/2011

NTM 222/2012

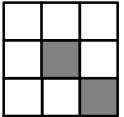

Australian Government  
Department of Defence

**PLAN: HAMILTON REACH**

AUS 238

© Commonwealth of Australia 2012

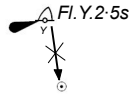

6<sub>4</sub>

5<sub>2</sub>

146° 50' E

19° 15' S

Previous Notice 186/2012

NTM 224/2012

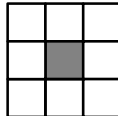

Australian Government  
Department of Defence

AUS 256

© Commonwealth of Australia 2012

145° 47'E

16° 55.5'S

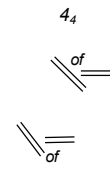

3<sub>1</sub>

4<sub>4</sub>

Previous Notice 135/2012

NTM 226/2012

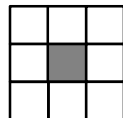

AUS 263

© Commonwealth of Australia 2012

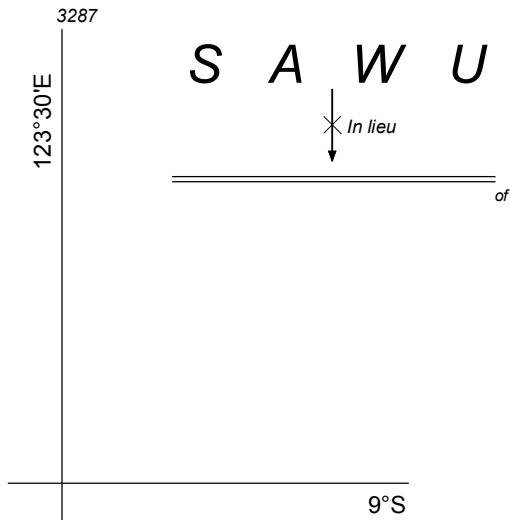

3292

Previous Notice 851/2011

NTM 230/2012

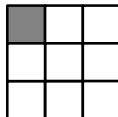

AUS 321

© Commonwealth of Australia 2012

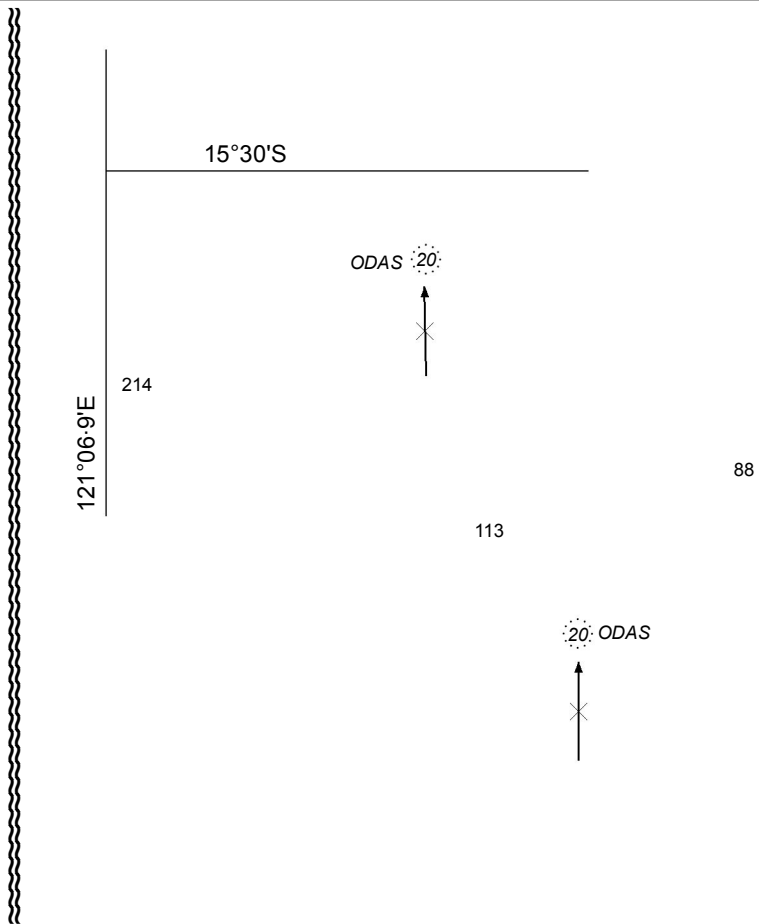
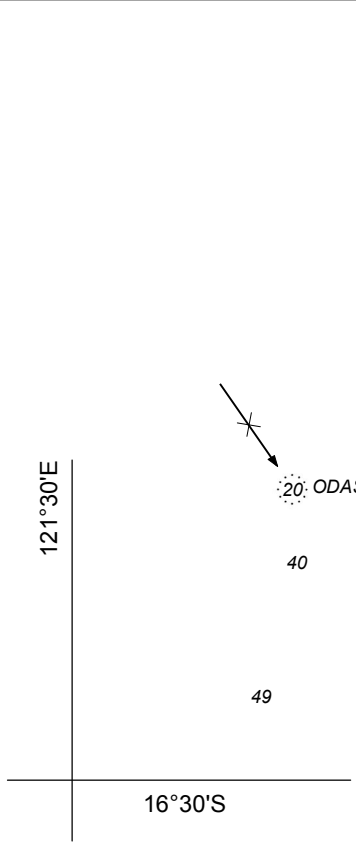

Previous Notice 142/2012

NTM 231/2012

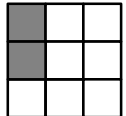

Australian Government  
Department of Defence

AUS 323

© Commonwealth of Australia 2012

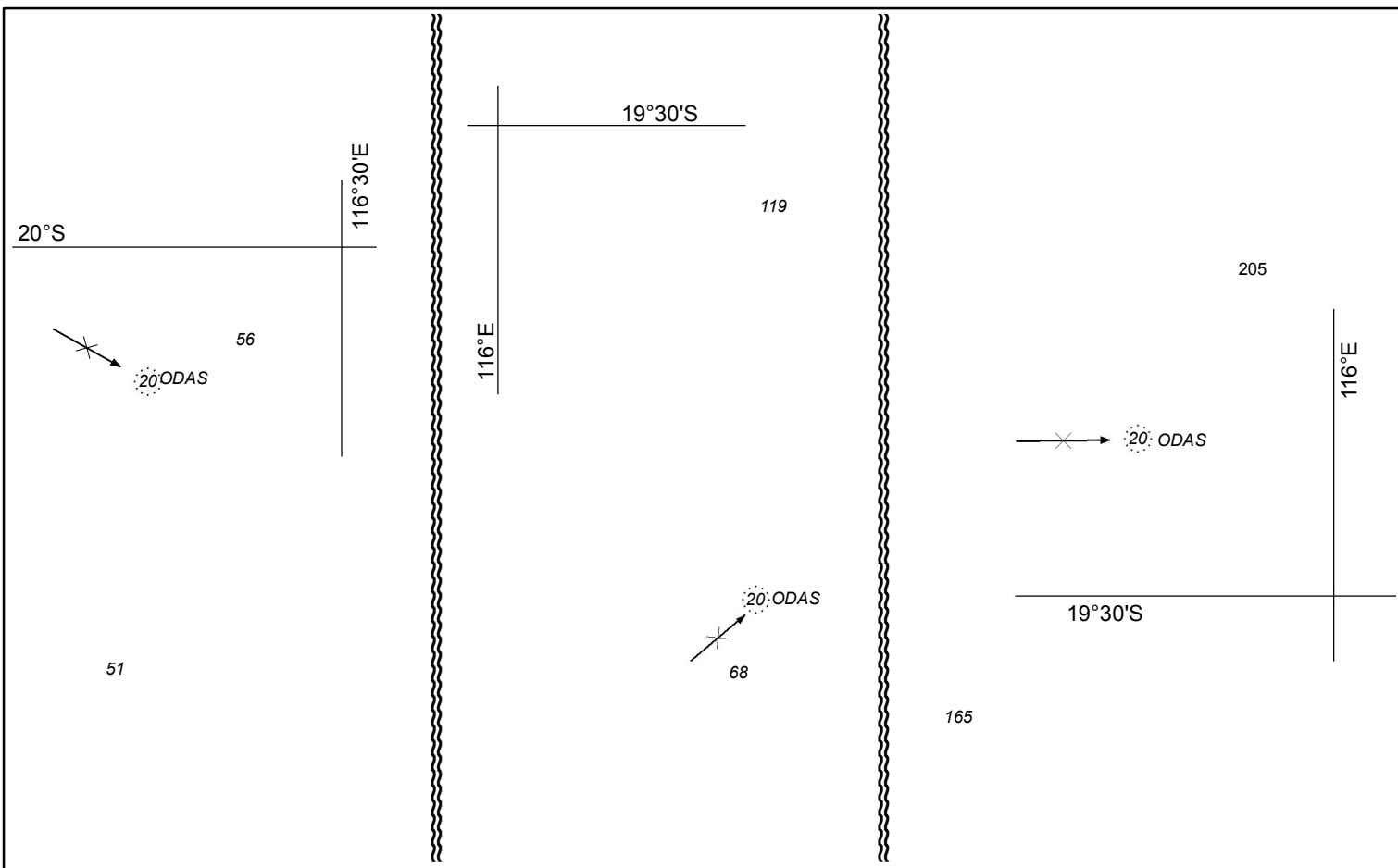

Previous Notice 191/2012

NTM 233/2012

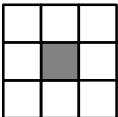

AUS 327

© Commonwealth of Australia 2012

12



22

37°30'S

140°E

Previous Notice 1117/2010

NTM 237/2012

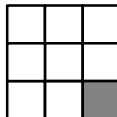

AUS 347

© Commonwealth of Australia 2012

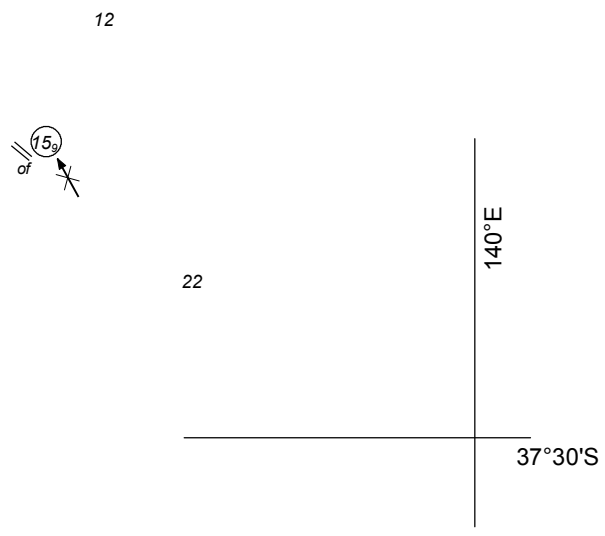
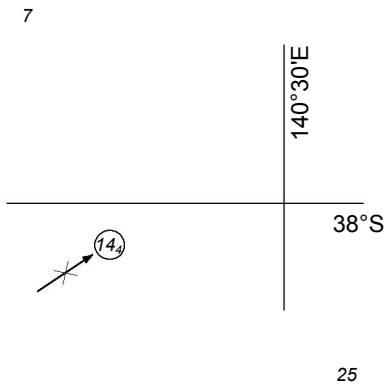

Previous Notice 106/2012

NTM 237/2012

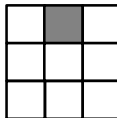

AUS 348

© Commonwealth of Australia 2012

10°S

141°30'E

10<sub>6</sub>

INSERT  
BLOCK

12<sub>8</sub>

Previous Notice 138/2012

NTM 229/2012

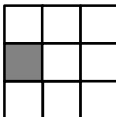

AUS 376

© Commonwealth of Australia 2012

4°30'S

153°E

439

Rep (2012)   
225

Previous Notice 895/2011

NTM 227/2012

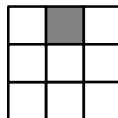

AUS 397

© Commonwealth of Australia 2012

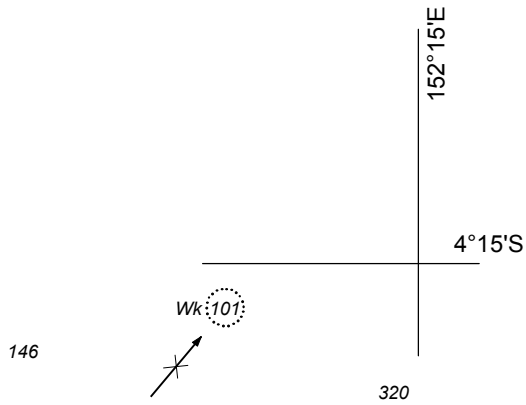

Previous Notice 96/2012

NTM 228/2012

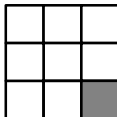

Australian Government  
Department of Defence

AUS 545

© Commonwealth of Australia 2012

305

10, Rep (2012)



4°45'S

152°45'E

150

152°15'E

4°15'S

Wk 101



83

77

Previous Notice 96/2012

NTM 227 & 228/2012

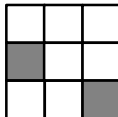

AUS 554

© Commonwealth of Australia 2012

94

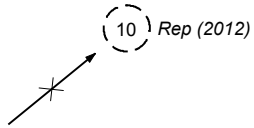

153

152°45'E

4°45'S

**PLAN: SPERBER POINT TO CAPE ST GEORGE**

*Previous Notice NC 24/9/2010*

**NTM 227/2012**

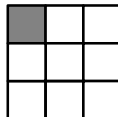

**AUS 668**

© Commonwealth of Australia 2012

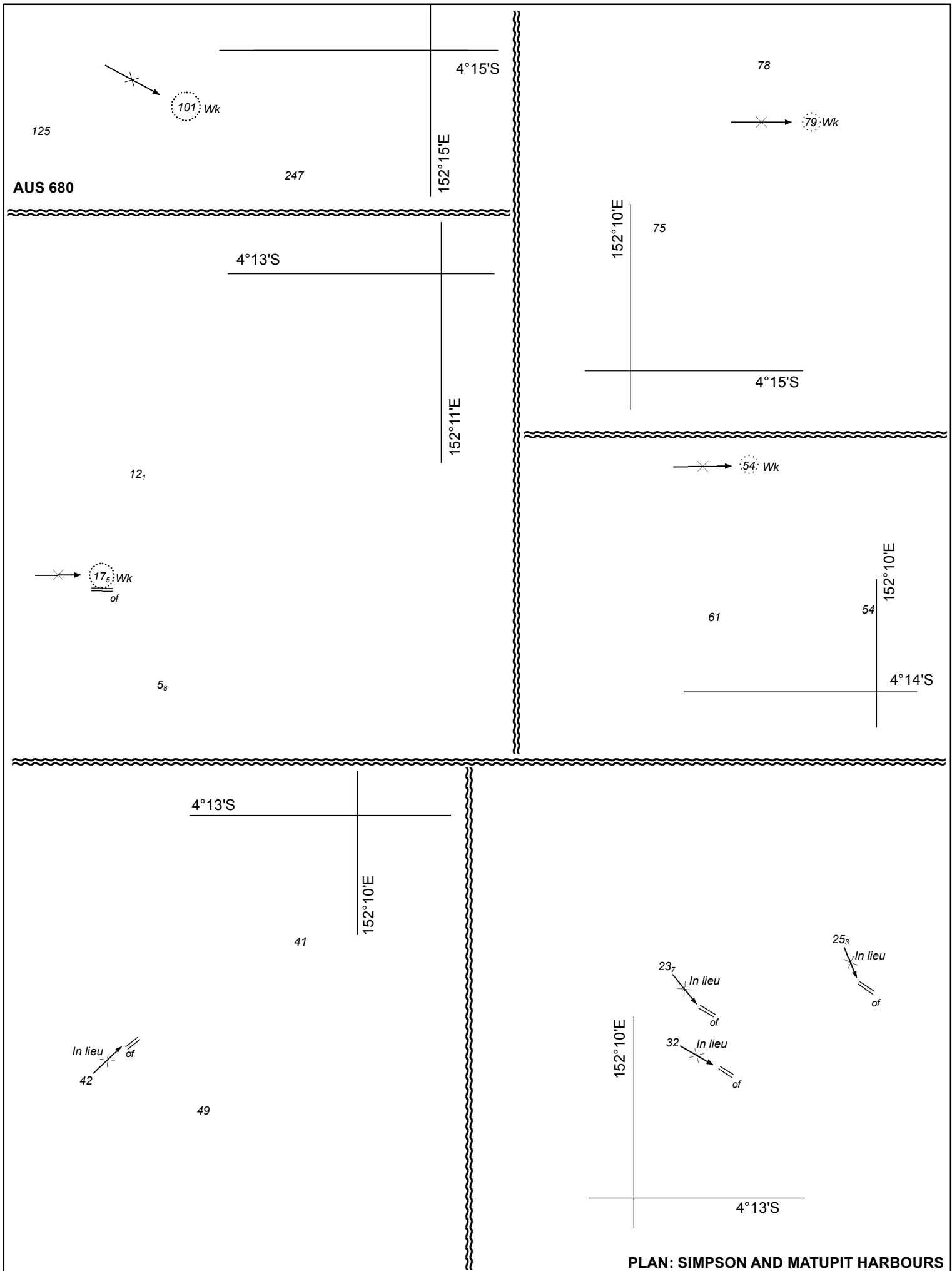

**PLAN: SIMPSON AND MATUPIT HARBOURS**

Previous Notice 96/2012

NTM 228/2012



Australian Government  
Department of Defence

AUS 680

© Commonwealth of Australia 2012

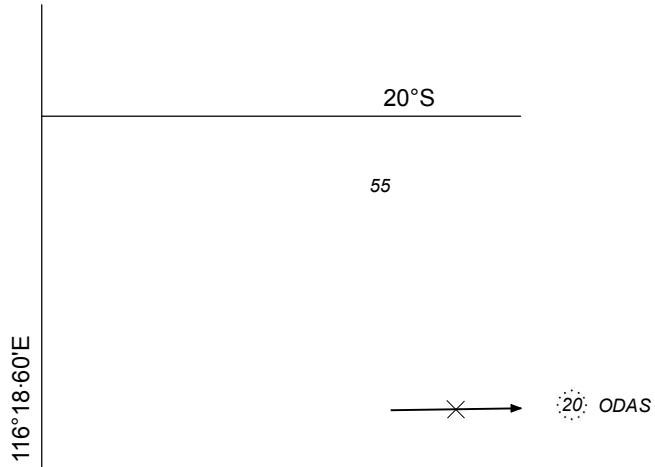

Previous Notice 191/2012

NTM 233/2012

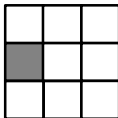

AUS 741

© Commonwealth of Australia 2012

16<sub>s</sub>

11<sub>s</sub>

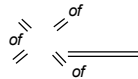

153° 15'E

24° 45'S

Previous Notice 1300/2011

NTM 223/2012

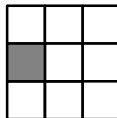

Australian Government  
Department of Defence

AUS 816

© Commonwealth of Australia 2012

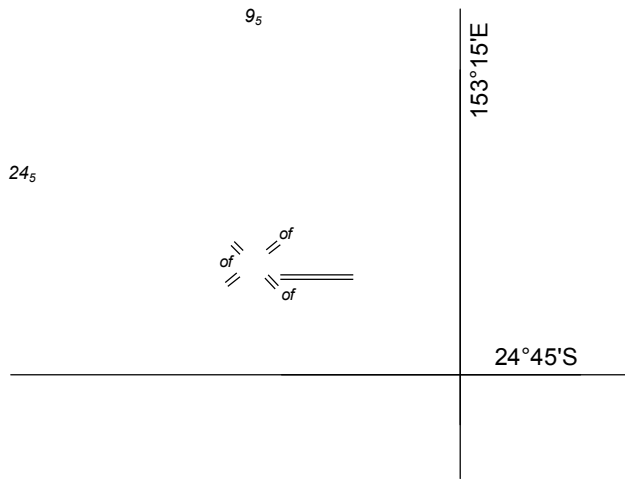

*Previous Notice 632/2011*

NTM 223/2012

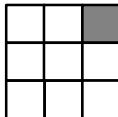

Australian Government  
Department of Defence

AUS 817

© Commonwealth of Australia 2012

146°15.1E

18°34.2'S

Fl.4.3s  
of  
In lieu of  
4.3s

13

12<sub>4</sub>

Previous Notice 185/2012

NTM 225/2012

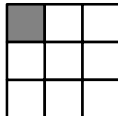

AUS 827

© Commonwealth of Australia 2012

18°30'S

146°30'E

11

of  
4-3s  
In lieu  
Fl.4-3s  
of

12<sub>s</sub>

Previous Notice 1240/2011

NTM 225/2012

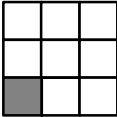

Australian Government  
Department of Defence

AUS 828

© Commonwealth of Australia 2012

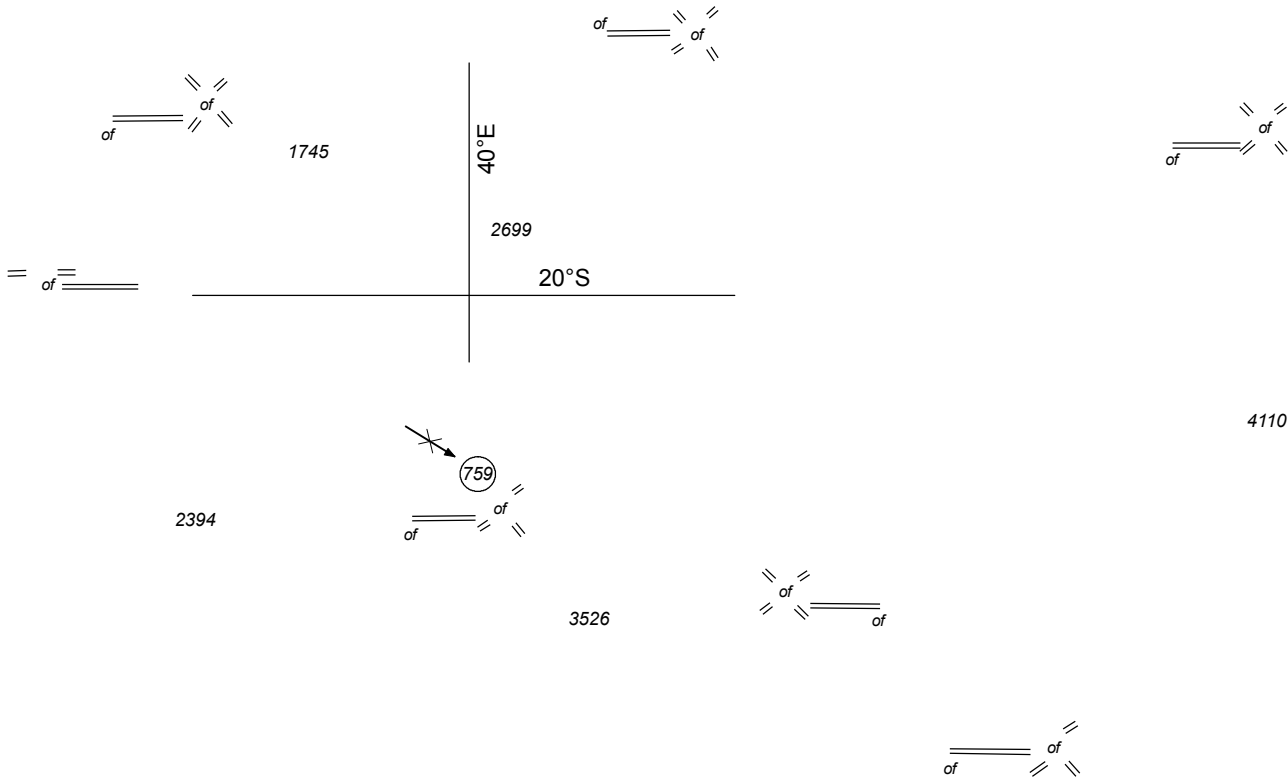

Previous Notice 1192/2011

NTM 235/2012

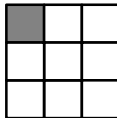

Australian Government  
Department of Defence

AUS 4070 (INT 70)

© Commonwealth of Australia 2012

of

6

of

of

1918

2216

521

of

10°N

50°E

of of

of of

1745

40°E

2699

of of

of

20°S

4110

2394

759 of of

3526

of of

Previous Notice 1127/2011

NTM 234 & 235/2012

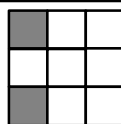

AUS 4071 (INT 71)

© Commonwealth of Australia 2012

SAWU



=====  
of

3305

3164

124°E

10°S

Previous Notice 139/2012

NTM 230/2012

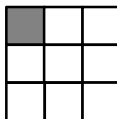

Australian Government  
Department of Defence

AUS 4721 (INT 721)

© Commonwealth of Australia 2012

ODAS :20: ← ×

→ × :20: ODAS

402

ODAS :20: //  
↑ of  
×

43

122°E

16°S

46

ODAS :20:  
↑  
×

Previous Notice 1009/2011

NTM 231/2012

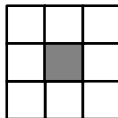

Australian Government  
Department of Defence

AUS 4722 (INT 722)

© Commonwealth of Australia 2012

↓  
ODAS 20°

265

56

20°S

40

116°E

*Previous Notice 1011/2011*

NTM 233/2012

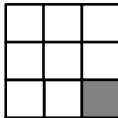

Australian Government  
Department of Defence

AUS 4723 (INT 723)

© Commonwealth of Australia 2012